

MAP

LOT

ACCOUNT NO. 4057

ADDRESS

TOWN OF WATERBORO, MAINE

CARD NO.

OF

051-002

RICHARDS MICHAEL D & LAUREL S  
10 MOUNTAIN VIEW RD  
B 11827 P 106

PROPERTY DATA

NEIGHBORHOOD CODE 20

STREET CODE

LAND USE

- 11. Residential
- 21. Village
- 22. Village/Res.
- 31. Agricultural/Res.
- 33. Forest/Agri.
- 40. Conservation
- 45. General Purpose
- 48. Shoreland
- 49. Resource Protection

31

SECONDARY ZONE

TOPOGRAPHY

- 1. Level
- 2. Rolling
- 3. Above St.
- 4. Below St.
- 5. Low
- 6. Swampy
- 7. Steep
- 8.

12

UTILITIES

- 1. All Public
- 2. Public Water
- 3. Public Sewer
- 4. Drilled Well
- 5. Dug Well
- 6. Septic
- 7. Cess Pool
- 9. No Utilities

9

STREET

- 1. Paved
- 2. Semi-Improved
- 3. Gravel
- 4. Proposed
- 9. No Street

1

SALE DATA

DATE(MM/YY)

PRICE

SALE TYPE

- 1. Land
- 2. Land & Bldg.
- 3. Building Only
- 4. Mobile Home
- 5. Other

FINANCING

- 1. Conv.
- 2. FHA/VA
- 3. Assumed
- 4. Seller
- 5. Private
- 6. Cash
- 7. FMHA
- 9. Unknown

VERIFIED

- 1. Buyer
- 2. Seller
- 3. Lender
- 4. Agent
- 5. Record
- 6. MLS
- 7. Family
- 8. Other
- 9. Confid.

VALIDITY

- 1. Valid
- 2. Related
- 3. Distress
- 4. Split
- 5. Partial
- 6. Exempt
- 7. Changed
- 8. Other

BOOK

PAGE

DATE

CONSIDERATION

ASSESSMENT RECORD

YEAR	LAND	BUILDINGS	EXEMPT	TOTAL
02	22,500	50,900		66,400

LAND DATA

	TYPE	EFFECTIVE		INFLUENCE		INFLUENCE CODES
		Frontage	Depth	Factor	Code	
<b>FRONT FOOT</b>				%		1=Vacancy 2=Excess Frontage 3=Topography 4=Size/Shape 5=Access 6=Restrictions 7=Corner 8=Environment 9=Fractional Share
11. Regular Lot				%		
12. Delta Triangle				%		
13. Nabla Triangle				%		
14. Rear Land				%		
15.				%		
<b>SQUARE FOOT</b>		SQUARE FEET				<b>ACRES (cont.)</b> 34. Softwood (F&O) 35. Mixed Wood (F&O) 36. Hardwood (F&O) 37. Softwood (T.G.) 38. Mixed Wood (T.G.) 39. Hardwood (T.G.) 40. Waste 41. Gravel Pit
16. Regular Lot				%		
17. Secondary				%		
18. Excess Land				%		
19. Condo.				%		
20.				%		
<b>FRACT. ACRE</b>		ACREAGE/SITES				<b>SITE</b> 42. Moho Site 43. Condo Site 44. Lot Improvements
21. Homesite				%		
22. Baselot				%		
23.				%		
<b>ACRES</b>				%		
24. Homesite				%		
25. Baselot				%		
26. Secondary				%		
27. Frontage				%		
28. Rear 1				%		
29. Rear 2				%		
30. Rear 3				%		
31. Tillable				%		
32. Pasture				%		
33. Orchard				%		
Total				5		

No./Date	Description	Date Insp.

NOTES:

MAP 51 LOT 2

ACCOUNT NO.

BUILDING RECORD

ADDRESS

CARD NO. OF

<b>BUILDING STYLE</b> 1. Conv. 6. Split Lev. 2. Ranch 7. Contemp. 3. R. Ranch 8. Log 4. Cape 9. Other 5. Garrison	4	<b>S/F BSMT LIVING</b> FIN BSMT GRADE	0	<b>INSULATION</b> 1. Full 4. Minimal 2. Heavy 9. None 3. Capped	1
<b>DWELLING UNITS</b>		<b>HEAT TYPE</b> 1. HW BB 6. Grav. WA 2. HW CI 7. Electric 3. HW Radiant 8. Units 4. Steam 9. No Heat 5. FWA	1	<b>UNFINISHED %</b>	%
<b>OTHER UNITS</b>		<b>COOL TYPE</b> 1. Central 9. None	9	<b>GRADE &amp; FACTOR</b> 1. E 4. B 2. D 5. A 3. C 6. AA	3
<b>STORIES</b> 1. One 4. 1 1/2 2. Two 5. 1 3/4 3. Three 6. 2 1/2	1	<b>KITCHEN STYLE</b> 1. Good 3. Old Style 2. Typical 4. Obsolete	2	<b>SQ. FOOTAGE</b>	744
<b>EXTERIOR WALLS</b> 1. Clapboard 6. BR./Stone 2. WD.SH. 7. Novelty 3. Comp. 8. AL/Vinyl 4. ASB/ASP 9. Other 5. T1-11	1	<b>BATH(S) STYLE</b> 1. Good 3. Old Style 2. Typical 4. Obsolete	2	<b>CONDITION</b> 1. Poor 5. Avg + 2. Fair 6. Good 3. Avg - 7. V Good 4. Avg. 8. Exc.	4
<b>ROOF SURFACE</b> 1. Asphalt 4. Comp. 2. Slate 5. Wood 3. Metal 6. Other	1	<b># ROOMS</b>	9	<b>PHYS. % GOOD</b>	%
<b>S/F MASONRY TRIM</b>		<b># BEDROOMS</b>	3	<b>FUNCT. % GOOD</b>	%
<b>YEAR BUILT</b>	1982	<b># FULL BATHS</b>	1	<b>FUNCT. CODE</b> 1. Incomp. 5. CDU 2. Overbull 6. Style 3. Delap. 7. Layout 4. Small Size 8. Other 9. None	9
<b>YEAR REMODELED</b>		<b># HALF BATHS</b>		<b>ECON. % GOOD</b>	%
<b>FOUNDATION</b> 1. Conc. 4. Wood 2. C Blk 5. Slab 3. Br./Stone 6. Piers	1	<b># ADDN FIXTURES</b>		<b>ECON. CODE</b> 1. Location 3. Services 2. Encroach 9. None	9
<b>BASEMENT</b> 1. 1/4 3. 3/4 5. Crawl 2. 1/2 4. Full 6. None	4	<b># FIREPLACES</b>		<b>ENTRANCE CODE</b> 1. Inspt. 3. Vacant 2. Refused 5. Estim. 3. Info Only	5
<b>BSMT GAR # CARS</b>	0	<b># HEARTHES</b>		<b>INFO. CODE</b> 1. Owner 4. Agent 2. Relative 5. Estimate 3. Tenant 6. Other 2. Refused 5. Estim.	5
<b>WET BASEMENT</b> 1. Dry 3. Wet 2. Damp 9. None	1	<b>INSPECTED BY</b>	PAK		
		<b>DATE INSPECTED</b>	9-30-05		

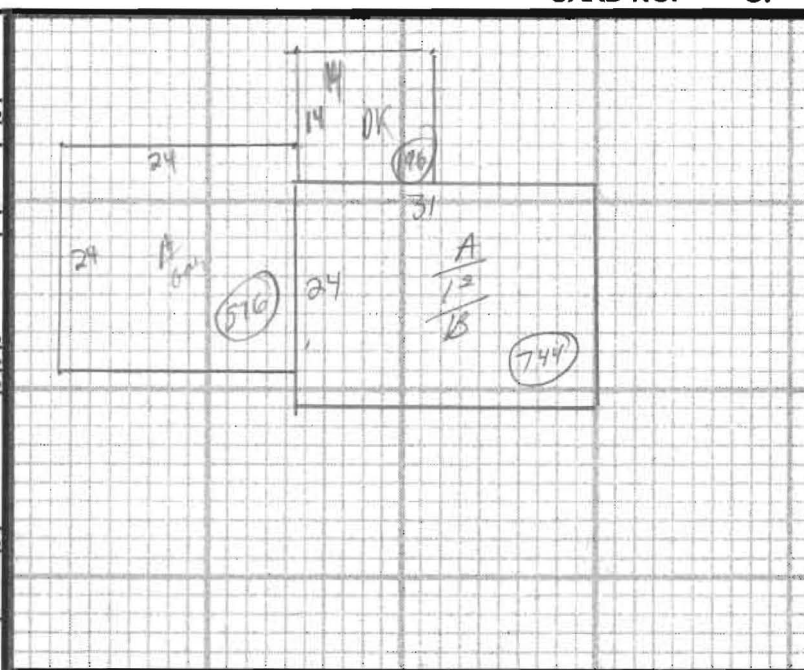

ADDITIONS, OUTBUILDINGS & IMPROVEMENTS						PERCENT GOOD		CODES
TYPE	YEAR	UNITS	GRADE	COND	Phys.	Funct.		
1 <sup>st</sup>	1982	0744	---	---	---	---	1. 1S Fr.	
Abs		0576	---	---	---	---	2. 2S Fr.	
DK		0196	---	---	---	---	3. 3S Fr.	
							4. 1 1/2S Fr.	
							5. 1 3/4S Fr.	
							6. 2 1/2S Fr.	
							Add 10 for Bsmt	
							21. OFP	
							22. EFP	
							23. Garage	
							24. Shed	
							25. Bay Window	
							26. Overhang	
							27. Unf. Bsmt	
							28. Unf. Attic	
							29. Fin. Attic	
							Add 20 for 2 Story	
							61. Carport	
							62. Patio	
							63. Swimming Pool	
							64. Tennis Court	
							65. Stable w/loft	
							66. Greenhouse	
							67. Natatorium	
							68. Wood Deck	
							69. Jacuzzi	

PHOTO

NOTES: