

MAP LOT

ACCOUNT NO. *3463* ADDRESS

TOWN OF WATERBORO, MAINE

CARD NO. OF

046-002-110

RICE JEFFREY S &

21 PINECREST CIRCLE

046-002-110

HOWARD ROGER W

21 PINECREST CIRCLE

02/11/2005 \$130,000

PROPERTY DATA	
NEIGHBORHOOD CODE	___
STREET CODE	___
LAND USE	___
11. Residential 21. Village 22. Village/Res. 31. Agricultural/Res. 33. Forest/Agri. 40. Conservation 45. General Purpose 48. Shoreland 49. Resource Protection	
SECONDARY ZONE	___
TOPOGRAPHY	___
1. Level 5. Low 2. Rolling 6. Swampy 3. Above St. 7. Steep 4. Below St. 8.	
UTILITIES	___
1. All Public 5. Dug Well 2. Public Water 6. Septic 3. Public Sewer 7. Cess Pool 4. Drilled Well 9. No Utilities	
STREET	<i>3</i>
1. Paved 4. Proposed 2. Semi-Improved 3. Gravel 9. No Street	
SALE DATA	
DATE(MMYY)	___/___/___
PRICE	___
SALE TYPE	___
1. Land 4. Mobile 2. Land & Bldg. Home 3. Building Only 5. Other	
FINANCING	___
1. Conv. 5. Private 2. FHA/VA 6. Cash 3. Assumed 7. FMHA 4. Seller 9. Unknown	
VERIFIED	___
1. Buyer 6. MLS 2. Seller 7. Family 3. Lender 8. Other 4. Agent 9. Confid. 5. Record	
VALIDITY	___
1. Valid 5. Partial 2. Related 6. Exempt 3. Distress 7. Changed 4. Split 8. Other	

BOOK	PAGE	DATE	CONSIDERATION

ASSESSMENT RECORD				
YEAR	LAND	BUILDINGS	EXEMPT	TOTAL

LAND DATA						
FRONT FOOT	TYPE	EFFECTIVE		INFLUENCE		INFLUENCE CODES
		Frontage	Depth	Factor	Code	
11. Regular Lot				%		1=Vacancy
12. Delta Triangle				%		2=Excess Frontage
13. Nabla Triangle				%		3=Topography
14. Rear Land				%		4=Size/Shape
15.				%		5=Access
				%		6=Restrictions
				%		7=Corner
				%		8=Environment
				%		9=Fractional Share
SQUARE FOOT		SQUARE FEET				ACRES (cont.)
16. Regular Lot						
17. Secondary				%		35. Mixed Wood (F&O)
18. Excess Land				%		36. Hardwood (F&O)
19. Condo.				%		37. Softwood (T.G.)
20.				%		38. Mixed Wood (T.G.)
FRACT. ACRE		ACREAGE/SITES				SITE
21. Homesite						
22. Baselot			%			43. Condo Site
23.			%			44. Lot Improvements
24. Homesite			%			
25. Baselot			%			
26. Secondary			%			
27. Frontage			%			
28. Rear 1			%			
29. Rear 2			%			
30. Rear 3			%			
31. Tillable			%			
32. Pasture			%			
33. Orchard			%			
Total			%			

No./Date	Description	Date Insp.

NOTES:

TT

BUILDING RECORD

MAP LOT ACCOUNT NO. ADDRESS CARD NO. OF

<b>BUILDING STYLE</b> 1. Conv. 6. Split Lev. 2. Ranch 7. Contemp. 3. R. Ranch 8. Log 4. Cape 9. Other 5. Garrison	4	<b>S/F BSMT LIVING</b> <b>FIN BSMT GRADE</b>		<b>INSULATION</b> 1. Full 4. Minimal 2. Heavy 9. None 3. Capped	1
<b>DWELLING UNITS</b>	1	<b>HEAT TYPE</b> 1. HW BB 6. Grav. WA 2. HW CI 7. Electric 3. HW Radiant 8. Units 4. Steam 9. No Heat 5. FWA	100 %	<b>UNFINISHED %</b>	%
<b>OTHER UNITS</b>		<b>COOL TYPE</b> 1. Central 9. None	9 %	<b>GRADE &amp; FACTOR</b> 1. E 4. B 2. D 5. A 3. C 6. AA	3
<b>STORIES</b> 1. One 4. 1 1/2 2. Two 5. 1 3/4 3. Three 6. 2 1/2	4	<b>KITCHEN STYLE</b> 1. Good 3. Old Style 2. Typical 4. Obsolete	1	<b>SQ. FOOTAGE</b>	
<b>EXTERIOR WALLS</b> 1. Clapboard 6. BR./Stone 2. WD.SH. 7. Novelty 3. Comp. 8. AL/Minyl 4. ASB/ASP 9. Other 5. T1-11	1	<b>BATH(S) STYLE</b> 1. Good 3. Old Style 2. Typical 4. Obsolete	2	<b>CONDITION</b> 1. Poor 5. Avg + 2. Fair 6. Good 3. Avg - 7. V Good 4. Avg. 8. Exc.	4
<b>ROOF SURFACE</b> 1. Asphalt 4. Comp. 2. Slate 5. Wood 3. Metal 6. Other	1	<b># ROOMS</b>	6	<b>PHYS. % GOOD</b>	100 %
<b>S/F MASONRY TRIM</b>	1	<b># BEDROOMS</b>	3	<b>FUNCT. % GOOD</b>	100 %
<b>YEAR BUILT</b>	1991	<b># FULL BATHS</b>	2	<b>FUNCT. CODE</b> 1. Incomp. 5. CDU 2. Overbuilt 6. Style 3. Delap. 7. Layout 4. Small Size 8. Other 9. None	9
<b>YEAR REMODELED</b>		<b># HALF BATHS</b>		<b>ECON. % GOOD</b>	100 %
<b>FOUNDATION</b> 1. Conc. 4. Wood 2. C Blk 5. Stab 3. Br./Stone 6. Piers	1	<b># ADDN FIXTURES</b>		<b>ECON. CODE</b> 1. Location 3. Services 2. Encroach 9. None	
<b>BASEMENT</b> 1. 1/4 3. 3/4 5. Crawl 2. 1/2 4. Full 6. None	4	<b># FIREPLACES</b>		<b>ENTRANCE CODE</b> 1. Inspct. 3. Vacant 2. Refused 5. Estim. 3. Info Only	3
<b>BSMT GAR # CARS</b>		<b>LAYOUT</b> 1. Typical 2. In adeq.	1	<b>INFO. CODE</b> 1. Owner 4. Agent 2. Relative 5. Estimate 3. Tenant 6. Other 2. Refused 5. Estim.	1
<b>WET BASEMENT</b> 1. Dry 3. Wet 2. Darrp 9. None	1	<b>ATTIC</b> 1. 1/4 Fin 4. Full Fin. 2. 1/2 Fin. 5. FV/Stairs 3. 3/4 Fin. 9. None	9		
		<b>INT COMP TO EXIT + - -</b>			
		<b>INSPECTED BY</b>	KSH		
		<b>DATE INSPECTED</b>	7/21/05		

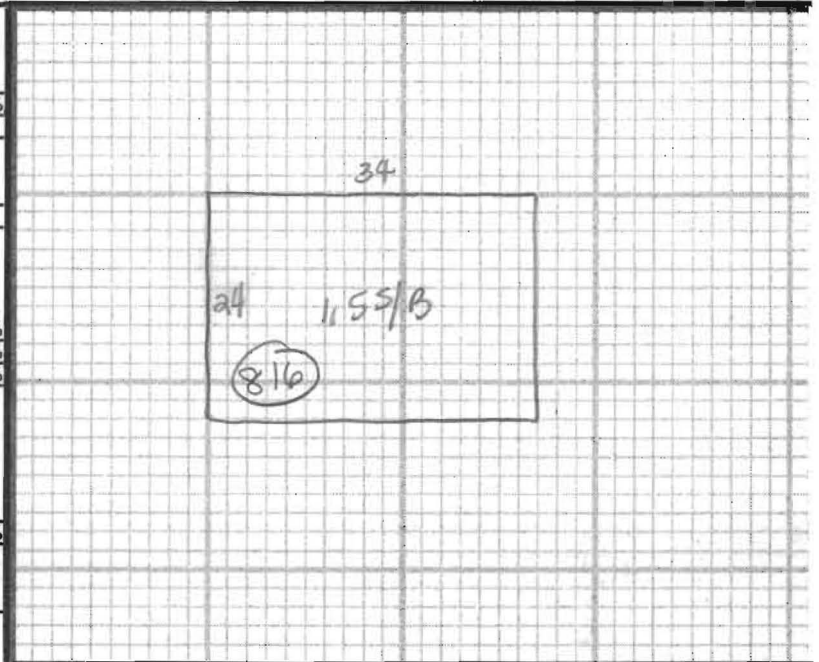

ADDITIONS, OUTBUILDINGS & IMPROVEMENTS						PERCENT GOOD		CODES
TYPE	YEAR	UNITS	GRADE	COND	Phys.	Funct.		
1,551/B		816						1. 1S Fr.
SHED	24	232	2	3	85%			2. 2S Fr.
								3. 3S Fr.
								4. 1 1/2S Fr.
								5. 1 3/4S Fr.
								6. 2 1/2S Fr.
								Add 10 for Bsmt
								21. OFP
								22. EFP
								23. Garage
								24. Shed
								25. Bay Window
								26. Overhang
								27. Unf. Bsmt
								28. Unf. Attic
								29. Fin. Attic
								Add 20 for 2 Story
								61. Carport
								62. Patio
								63. Swimming Pool
								64. Tennis Court
								65. Stable w/loft
								66. Greenhouse
								67. Natatorium
								68. Wood Deck
								69. Jacuzzi

PHOTO

NOTES: Kitchen ceramic tile floor / Shed has no door  
Bath