

BUILDING RECORD

MAP 45 LOT 1757 ACCOUNT NO. 3519 ADDRESS _____ CARD NO. ____ OF ____

C1

| | | | | | |
|--|------|---|-----------------|--|-------|
| BUILDING STYLE 1. Conv. 8. Split Lev. 2. Ranch 7. Contemp. 3. R. Ranch 8. Log 4. Cape 9. Other 5. Garrison | 1 | S/F BSMT LIVING FIN BSMT GRADE | | INSULATION 1. Full 4. Minimal 2. Heavy 9. None 3. Capped | 1 |
| DWELLING UNITS | | HEAT TYPE 1. HW BB 6. Grav. WA 2. HW Cl 7. Electric 3. HW Radiant 8. Units 4. Steam 9. No Heat 5. FWA | 1 | UNFINISHED % | 100 % |
| OTHER UNITS | | COOL TYPE 1. Central 9. None | 9 % | GRADE & FACTOR 1. E 4. B 2. D 5. A 3. C 6. AA | 3+ |
| STORIES 1. One 4. 1 1/2 2. Two 5. 1 3/4 3. Three 6. 2 1/2 | 4 | KITCHEN STYLE 1. Good 3. Old Style 2. Typical 4. Obsolete | 2 | SQ. FOOTAGE | 1008 |
| EXTERIOR WALLS 1. Clapboard 6. BR/Stone 2. WD.SH. 7. Novelty 3. Comp. 8. AL/Vinyl 4. ASB/ASP 9. Other 5. T1-11 | 8 | BATH(S) STYLE 1. Good 3. Old Style 2. Typical 4. Obsolete | 2 | CONDITION 1. Poor 5. Avg + 2. Fair 6. Good 3. Avg - 7. V Good 4. Avg. 8. Exc. | 8 |
| ROOF SURFACE 1. Asphalt 4. Comp. 2. Slate 5. Wood 3. Metal 6. Other | 1 | # ROOMS | 8 | PHYS. % GOOD | 100 % |
| S/F MASONRY TRIM | | # BEDROOMS | 3 | FUNCT. % GOOD | 100 % |
| YEAR BUILT | 2005 | # FULL BATHS | 1 | FUNCT. CODE 1. Incomp. 5. CDU 2. Overbuilt 6. Style 3. Delap. 7. Layout 4. Small Size 8. Other 9. None | 1 |
| YEAR REMODELED | | # ADDN FIXTURES | | ECON. % GOOD | 100 % |
| FOUNDATION 1. Conc. 4. Wood 2. C Blk 5. Slab 3. Br./Stone 6. Piers | 1 | # FIREPLACES | 1 | ECON. CODE 1. Location 3. Services 2. Encroach 9. None | |
| BASEMENT 1. 1/4 3. 3/4 5. Crawl 2. 1/2 4. Full 6. None | 4 | LAYOUT 1. Typical 2. In adeq. | 9 | ENTRANCE CODE 1. Inspect. 3. Vacant 2. Refused 5. Estim. 3. Info Only | 5 |
| BSMT GAR # CARS | | ATTIC 1. 1/4 Fin 4. Full Fin. 2. 1/2 Fin. 5. F/Stairs 3. 3/4 Fin. 9. None | | INFO. CODE 1. Owner 4. Agent 2. Relative 5. Estimate 3. Tenant 6. Other 2. Refused 5. Estim. | 5 |
| WET BASEMENT 1. Dry 3. Wet 2. Damp 9. None | 1 | INT COMP TO EXIT + = - | | | |
| | | INSPECTED BY | JME KSH | | |
| | | DATE INSPECTED | 6-30-07 7/27/05 | | |

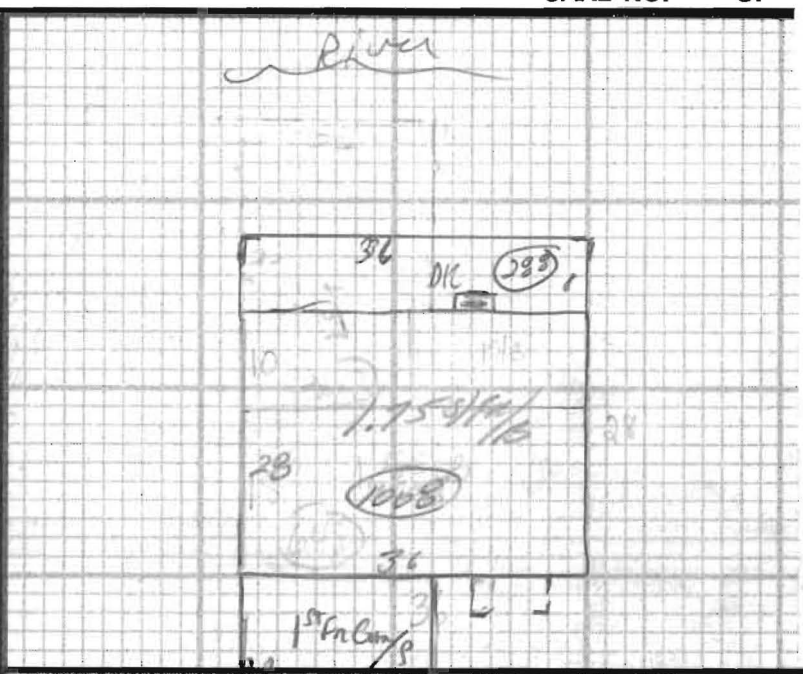

6-3-07
p. 839 - A gar
Rond

| ADDITIONS, OUTBUILDINGS & IMPROVEMENTS | | | | | | PERCENT GOOD | | CODES |
|--|------|-------|-------|------|-------|--------------|-----|--------------------|
| TYPE | YEAR | UNITS | GRADE | COND | Phys. | Funct. | | |
| 1.55/B | 5 | 2005 | 648 | 3+ | 8 | --- | --- | 1. 1S Fr. |
| 15/B | 11 | 2006 | 360 | 3 | --- | --- | --- | 2. 2S Fr. |
| BMT | 37 | 2006 | 360 | 3 | --- | --- | --- | 3. 3S Fr. |
| Gar | 023 | 2006 | 400 | 3 | --- | --- | --- | 4. 1 1/2S Fr. |
| DK | 068 | 2006 | 288 | 3 | --- | --- | --- | 5. 1 3/4S Fr. |
| | | | | | | | | 6. 2 1/2S Fr. |
| | | | | | | | | Add 10 for Bsmt |
| | | | | | | | | 21. OFF |
| | | | | | | | | 22. EFP |
| | | | | | | | | 23. Garage |
| | | | | | | | | 24. Shed |
| | | | | | | | | 25. Bay Window |
| | | | | | | | | 26. Overhang |
| | | | | | | | | 27. Unf. Bsmt |
| | | | | | | | | 28. Unf. Attic |
| | | | | | | | | 29. Fin. Attic |
| | | | | | | | | Add 20 for 2 Story |
| | | | | | | | | 61. Carport |
| | | | | | | | | 62. Patio |
| | | | | | | | | 63. Swimming Pool |
| | | | | | | | | 64. Tennis Court |
| | | | | | | | | 65. Stable w/loft |
| | | | | | | | | 66. Greenhouse |
| | | | | | | | | 67. Natatorium |
| | | | | | | | | 68. Wood Deck |
| | | | | | | | | 69. Jacuzzi |

PHOTO

NOTES: