

TOWN OF WATERBORO, MAINE

MAP **42** LOT **A58** ACCOUNT NO. **2733** BUILDING RECORD ADDRESS

CARD NO. OF

BUILDING STYLE	S/F BSMT LIVING	300	INSULATION	1
1. Conv. 8. Split Lev.	FIN BSMT GRADE	3	1. Full 4. Minimal	
2. Ranch 7. Contemp.		170	2. Heavy 9. None	
3. R. Ranch 8. Log	HEAT TYPE	1	3. Capped	
4. Cape 9. Other	1. HW BB 6. Grav. WA		UNFINISHED %	%
5. Garrison	2. HW CI 7. Electric		GRADE & FACTOR	
DWELLING UNITS	3. HW Radiant 8. Units		1. E 4. B	3+
OTHER UNITS	4. Steam 9. No Heat		2. D 5. A	
STORIES	5. FWA	%	3. C 6. AA	
1. One 4. 1 1/2	COOL TYPE		SQ. FOOTAGE	960
2. Two 5. 1 3/4	1. Central 9. None	9 %	CONDITION	5
3. Three 6. 2 1/2	KITCHEN STYLE		1. Poor 5. Avg +	
EXTERIOR WALLS	1. Good 3. Old Style	2	2. Fair 6. Good	
1. Clapboard 6. BR./Stone	2. Typical 4. Obsolete		3. Avg - 7. V Good	
2. WD.SH. 7. Novelty	BATH(S) STYLE	2	4. Avg. 8. Exc.	%
3. Comp. 8. AL/Vinyl	1. Good 3. Old Style		PHYS. % GOOD	%
4. ASB/ASP 9. Other	2. Typical 4. Obsolete		FUNCT. % GOOD	%
5. T1-11	# ROOMS		FUNCT. CODE	
ROOF SURFACE	# BEDROOMS	3	1. Incomp. 5. CDU	9
1. Asphalt 4. Comp.	# FULL BATHS		2. Overbuilt 6. Style	
2. Slate 5. Wood	# HALF BATHS		3. Delap. 7. Layout	
3. Metal 6. Other	# ADDN FIXTURES		4. Small Size 8. Other	
S/F MASONRY TRIM	# FIREPLACES		9. None	
YEAR BUILT	# HEARTHES		ECON. % GOOD	%
1989	LAYOUT	1	ECON. CODE	
YEAR REMODELED	1. Typical 2. In adeq.		1. Location 3. Services	9
FOUNDATION	ATTIC		2. Encroach 9. None	
1. Conc. 4. Wood	1. 1/4 Fin 4. Full Fin.	9	ENTRANCE CODE	
2. C Blk 5. Stab	2. 1/2 Fin. 5. FV/Stairs		1. Inspct. 3. Vacant	5
3. Br./Stone 6. Piers	3. 3/4 Fin. 9. None		2. Refused 5. Estim.	
BASEMENT	INT COMP TO EXIT + = -		3. Info Only	
1. 1/4 3. 3/4 5. Crawl	INSPECTED BY	RJK	INFO. CODE	
2. 1/2 4. Full 6. None	DATE INSPECTED	G-305	1. Owner 4. Agent	5
BSMT GAR # CARS			2. Relative 5. Estimate	
WET BASEMENT			3. Tenant 6. Other	
1. Dry 3. Wet			2. Refused 5. Estim.	
2. Damp 9. None				

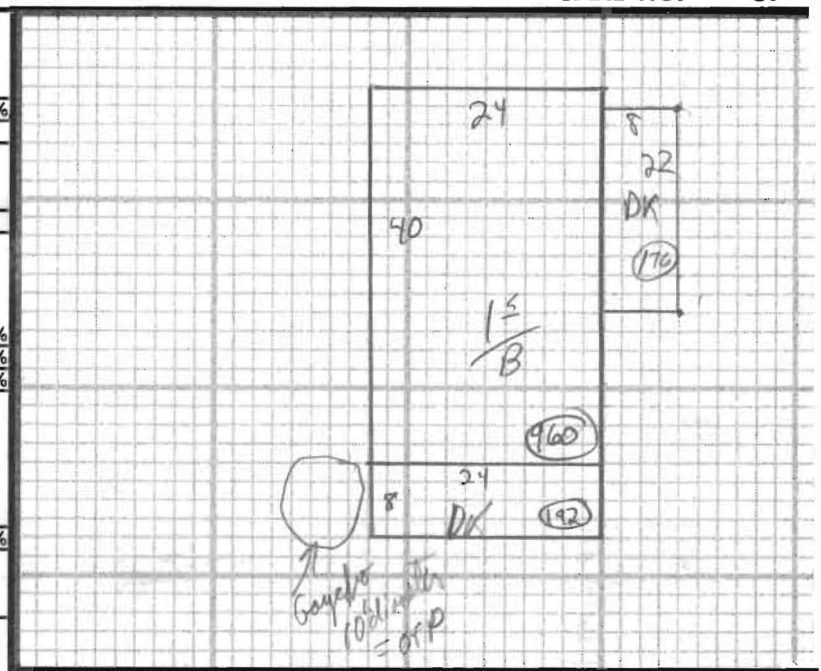

ADDITIONS, OUTBUILDINGS & IMPROVEMENTS

CODES

	TYPE	YEAR	UNITS	GRADE	COND	PERCENT GOOD		
						Phys.	Funct.	
1st Flr	001	1989	0960	---	---	---	---	1. 1S Fr.
DK	068		0176	---	---	---	---	2. 2S Fr.
DK	068		0192	---	---	---	---	3. 3S Fr.
Garage	058		0100	---	---	---	---	4. 1 1/2S Fr.
								5. 1 3/4S Fr.
								6. 2 1/2S Fr.
								Add 10 for Bsmt
								21. OFP
								22. EFP
								23. Garage
								24. Shed
								25. Bay Window
								26. Overhang
								27. Unf. Bsmt
								28. Unf. Attic
								29. Fin. Attic
								Add 20 for 2 Story
								61. Carport
								62. Patio
								63. Swimming Pool
								64. Tennis Court
								65. Stable w/toft
								66. Greenhouse
								67. Natatorium
								68. Wood Deck
								69. Jacuzzi

PHOTO

NOTES: