

010-008

GRAY ANTHONY D & DIANNE M
0 MCLUCAS RD *Ext.*
B 8068 P 251

PROPERTY DATA

NEIGHBORHOOD CODE

STREET CODE

LAND USE

- 11. Residential
- 21. Village
- 22. Village/Res.
- 31. Agricultural/Res.
- 33. Forest/Agri.
- 40. Conservation
- 45. General Purpose
- 48. Shoreland
- 49. Resource Protection

SECONDARY ZONE

TOPOGRAPHY

- 1. Level
- 2. Rolling
- 3. Above St.
- 4. Below St.
- 5. Low
- 6. Swampy
- 7. Steep
- 8.

12

UTILITIES

- 1. All Public
- 2. Public Water
- 3. Public Sewer
- 4. Drilled Well
- 5. Dug Well
- 6. Septic
- 7. Cess Pool
- 9. No Utilities

46

STREET

- 1. Paved
- 2. Semi-Improved
- 3. Gravel
- 4. Proposed
- 9. No Street

3

SALE DATA

DATE(MM/YY)

PRICE

SALE TYPE

- 1. Land
- 2. Land & Bldg.
- 3. Building Only
- 4. Mobile Home
- 5. Other

FINANCING

- 1. Conv.
- 2. FHA/VA
- 3. Assumed
- 4. Seller
- 5. Private
- 6. Cash
- 7. FMHA
- 9. Unknown

VERIFIED

- 1. Buyer
- 2. Seller
- 3. Lender
- 4. Agent
- 5. Record
- 6. MLS
- 7. Family
- 8. Other
- 9. Confid.

VALIDITY

- 1. Valid
- 2. Related
- 3. Distress
- 4. Split
- 5. Partial
- 6. Exempt
- 7. Changed
- 8. Other

BOOK

PAGE

DATE

CONSIDERATION

ASSESSMENT RECORD

YEAR

LAND

BUILDINGS

EXEMPT

TOTAL

LAND DATA

TYPE

EFFECTIVE

INFLUENCE

INFLUENCE CODES

Frontage

Depth

Factor

Code

- FRONT FOOT
- 11. Regular Lot
- 12. Delta Triangle
- 13. Nabla Triangle
- 14. Rear Land
- 15.

- TRIANGULAR
- SQUARE FOOT
- 16. Regular Lot
- 17. Secondary
- 18. Excess Land
- 19. Condo.
- 20.

- FRACT. ACRE
- 21. Homesite
- 22. Baselot
- 23.

- ACRES
- 24. Homesite
- 25. Baselot
- 26. Secondary
- 27. Frontage
- 28. Rear 1
- 29. Rear 2
- 30. Rear 3
- 31. Tillable
- 32. Pasture
- 33. Orchard

Total

- 1=Vacancy
- 2=Excess Frontage
- 3=Topography
- 4=Size/Shape
- 5=Access
- 6=Restrictions
- 7=Corner
- 8=Environment
- 9=Fractional Share

- ACRES (cont.)
- 34. Softwood (F&O)
- 35. Mixed Wood (F&O)
- 36. Hardwood (F&O)
- 37. Softwood (T.G.)
- 38. Mixed Wood (T.G.)
- 39. Hardwood (T.G.)
- 40. Waste
- 41. Gravel Pit

- SITE
- 42. Moho Site
- 43. Condo Site
- 44. Lot Improvements

No./Date	Description	Date Insp.

NOTES:
Part #498 on right

8P

BUILDING RECORD

MAP LOT ACCOUNT NO. ADDRESS CARD NO. OF

BUILDING STYLE 1. Conv. 8. Split Lev. 2. Ranch 7. Contemp. 3. R. Ranch 8. Log 4. Cape 9. Other 5. Garrison	1 <i>cool</i>	S/F BSMT LIVING FIN BSMT GRADE		INSULATION 1. Full 4. Minimal 2. Heavy 9. None 3. Capped	1
DWELLING UNITS OTHER UNITS STORIES 1. One 4. 1 1/2 2. Two 5. 1 3/4 3. Three 6. 2 1/2	1	HEAT TYPE 1. HW BB 6. Grav. WA 2. HW CI 7. Electric 3. HW Radiant 8. Units 4. Steam 9. No Heat 5. FWA	9	UNFINISHED % GRADE & FACTOR 1. E 4. B 2. D 5. A 3. C 6. AA	3
EXTERIOR WALLS 1. Clapboard 6. BR/Stone 2. WD.SH. 7. Novelty 3. Comp. 8. AL/Vinyl 4. ASB/ASP 9. Other 5. T1-11	1	COOL TYPE 1. Central 9. None	9	SQ. FOOTAGE CONDITION 1. Poor 5. Avg + 2. Fair 6. Good 3. Avg - 7. V Good 4. Avg. 8. Exc.	4
ROOF SURFACE 1. Asphalt 4. Comp. 2. Slate 5. Wood 3. Metal 6. Other	3	KITCHEN STYLE 1. Good 3. Old Style 2. Typical 4. Obsolete	2	PHYS. % GOOD FUNCT. % GOOD FUNCT. CODE 1. Incomp. 5. CDU 2. Overbuilt 6. Style 3. Delap. 7. Layout 4. Small Size 8. Other 9. None	100 100
S/F MASONRY TRIM YEAR BUILT YEAR REMODELED FOUNDATION 1. Conc. 4. Wood 2. C Blk 5. Stab 3. Br./Stone 6. Piers	2004	BATH(S) STYLE 1. Good 3. Old Style 2. Typical 4. Obsolete	<i>athouse</i>	ECON. % GOOD ECON. CODE 1. Location 3. Services 2. Encroach 9. None	100
BASEMENT 1. 1/4 3. 3/4 5. Crawl 2. 1/2 4. Full 6. None	6	# ROOMS # BEDROOMS # FULL BATHS # HALF BATHS # ADDN FIXTURES # FIREPLACES # HEARTHES LAYOUT 1. Typical 2. In adeq.	3 1	ENTRANCE CODE 1. Inspct. 3. Vacant 2. Refused 5. Estim. 3. Info Only	5
WET BASEMENT 1. Dry 3. Wet 2. Damp 9. None	9	INT COMP TO EXIT + - - INSPECTED BY DATE INSPECTED	<i>KSH</i> <i>11/10/05</i>	INFO. CODE 1. Owner 4. Agent 2. Relative 5. Estimate 3. Tenant 6. Other 2. Refused 5. Estim.	5

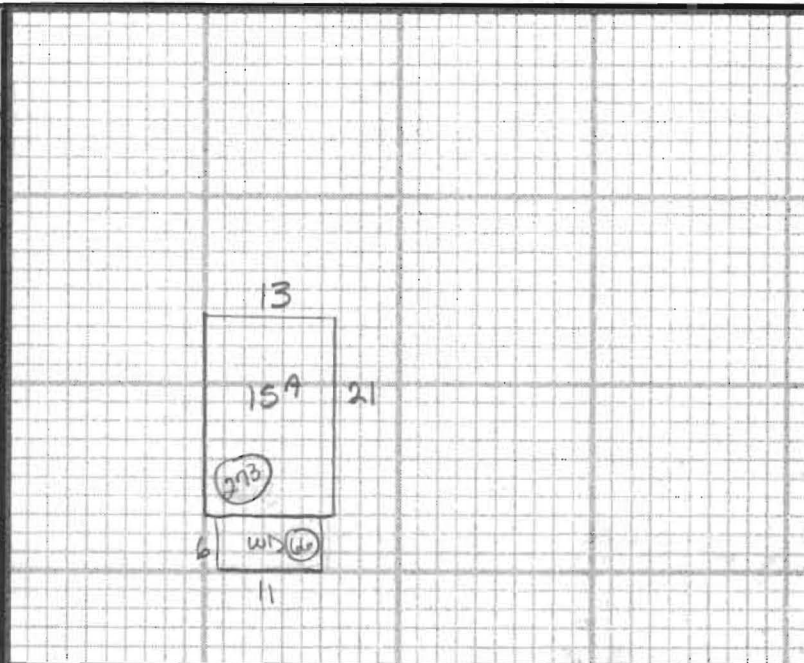

ADDITIONS, OUTBUILDINGS & IMPROVEMENTS						PERCENT GOOD		CODES
TYPE	YEAR	UNITS	GRADE	COND	Phys.	Funct.		
1S	121	2004	223					1. 1S Fr.
WD	68		66					2. 2S Fr. 3. 3S Fr. 4. 1 1/2S Fr. 5. 1 3/4S Fr. 6. 2 1/2S Fr.
								Add 10 for Bsmt 21. OFP 22. EFP 23. Garage 24. Shed 25. Bay Window 26. Overhang 27. Unf. Bsmt 28. Unf. Attic 29. Fin. Attic
								Add 20 for 2 Story 61. Carport 62. Patio 63. Swimming Pool 64. Tennis Court 65. Stable w/toft 66. Greenhouse 67. Natatorium 68. Wood Deck 69. Jacuzzi

PHOTO

NOTES: