

Moody Carolyn
636 Middle Road

PROPERTY DATA

NEIGHBORHOOD CODE 65
STREET CODE _____

LAND USE

11. Residential
21. Village
22. Village/Res.
31. Agricultural/Res.
33. Forest/Agri.
40. Conservation
45. General Purpose
48. Shoreland
49. Resource Protection

33

SECONDARY ZONE

TOPOGRAPHY

1. Level 5. Low
2. Rolling 6. Swampy
3. Above St. 7. Steep
4. Below St. 8. _____

02

UTILITIES

1. All Public 5. Dug Well
2. Public Water 6. Septic
3. Public Sewer 7. Cess Pool
4. Drilled Well 9. No Utilities

09

STREET

1. Paved 4. Proposed
2. Semi-Improved
3. Gravel 9. No Street

1

SALE DATA

DATE(MM/YY) ___/___/___

PRICE

SALE TYPE

1. Land 4. Mobile
2. Land & Bldg. Home
3. Building Only 5. Other

FINANCING

1. Conv. 5. Private
2. FHA/VA 6. Cash
3. Assumed 7. FMHA
4. Seller 9. Unknown

VERIFIED

1. Buyer 6. MLS
2. Seller 7. Family
3. Lender 8. Other
4. Agent 9. Confid.
5. Record

VALIDITY

1. Valid 5. Partial
2. Related 6. Exempt
3. Distress 7. Changed
4. Split 8. Other

BOOK	PAGE	DATE	CONSIDERATION

ASSESSMENT RECORD

YEAR	LAND	BUILDINGS	EXEMPT	TOTAL

LAND DATA

FRONT FOOT	TYPE	EFFECTIVE		INFLUENCE		INFLUENCE CODES
		Frontage	Depth	Factor	Code	
11. Regular Lot	---	---	---	---	%	---
12. Delta Triangle	---	---	---	---	%	---
13. Nabla Triangle	---	---	---	---	%	---
14. Rear Land	---	---	---	---	%	---
15.	---	---	---	---	%	---
16. Regular Lot	---	---	---	---	%	---
17. Secondary	---	---	---	---	%	---
18. Excess Land	---	---	---	---	%	---
19. Condo.	---	---	---	---	%	---
20.	---	---	---	---	%	---
21. Homesite	---	---	•	---	%	---
22. Baselot	---	---	•	---	%	---
23.	---	---	•	---	%	---
24. Homesite	---	---	•	---	%	---
25. Baselot	---	---	•	---	%	---
26. Secondary	---	---	•	---	%	---
27. Frontage	---	---	•	---	%	---
28. Rear 1	---	---	•	---	%	---
29. Rear 2	---	---	•	---	%	---
30. Rear 3	---	---	•	---	%	---
31. Tillable	---	---	•	---	%	---
32. Pasture	---	---	•	---	%	---
33. Orchard	---	---	•	---	%	---
Total	---	---	•	---	%	---

- 1=Vacancy
- 2=Excess Frontage
- 3=Topography
- 4=Size/Shape
- 5=Access
- 6=Restrictions
- 7=Corner
- 8=Environment
- 9=Fractional Share

- ACRES (cont.)**
- 34. Softwood (F&O)
 - 35. Mixed Wood (F&O)
 - 36. Hardwood (F&O)
 - 37. Softwood (T.G.)
 - 38. Mixed Wood (T.G.)
 - 39. Hardwood (T.G.)
 - 40. Waste
 - 41. Gravel Pit

- SITE**
- 42. Moho Site
 - 43. Condo Site
 - 44. Lot Improvements

No./Date	Description	Date Insp.

NOTES:

Gated/locked
no entry to property

Dome House sat.

AD

BUILDING RECORD

MAP LOT ACCOUNT NO. 589 ADDRESS CARD NO. OF

BUILDING STYLE 1. Conv. 6. Split Lev. 2. Ranch 7. Contemp. 3. R. Ranch 8. Log 4. Cape 9. Other 5. Garrison	7 DOME	S/F BSMT LIVING FIN BSMT GRADE		INSULATION 1. Full 4. Minimal 2. Heavy 9. None 3. Capped	1
DWELLING UNITS		HEAT TYPE 1. HW BB 6. Grav. WA 2. HW CI 7. Electric 3. HW Radiant 8. Units 4. Steam 9. No Heat 5. FWA	7 100%	UNFINISHED %	%
OTHER UNITS		COOL TYPE 1. Central 9. None	9%	GRADE & FACTOR 1. E 4. B 2. D 5. A 3. C 6. AA	3-
STORIES 1. One 4. 1 1/2 2. Two 5. 1 3/4 3. Three 6. 2 1/2	1	KITCHEN STYLE 1. Good 3. Old Style 2. Typical 4. Obsolete	2	SQ. FOOTAGE	1296
EXTERIOR WALLS 1. Clapboard 6. BR/Stone 2. WD.SH. 7. Novelty 3. Comp. 8. AL/Vinyl 4. ASB/ASP 9. Other 5. T1-11	2	BATH(S) STYLE 1. Good 3. Old Style 2. Typical 4. Obsolete	2	CONDITION 1. Poor 5. Avg + 2. Fair 6. Good 3. Avg - 7. V Good 4. Avg. 8. Exc.	4/6
ROOF SURFACE 1. Asphalt 4. Comp. 2. Slate 5. Wood 3. Metal 6. Other	1	# ROOMS	4	PHYS. % GOOD	100%
S/F MASONRY TRIM		# BEDROOMS	2	FUNCT. % GOOD	100%
YEAR BUILT	1985	# FULL BATHS	1	FUNCT. CODE 1. Incomp. 5. CDU 2. Overbuilt 6. Style 3. Delap. 7. Layout 4. Small Size 8. Other 9. None	9
YEAR REMODELED	1987	# HALF BATHS	1	ECON. % GOOD	100%
FOUNDATION 1. Conc. 4. Wood 2. C Blk 5. Slab 3. Br./Stone 6. Piers	15	# ADDN FIXTURES	1	ECON. CODE 1. Location 3. Services 2. Encroach 9. None	
BASEMENT 1. 1/4 3. 3/4 5. Crawl 2. 1/2 4. Full 6. None	4	# FIREPLACES	1	ENTRANCE CODE 1. Inspct. 3. Vacant 2. Refused 5. Estim. 3. Info Only	3 5
BSMT GAR # CARS		LAYOUT 1. Typical 2. In adeq.	9	INFO. CODE 1. Owner 4. Agent 2. Relative 5. Estimate 3. Tenant 6. Other 2. Refused 5. Estim.	1 5
WET BASEMENT 1. Dry 3. Wet 2. Damp 9. None	1	ATTIC 1. 1/4 Fin 4. Full Fin. 2. 1/2 Fin. 5. Fl/Stairs 3. 3/4 Fin. 9. None		INT COMP TO EXIT + F -	
		INSPECTED BY Info on 7/16/07 KSH		DATE INSPECTED 2/11/06	

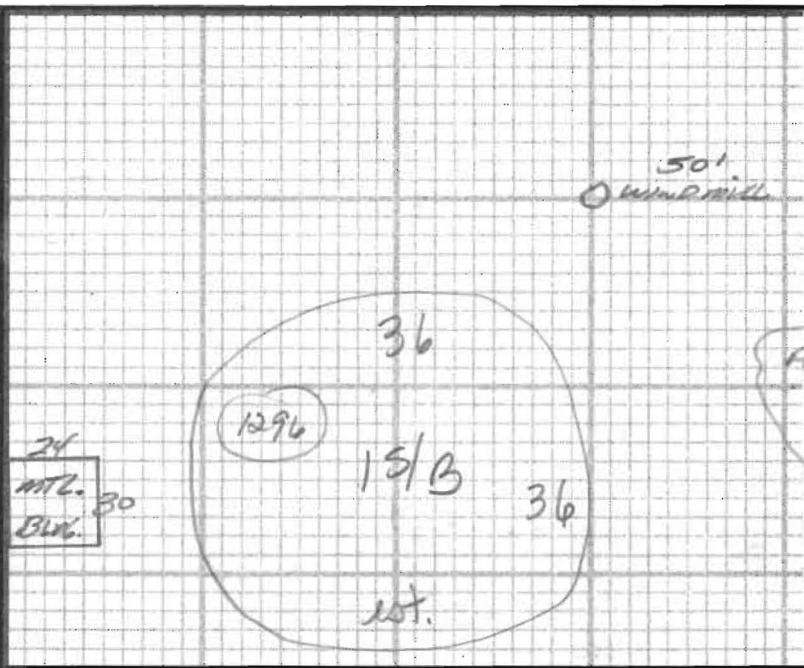

ADDITIONS, OUTBUILDINGS & IMPROVEMENTS

	TYPE	YEAR	UNITS	GRADE	COND	PERCENT GOOD		CODES
						Phys.	Funct.	
15/3			1296			%	%	1. 1S Fr. 2. 2S Fr. 3. 3S Fr. 4. 1 1/2S Fr. 5. 1 3/4S Fr. 6. 2 1/2S Fr. Add 10 for Bsmt 21. OPF 22. EFP 23. Garage 24. Shed 25. Bay Window 26. Overhang 27. Unf. Bsmt 28. Unf. Attic 29. Fin. Attic Add 20 for 2 Story 61. Carport 62. Patio 63. Swimming Pool 64. Tennis Court 65. Stable w/loft 66. Greenhouse 67. Natatorium 68. Wood Deck 69. Jacuzzi
mtg. Blw		2008	220	3.0	2	25.00%	%	
Window mill		2008	50'	3.0	2	12.50%	%	

PHOTO

NOTES: