

MAP LOT

ACCOUNT NO. 582 ADDRESS

TOWN OF WATERBORO, MAINE

CARD NO. OF

006-029-001

HALL DAVID J & MARY E
959 WEST ROAD
B 7708 P 113

PROPERTY DATA			ASSESSMENT RECORD									
NEIGHBORHOOD CODE	70	STREET CODE	---	YEAR	LAND	BUILDINGS	EXEMPT	TOTAL				
LAND USE		SECONDARY ZONE	---	TOPOGRAPHY								
11. Residential 21. Village 22. Village/Res. 31. Agricultural/Res. 33. Forest/Agri. 40. Conservation 45. General Purpose 48. Shoreland 49. Resource Protection	31											
UTILITIES		STREET		LAND DATA								
1. All Public 2. Public Water 3. Public Sewer 4. Drilled Well 5. Dug Well 6. Septic 7. Cess Pool 9. No Utilities	09	1. Paved 2. Semi-Improved 3. Gravel 4. Proposed 9. No Street	+	FRONT FOOT	TYPE	EFFECTIVE		INFLUENCE		INFLUENCE CODES		
						Frontage	Depth	Factor	Code			
						---	---	---	---		---	
						---	---	---	---		---	
SALE DATA				SQUARE FOOT	SQUARE FEET					ACRES (cont.)		
FINANCING				FRACT. ACRE	ACREAGE/SITES					SITE		
1. Conv. 2. FHA/VA 3. Assumed 4. Seller	5. Private 6. Cash 7. FMHA 9. Unknown											
VERIFIED				ACRES					Improvements			
1. Buyer 2. Seller 3. Lender 4. Agent 5. Record	6. MLS 7. Family 8. Other 9. Confid.											
VALIDITY				Total								
1. Valid 2. Related 3. Distress 4. Split	5. Partial 6. Exempt 7. Changed 8. Other											

No./Date	Description	Date Insp.

NOTES:

- 1=Vacancy
- 2=Excess Frontage
- 3=Topography
- 4=Size/Shape
- 5=Access
- 6=Restrictions
- 7=Corner
- 8=Environment
- 9=Fractional Share

- ACRES (cont.)
- 34. Softwood (F&O)
- 35. Mixed Wood (F&O)
- 36. Hardwood (F&O)
- 37. Softwood (T.G.)
- 38. Mixed Wood (T.G.)
- 39. Hardwood (T.G.)
- 40. Waste
- 41. Gravel Pit

- SITE
- 42. Moho Site
- 43. Condo Site
- 44. Lot
- Improvements

14A

BUILDING RECORD

MAP LOT ACCOUNT NO. ADDRESS CARD NO. OF

BUILDING STYLE 1. Conv. 6. Split Lev. 2. Ranch 7. Contemp. 3. R. Ranch 8. Log 4. Cape 9. Other 5. Garrison	4	S/F BSMT LIVING FIN BSMT GRADE		INSULATION 1. Full 4. Minimal 2. Heavy 9. None 3. Capped	1
DWELLING UNITS	1	HEAT TYPE 1. HW BB 6. Grav. WA 2. HW CI 7. Electric 3. HW Radiant 8. Units 4. Steam 9. No Heat 5. FWA	100 %	UNFINISHED %	%
OTHER UNITS		COOL TYPE 1. Central 9. None	9 %	GRADE & FACTOR 1. E 4. B 2. D 5. A 3. C 6. AA	3
STORIES 1. One 4. 1 1/2 2. Two 5. 1 3/4 3. Three 6. 2 1/2	4	KITCHEN STYLE 1. Good 3. Old Style 2. Typical 4. Obsolete	2	SQ. FOOTAGE	
EXTERIOR WALLS 1. Clapboard 6. BR/Stone 2. WD.SH. 7. Novelty 3. Comp. 8. AL/Vinyl 4. ASB/ASP 9. Other 5. T1-11	8	BATH(S) STYLE 1. Good 3. Old Style 2. Typical 4. Obsolete	2	CONDITION 1. Poor 5. Avg + 2. Fair 6. Good 3. Avg - 7. V Good 4. Avg. 8. Exc.	4
ROOF SURFACE 1. Asphalt 4. Comp. 2. Slate 5. Wood 3. Metal 6. Other	1	# ROOMS	6	PHYS. % GOOD	100 %
S/F MASONRY TRIM		# BEDROOMS	3	FUNCT. % GOOD	100 %
YEAR BUILT	1990	# FULL BATHS	2	FUNCT. CODE 1. Incomp. 5. CDU 2. Overbuilt 6. Style 3. Delap. 7. Layout 4. Small Size 8. Other 9. None	
YEAR REMODELED		# HALF BATHS		ECON. % GOOD	100 %
FOUNDATION 1. Conc. 4. Wood 2. C Blk 5. Stab 3. Br./Stone 6. Piers	1	# ADDN FIXTURES		ECON. CODE 1. Location 3. Services 2. Encroach 9. None	
BASEMENT 1. 1/4 3. 3/4 5. Crawl 2. 1/2 4. Full 6. None	4	# HEARTHES		ENTRANCE CODE 1. Inspect. 3. Vacant 2. Refused 5. Estim. 3. Info Only	5
BSMT GAR # CARS		LAYOUT 1. Typical 2. In adeq.	1	INFO. CODE 1. Owner 4. Agent 2. Relative 5. Estimate 3. Tenant 6. Other 2. Refused 5. Estim.	5
WET BASEMENT 1. Dry 3. Wet 2. Damp 9. None	1	ATTIC 1. 1/4 Fin 4. Full Fin. 2. 1/2 Fin. 5. FV/Stairs 3. 3/4 Fin. 9. None	9		
		INT COMP TO EXIT + = -			
		INSPECTED BY	KSH		
		DATE INSPECTED	12/8/25		

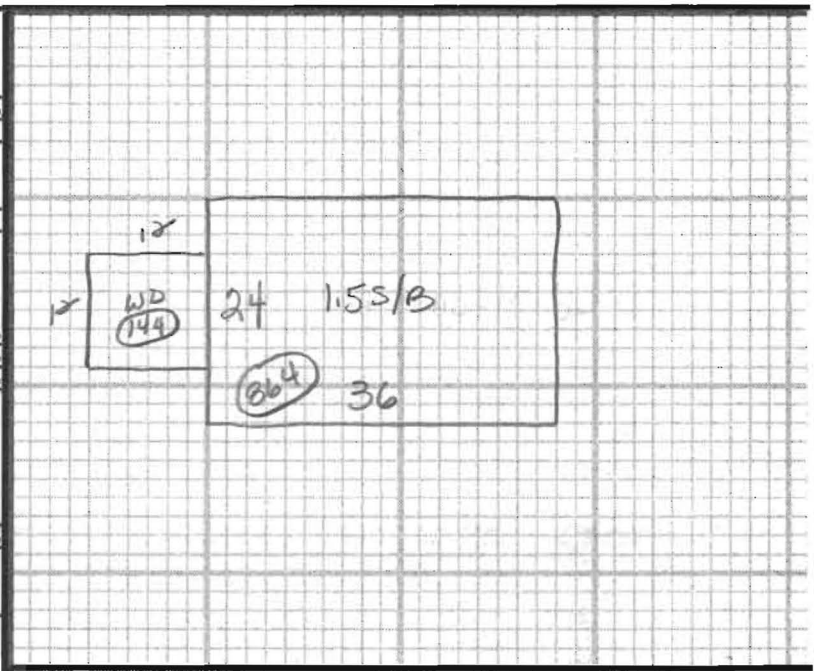

ADDITIONS, OUTBUILDINGS & IMPROVEMENTS						PERCENT GOOD		CODES
TYPE	YEAR	UNITS	GRADE	COND	Phys.	Funct.		
153/B	4	864			%	%	1. 1S Fr.	
WD	68	144	3	3	%	%	2. 2S Fr.	
					%	%	3. 3S Fr.	
					%	%	4. 1 1/2S Fr.	
					%	%	5. 1 3/4S Fr.	
					%	%	6. 2 1/2S Fr.	
					%	%	Add 10 for Bsmt	
					%	%	21. OFP	
					%	%	22. EFP	
					%	%	23. Garage	
					%	%	24. Shed	
					%	%	25. Bay Window	
					%	%	26. Overhang	
					%	%	27. Unf. Bsmt	
					%	%	28. Unf. Attic	
					%	%	29. Fin. Attic	
					%	%	Add 20 for 2 Story	
					%	%	61. Carport	
					%	%	62. Patio	
					%	%	63. Swimming Pool	
					%	%	64. Tennis Court	
					%	%	65. Stable w/loft	
					%	%	66. Greenhouse	
					%	%	67. Natatorium	
					%	%	68. Wood Deck	
					%	%	69. Jacuzzi	

PHOTO

NOTES: