

MAP LOT

ACCOUNT NO. 113

ADDRESS

TOWN OF WATERBORO, MAINE

CARD NO. OF

MH

002-001-001

EUGLEY PERCY
52 MAY ST
B 7547 P 147

002-001-001

WEST DAWN C
52 MAY STREET
12/16/2005 \$123,500

002-001-001

BUTTERFIELD DAWN W
52 MAY STREET
12/16/2005 \$123,500

PROPERTY DATA

NEIGHBORHOOD CODE 50

STREET CODE

LAND USE

- 11. Residential
 - 21. Village
 - 22. Village/Res.
 - 31. Agricultural/Res.
 - 33. Forest/Agri.
 - 40. Conservation
 - 45. General Purpose
 - 48. Shoreland
 - 49. Resource Protection
- MH

SECONDARY ZONE

TOPOGRAPHY

- 1. Level
 - 2. Rolling
 - 3. Above St.
 - 4. Below St.
 - 5. Low
 - 6. Swampy
 - 7. Steep
 - 8.
- 01

UTILITIES

- 1. All Public
 - 2. Public Water
 - 3. Public Sewer
 - 4. Drilled Well
 - 5. Dug Well
 - 6. Septic
 - 7. Cess Pool
 - 9. No Utilities
- 02

STREET

- 1. Paved
 - 2. Semi-Improved
 - 3. Gravel
 - 4. Proposed
 - 9. No Street
- L

SALE DATA

DATE(MM/YY) --/ /

PRICE

SALE TYPE

- 1. Land
- 2. Land & Bldg.
- 3. Building Only
- 4. Mobile Home
- 5. Other

FINANCING

- 1. Conv.
- 2. FHA/VA
- 3. Assumed
- 4. Seller
- 5. Private
- 6. Cash
- 7. FMHA
- 9. Unknown

VERIFIED

- 1. Buyer
- 2. Seller
- 3. Lender
- 4. Agent
- 5. Record
- 6. MLS
- 7. Family
- 8. Other
- 9. Confid.

VALIDITY

- 1. Valid
- 2. Related
- 3. Distress
- 4. Split
- 5. Partial
- 6. Exempt
- 7. Changed
- 8. Other

BOOK	PAGE	DATE	CONSIDERATION
		12/16/05	123,500

ASSESSMENT RECORD				
YEAR	LAND	BUILDINGS	EXEMPT	TOTAL

LAND DATA						
FRONT FOOT	TYPE	EFFECTIVE		INFLUENCE		INFLUENCE CODES
		Frontage	Depth	Factor	Code	
11. Regular Lot					%	1=Vacancy
12. Delta Triangle					%	2=Excess Frontage
13. Nabla Triangle					%	3=Topography
14. Rear Land					%	4=Size/Shape
15.					%	5=Access
					%	6=Restrictions
					%	7=Corner
					%	8=Environment
					%	9=Fractional Share
SQUARE FOOT	TYPE	SQUARE FEET		%		ACRES (cont.)
16. Regular Lot						
17. Secondary						35. Mixed Wood (F&O)
18. Excess Land						36. Hardwood (F&O)
19. Condo.						37. Softwood (T.G.)
20.						38. Mixed Wood (T.G.)
FRACT. ACRE	TYPE	ACREAGE/SITES		%		ACRES (cont.)
21. Homesite						
22. Baselot						40. Waste
23.						41. Gravel Pit
ACRES	TYPE	%				SITE
24. Homesite						
25. Baselot						43. Condo Site
26. Secondary						44. Lot Improvements
27. Frontage						
28. Rear 1						
29. Rear 2						
30. Rear 3						
31. Tillable						
32. Pasture						
33. Orchard						
Total						

No./Date	Description	Date Insp.

NOTES:

M4

BUILDING RECORD

MAP LOT ACCOUNT NO. ADDRESS CARD NO. OF

BUILDING STYLE 1. Conv. 6. Split Lev. 2. Ranch 7. Contemp. 3. R. Ranch 8. Log 4. Cape 9. Other 5. Garrison	2	S/F BSMT LIVING FIN BSMT GRADE	5	INSULATION 1. Full 4. Minimal 2. Heavy 9. None 3. Capped	1
DWELLING UNITS OTHER UNITS	1 0	HEAT TYPE 1. HW BB 6. Grav. WA 2. HW CI 7. Electric 3. HW Radiant 8. Units 4. Steam 9. No Heat 5. FWA	5	UNFINISHED % GRADE & FACTOR 1. E 4. B 2. D 5. A 3. C 6. AA	4
STORIES 1. One 4. 1 1/2 2. Two 5. 1 3/4 3. Three 6. 2 1/2	1	COOL TYPE 1. Central 9. None	7	SQ. FOOTAGE CONDITION	1064
EXTERIOR WALLS 1. Clapboard 6. BR./Stone 2. WD.SH. 7. Novelty 3. Comp. 8. AL/Vinyl 4. ASB/ASP 9. Other 5. T1-11	8	KITCHEN STYLE 1. Good 3. Old Style 2. Typical 4. Obsolete	2	PHYS. % GOOD FUNCT. % GOOD	6
ROOF SURFACE 1. Asphalt 4. Comp. 2. Slate 5. Wood 3. Metal 6. Other	1	BATH(S) STYLE 1. Good 3. Old Style 2. Typical 4. Obsolete	2	FUNCT. CODE 1. Incomp. 5. CDU 2. Overbuilt 6. Style 3. Delap. 7. Layout 4. Small Size 8. Other 9. None	1
S/F MASONRY TRIM YEAR BUILT YEAR REMODELED	1995	# ROOMS # BEDROOMS # FULL BATHS # HALF BATHS # ADDN FIXTURES # FIREPLACES # HEARTHES	9 2 2 2	ECON. % GOOD ECON. CODE	1
FOUNDATION 1. Conc. 4. Wood 2. C Blk 5. Slab 3. Br./Stone 6. Piers	5	LAYOUT 1. Typical 2. In adeq.	1	ENTRANCE CODE 1. Inspct. 3. Vacant 2. Refused 5. Estim. 3. Info Only	1
BASEMENT 1. 1/4 3. 3/4 5. Crawl 2. 1/2 4. Full 6. None	0	ATTIC 1. 1/4 Fin. 4. Full Fin. 2. 1/2 Fin. 5. FU/Stairs 3. 3/4 Fin. 9. None	9	INFO. CODE 1. Owner 4. Agent 2. Relative 5. Estimate 3. Tenant 6. Other 2. Refused 5. Estim.	1
BSMT GAR # CARS WET BASEMENT 1. Dry 3. Wet 2. Damp 9. None	9	INT COMP TO EXIT + = - INSPECTED BY DATE INSPECTED	JCS 9/28/05		

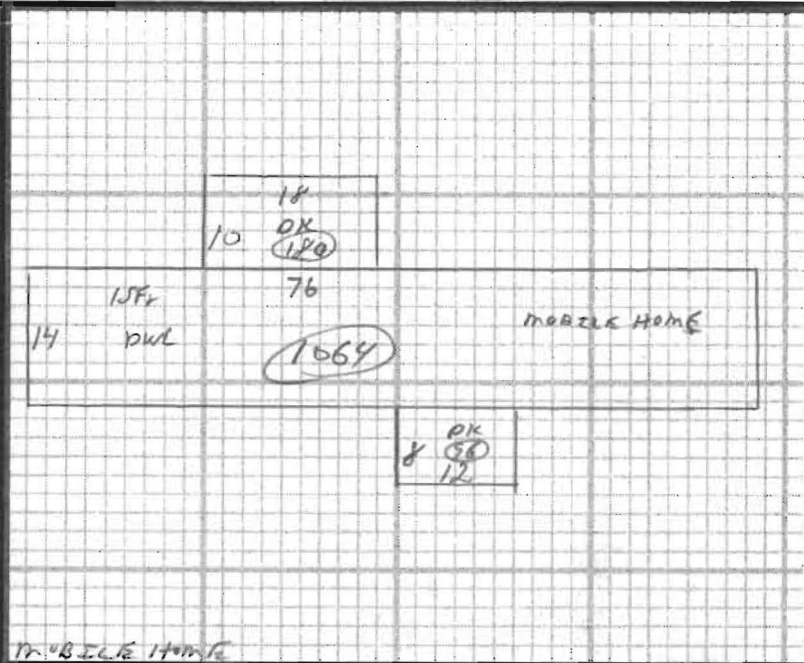

ADDITIONS, OUTBUILDINGS & IMPROVEMENTS						PERCENT GOOD		CODES
TYPE	YEAR	UNITS	GRADE	COND	Phys.	Funct.		
DWL	998	1995	1064	3.00	6	---	---	1. 1S Fr. 2. 2S Fr. 3. 3S Fr. 4. 1 1/2S Fr. 5. 1 3/4S Fr. 6. 2 1/2S Fr. Add 10 for Bsmt
DK	068		96		2	---	---	21. OFF 22. EFP
DK	068		180		3	---	---	23. Garage 24. Shed
Comp. Sub	103		1064			---	---	25. Bay Window 26. Overhang 27. Unf. Bsmt 28. Unf. Attic 29. Fin. Attic Add 20 for 2 Story
						---	---	61. Carport 62. Patio 63. Swimming Pool 64. Tennis Court 65. Stable w/loft 66. Greenhouse 67. Natatorium 68. Wood Deck 69. Jacuzzi

PHOTO

NOTES: