

PERRY NATHAN M
91 PINECREST CIRCLE
NORTH WATERBORO ME 04061

B12245P202 B17111P692

Previous Owner
DUGAL LEON
C/O NATHAN M PERRY
91 PINECREST CIRCLE
NORTH WATERBORO ME 04061
Sale Date: 10/07/2015

Inspection Witnessed By:

No./Date	Description	Date Insp.
X		

Notes:
20.0505 - changed garage to 1st addition, added deck -sb

Waterboro

Property Data			Assessment Record							
Neighborhood 1 LAC WEST			Year	Land	Buildings	Exempt	Total			
Tree Growth Year 0			2012	30,000	100,100	10,000	120,100			
1ST MORTGAGE 0			2013	30,000	100,100	10,000	120,100			
2ND MORTGAGE 0			2014	30,000	100,100	10,000	120,100			
Zone/Land Use 47 Lake Arrowhead			2015	30,000	100,100	10,000	120,100			
Secondary Zone			2016	15,000	99,100	0	114,100			
Topography 2 Rolling			2017	15,000	99,100	0	114,100			
1.Level 4.Below St 7.Steep			2018	15,000	99,100	0	114,100			
2.Rolling 5.Low 8.Wet			2019	15,000	99,100	0	114,100			
3.Above St 6.Swampy 9.Lev/Roll			2020	15,000	99,100	0	114,100			
Utilities 9 No Water/No Sewer			2021	16,500	100,500	0	117,000			
1.Public 4.Improve 7.Improve			2022	18,000	110,600	0	128,600			
2.Water 5.Improve 8.			2023	19,800	122,600	0	142,400			
3.Sewer 6.Improve 9.None			2024	22,200	138,300	0	160,500			
Street 3 Gravel			2025	30,000	198,100	0	228,100			
1.Paved 4.Proposed 7.ROW			Land Data							
2.Semi Imp 5.Pvt 8.None										
3.Gravel 6.Aband 9.TG PLAN			Front Foot	Type	Effective		Influence		Influence Codes	
LAND USE 0			11.Ossipee WF		Frontage	Depth	Factor	Code		
BUILDING USE 0			12.Arrowhead WF				%		1.Unimproved	
Sale Data			13.Waterfront				%		2.Excess Ftg /De	
Sale Date 10/07/2015			14.Rear Land				%		3.Topography	
Price 113,000			15.Misc				%		4.Size/Shape	
Sale Type 2 Land & Buildings							%		5.Access or Rear	
1.Land 4.Mobile 7.			Square Foot				%		6.Restriction	
2.L & B 5.Other 8.			16.Regular Lot	16		1	100	%	0	7.Open Space
3.Building 6. 9.			17.Secondary Lot				%			8.View/Environ
Financing 1 Conventional			18.Excess Land				%			9.Fract Share
1.Convent 4.Seller 7.			19.Condominium				%			Acres
2.FHA/VA 5.Private 8.			20.Pavement				%			30.Rear (201+)
3.Assumed 6.Cash 9.Unknown							%			31.Tillable/Horti
Validity 1 Arms Length Sale			Fract. Acre				%			32.Pasture
1.Valid 4.Split 7.Renovate			21.Homesite (Frac				%			33.Orchard
2.Related 5.Partial 8.Other			22.Vacant Lot (Fr				%			34.Frontage
3.Distress 6.Exempt 9.			23.Non Conforming				%			35.Triangular Lot
Verified 1 Buyer			Acres				%			36.Commercial
1.Buyer 4.Agent 7.Family			24.Excess (5-10)				%			37.Softwood
2.Seller 5.Pub Rec 8.Other			25.Excess (10+)				%			38.Mixed Wood
3.Lender 6.MLS 9.			26.Excess				%			39.Hardwood
			27.Rear (1-100)				%			40.Wasteland
			28.Rear (101-150)				%			41.Gravel Pit (Ac
			29.Rear (151-200)				%			42.Mobile Home Si
			Total Acreage		0.00					

46.Site Improve

Waterboro

Map Lot 046-002-129

Account 3681

Location 91 PINECREST CIRCLE

Card 1 Of 1

9/23/2024

Building Style	1 Conventional			SF Bsmt Living	0			Layout	1 Typical		
1.Conv	5.Garr/Col	9.Other		Fin Bsmt Grade	0 0			1.Typical	4.	7.	
2.Ranch	6.Split	10.Mohome		OPEN 5 OPTIONAL 0			2.Inadeq	5.	8.		
3.R Ranch	7.Contemp/	11.Condo		Heat Type	100% 5 Force Warm Air			3.Not func	6.	9.	
4.Cape	8.Log	12.		1.HWBB	5.FWA	9.No Heat	Attic 9 None				
Dwelling Units 1				2.HWCI	6.GravWA	10.	1.1/4 Fin	4.Full Fin	7.1/4 Unfi		
Other Units 0				3.HWRAD	7.Electric	11.	2.1/2 Fin	5.FI/Stair	8.		
Stories 4 One & 1/2 Story				4.Steam	8.FI/WallM	12.	3.3/4 Fin	6.1/2 Unfi	9.None		
1.1	4.1.50	7.1.25		Cool Type 0% 9 None			Insulation 1 Full				
2.2	5.1.75	8.		1.Refrig	4.W&C Air	7.	1.Full	4.Minimal	7.		
3.3	6.2.50	9.		2.Evapor	5.	8.	2.Heavy	5.Unk	8.		
Exterior Walls 1 Wood Siding				3.H Pump	6.	9.None	3.Capped 6. 9.None				
0.Wood	4.Asb/Asph	8.Alum/Vin		Kitchen Style 2 Typical			Unfinished % 0%				
1.Wood	5.T-111	9.Other		1.Modern	4.Obsolete	7.	Grade & Factor 3 Average 100%				
2.Wd Sh	6.Br/St	11.		2.Typical	5.	8.	1.E Grade	4.B Grade	7.AAA Grad		
3.Compos.	7.Nov	12.		3.Old Type	6.	9.None	2.D Grade	5.A Grade	8.		
Roof Surface 1 Asphalt Shingles				Bath(s) Style 2 Typical Bath(s)			3.C Grade 6.AA Grade 9.Same				
1.Asphalt	4.Composit	7.		1.Modern	4.Obsolete	7.	SQFT (Footprint) 432				
2.Slate	5.Wood	8.		2.Typical	5.	8.	Condition 6 Good				
3.Metal	6.Other	9.		3.Old Type	6.	9.None	1.Poor	4.Avg	7.V G		
SF Masonry Trim 0				# Rooms 5			2.Fair	5.Avg+	8.Exc		
OPEN-3- 0				# Bedrooms 2			3.Avg-	6.Good	9.Same		
OPEN-4- 0				# Full Baths 1			Phys. % Good 0%				
Year Built 2000				# Half Baths 0			Funct. % Good 100%				
Year Remodeled 0				# Addn Fixtures 0			Functional Code 9 None				
Foundation 5 Concrete Slab				# Fireplaces 0			1.Incomp	4.Small	7.Layout		
1.Concrete	4.Wood	7.									
2.C Block	5.Slab	8.									
3.Br/Stone	6.Prs/Post	9.									
Basement 9 No Basement											
1.1/4 Bmt	4.Full Bmt	7.									
2.1/2 Bmt	5.None	8.									
3.3/4 Bmt	6.	9.None									
Bsmt Gar # Cars 0											
Wet Basement 9 No Basement											
1.Dry	4.	7.									
2.Damp	5.	8.									
3.Wet	6.	9.									

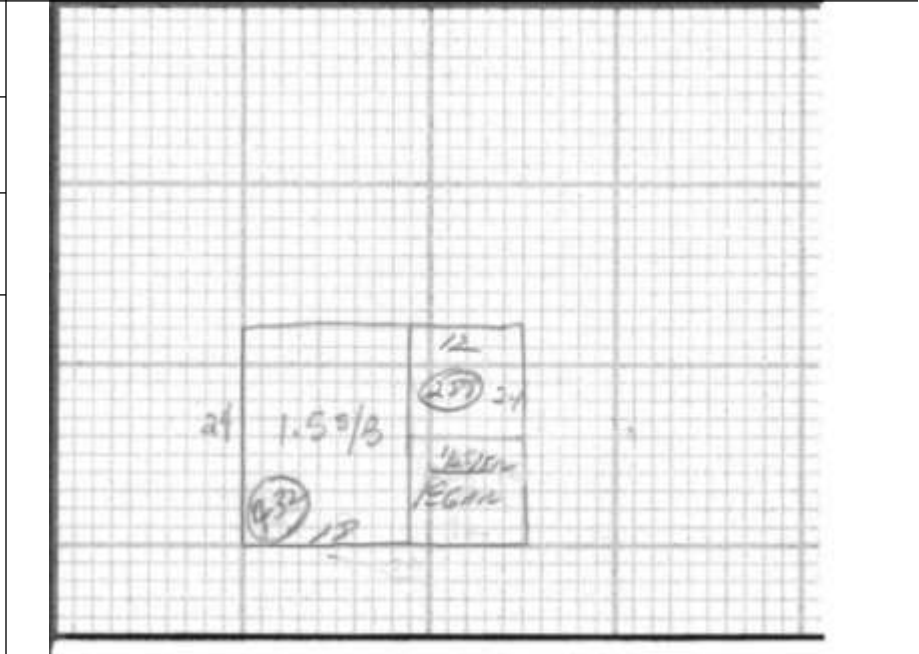

Date Inspected

Additions, Outbuildings & Improvements

Type	Year	Units	Grade	Cond	Phys.	Funct.	Sound Value
1 One Story Frame	0	288	0 0	0	0	0 %	%
68 Wood Deck	2020	160	0 0	0	0	0 %	%
24 Frame Shed	0	80	0 0	0	0	0 %	%
111 CONC. SLAB	0	288	0 0	0	0	0 %	%
						%	%
						%	%
						%	%
						%	%
						%	%
						%	%
						%	%
						%	%

- 1.One Story Fram
- 2.Two Story Fram
- 3.Three Story Fr
- 4.1 & 1/2 Story
- 5.1 & 3/4 Story
- 6.2 & 1/2 Story
- 21.Open Frame Por
- 22.Encl Frame Por
- 23.Frame Garage
- 24.Frame Shed
- 25.Frame Bay Wind
- 26.1SFr Overhang
- 27.Unfin Basement
- 28.Unfinished Att
- 29.Finished Attic