

GIBERSON, CODY W
DEEVES, OLIVIA CATHERINE
544 NEW DAM ROAD
NORTH WATERBORO ME 04061

B11338P2 B15023P530 B16039P316 B16313P30 B16954P745

Previous Owner
WALKER CASSANDRA N
WALKER, NICHOLAS R
544 NEW DAM RD
N Waterboro Maine 04061
Sale Date: 11/10/2023

Previous Owner
GANNETT, DANIELLE L. & STUART B. III
ATTN: CASSANDRA & NICHOLAS WALKER
544 NEW DAM RD
N WATERBORO ME 04061 4686
Sale Date: 1/13/2015

Previous Owner
ROBERTS PEGGY S
C/O STUART & DANIELLE GANNETT
58 SOKOKIS TRL
E WATERBORO ME 04030
Sale Date: 5/01/2012

Inspection Witnessed By:

X	Date
No./Date	Description
	Date Insp.

Notes:
22.0824 added 24 x 36 three car garage -sb
23.1219 - updated SF Basment Living to 650 per real estate data from recent sale - vv

Waterboro

Property Data		
Neighborhood	1 LAC WEST	
Tree Growth Year	0	
1ST MORTGAGE	0	
2ND MORTGAGE	0	
Zone/Land Use	47 Lake Arrowhead	
Secondary Zone		
Topography	2 Rolling	
1.Level	4.Below St	7.Steep
2.Rolling	5.Low	8.Wet
3.Above St	6.Swampy	9.Lev/Roll
Utilities	9 No Water/No Sewer	
1.Public	4.Improve	7.Improve
2.Water	5.Improve	8.
3.Sewer	6.Improve	9.None
Street	1 Paved	
1.Paved	4.Proposed	7.ROW
2.Semi Imp	5.Pvt	8.None
3.Gravel	6.Aband	9.TG PLAN
LAND USE	0	
BUILDING USE	0	
Sale Data		
Sale Date	11/10/2023	
Price	375,000	
Sale Type	2 Land & Buildings	
1.Land	4.Mobile	7.
2.L & B	5.Other	8.
3.Building	6.	9.
Financing	9 Unknown	
1.Convent	4.Seller	7.
2.FHA/VA	5.Private	8.
3.Assumed	6.Cash	9.Unknown
Validity	1 Arms Length Sale	
1.Valid	4.Split	7.Renovate
2.Related	5.Partial	8.Other
3.Distress	6.Exempt	9.
Verified	5 Public Record	
1.Buyer	4.Agent	7.Family
2.Seller	5.Pub Rec	8.Other
3.Lender	6.MLS	9.

Assessment Record				
Year	Land	Buildings	Exempt	Total
2012	30,000	114,400	10,000	134,400
2013	30,000	114,400	0	144,400
2014	30,000	114,400	0	144,400
2015	30,000	114,400	0	144,400
2016	15,000	114,400	0	129,400
2017	15,000	114,400	0	129,400
2018	15,000	114,400	0	129,400
2019	15,000	114,400	0	129,400
2020	15,000	114,400	0	129,400
2021	16,500	114,400	0	130,900
2022	18,000	125,800	0	143,800
2023	19,800	163,000	0	182,800
2024	22,200	183,100	0	205,300
2025	30,000	265,100	0	295,100

Land Data						
Front Foot	Type	Effective		Influence		Influence Codes
		Frontage	Depth	Factor	Code	
11.Ossipee WF				%		1.Unimproved
12.Arrowhead WF				%		2.Excess Ftg /De
13.Waterfront				%		3.Topography
14.Rear Land				%		4.Size/Shape
15.Misc				%		5.Access or Rear
				%		6.Restriction
				%		7.Open Space
				%		8.View/Environ
				%		9.Fract Share
Square Foot	Square Feet					Acres
16.Regular Lot	16		1	100 %	0	30.Rear (201+)
17.Secondary Lot				%		31.Tillable/Horti
18.Excess Land				%		32.Pasture
19.Condominium				%		33.Orchard
20.Pavement				%		34.Frontage
				%		35.Triangular Lot
				%		36.Commercial
				%		37.Softwood
				%		38.Mixed Wood
				%		39.Hardwood
				%		40.Wasteland
				%		41.Gravel Pit (Ac
				%		42.Mobile Home Si
				%		43.Condo Site
				%		44.Utility ROW
				%		45.Camp Lot
				%		46.Site Improve
Total Acreage		0.00				

Waterboro

Map Lot 043-795

Account 4765

Location 544 NEW DAM ROAD

Card 1 Of 1 9/23/2024

Building Style	3 Raised Ranch			SF Bsmt Living	650			Layout	1 Typical		
1.Conv	5.Garr/Col	9.Other		Fin Bsmt Grade	3 120			1.Typical	4.	7.	
2.Ranch	6.Split	10.Mohome		OPEN 5 OPTIONAL	0			2.Inadeq	5.	8.	
3.R Ranch	7.Contemp/	11.Condo		Heat Type	100% 1 Hot Water BB			3.Not func	6.	9.	
4.Cape	8.Log	12.		1.HWBB	5.FWA	9.No Heat	Attic	0			
Dwelling Units 1				2.HWCI	6.GravWA	10.	1.1/4 Fin	4.Full Fin	7.1/4 Unfi		
Other Units 0				3.HWRAD	7.Electric	11.	2.1/2 Fin	5.FI/Stair	8.		
Stories 1 One Story				4.Steam	8.FI/WallM	12.	3.3/4 Fin	6.1/2 Unfi	9.None		
1.1	4.1.50	7.1.25		Cool Type	0% 9 None			Insulation	1 Full		
2.2	5.1.75	8.		1.Refrig	4.W&C Air	7.	1.Full	4.Minimal	7.		
3.3	6.2.50	9.		2.Evapor	5.	8.	2.Heavy	5.Unk	8.		
Exterior Walls 8 Alumunum/Vinyl				3.H Pump	6.	9.None	3.Capped	6.	9.None		
0.Wood	4.Asb/Asph	8.Alum/Vin		Kitchen Style	2 Typical			Unfinished %	0%		
1.Wood	5.T-111	9.Other		1.Modern	4.Obsolete	7.	Grade & Factor	3 Average 120%			
2.Wd Sh	6.Br/St	11.		2.Typical	5.	8.	1.E Grade	4.B Grade	7.AAA Grad		
3.Compos.	7.Nov	12.		3.Old Type	6.	9.None	2.D Grade	5.A Grade	8.		
Roof Surface 1 Asphalt Shingles				Bath(s) Style	2 Typical Bath(s)			3.C Grade	6.AA Grade	9.Same	
1.Asphalt	4.Composit	7.		1.Modern	4.Obsolete	7.	SQFT (Footprint)	828			
2.Slate	5.Wood	8.		2.Typical	5.	8.	Condition	7 Very Good			
3.Metal	6.Other	9.		3.Old Type	6.	9.None	1.Poor	4.Avg	7.V G		
SF Masonry Trim 0				# Rooms	6			2.Fair	5.Avg+	8.Exc	
OPEN-3- 0				# Bedrooms	3			3.Avg-	6.Good	9.Same	
OPEN-4- 0				# Full Baths	1			Phys. % Good	0%		
Year Built 2002				# Half Baths	0			Funct. % Good	100%		
Year Remodeled 0				# Addn Fixtures	0			Functional Code	9 None		
Foundation 1 Concrete				# Fireplaces	0			1.Incomp	4.Small	7.Layout	
1.Concrete	4.Wood	7.		<div style="display: flex; align-items: center; justify-content: center;"> <div style="background-color: #008080; color: white; padding: 10px 20px; font-size: 2em; margin-right: 10px;">T</div> <div style="font-size: 2em; font-weight: bold;">TRIO</div> </div>							
2.C Block	5.Slab	8.									
3.Br/Stone	6.Prs/Post	9.									
Basement 4 Full Basement											
1.1/4 Bmt	4.Full Bmt	7.									
2.1/2 Bmt	5.None	8.									
3.3/4 Bmt	6.	9.None									
Bsmt Gar # Cars 0											
Wet Basement 1 Dry Basement											
1.Dry	4.	7.									
2.Damp	5.	8.									
3.Wet	6.	9.									

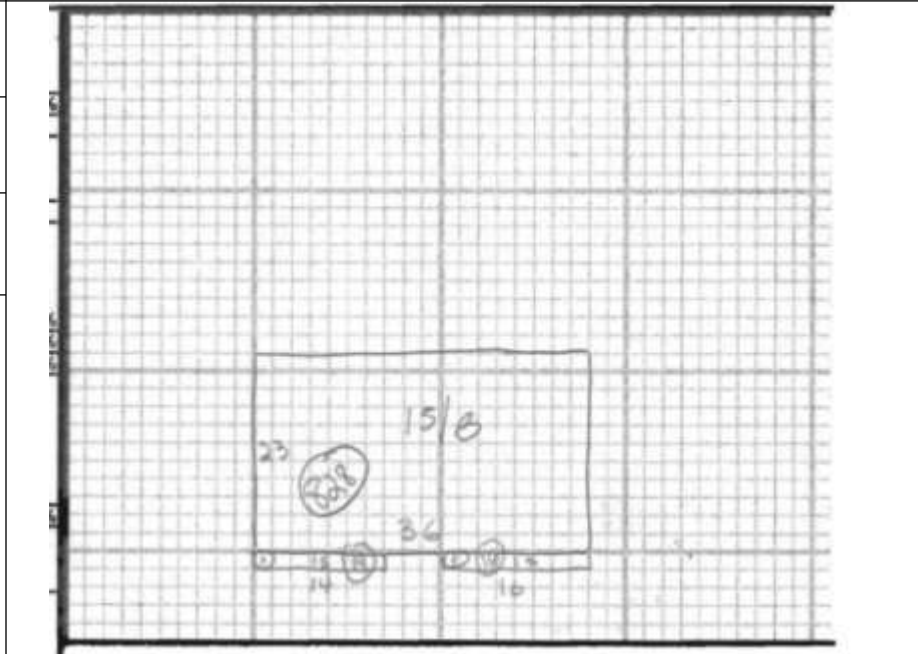

Date Inspected

Additions, Outbuildings & Improvements

Type	Year	Units	Grade	Cond	Phys.	Funct.	Sound Value	
26 1SFr Overhang	0	14	0 0	0	0	% 0	%	1.One Story Fram
26 1SFr Overhang	0	16	0 0	0	0	% 0	%	2.Two Story Fram
23 Frame Garage	2022	864	3 100	4	0	% 100	%	3.Three Story Fr
						%	%	4.1 & 1/2 Story
						%	%	5.1 & 3/4 Story
						%	%	6.2 & 1/2 Story
						%	%	21.Open Frame Por
						%	%	22.Encl Frame Por
						%	%	23.Frame Garage
						%	%	24.Frame Shed
						%	%	25.Frame Bay Wind
						%	%	26.1SFr Overhang
						%	%	27.Unfin Basement
						%	%	28.Unfinished Att
						%	%	29.Finished Attic