



# Waterboro

Map Lot 013-026B

Account 5198

Location 263 CLARKS BRIDGE ROAD

Card 1

Of 1

9/23/2024

Building Style	<b>2 Ranch</b>			SF Bsmt Living	<b>0</b>			Layout	<b>1 Typical</b>		
1.Conv	5.Garr/Col	9.Other		Fin Bsmt Grade	<b>0 0</b>			1.Typical	4.	7.	
2.Ranch	6.Split	10.Mohome		OPEN 5 OPTIONAL	<b>0</b>			2.Inadeq	5.	8.	
3.R Ranch	7.Contemp/	11.Condo		Heat Type	<b>100% 1 Hot Water BB</b>			3.Not func	6.	9.	
4.Cape	8.Log	12.		1.HWBB	5.FWA	9.No Heat		Attic	<b>9 None</b>		
Dwelling Units	<b>1</b>			2.HWCI	6.GravWA	10.		1.1/4 Fin	4.Full Fin	7.1/4 Unfi	
Other Units	<b>0</b>			3.HWRAD	7.Electric	11.		2.1/2 Fin	5.FI/Stair	8.	
Stories	<b>1 One Story</b>			4.Steam	8.FI/WallM	12.		3.3/4 Fin	6.1/2 Unfi	9.None	
1.1	4.1.50	7.1.25		Cool Type	<b>0% 9 None</b>			Insulation	<b>1 Full</b>		
2.2	5.1.75	8.		1.Refrig	4.W&C Air	7.		1.Full	4.Minimal	7.	
3.3	6.2.50	9.		2.Evapor	5.	8.		2.Heavy	5.Unk	8.	
Exterior Walls	<b>8 Aluminum/Vinyl</b>			3.H Pump	6.	9.None		3.Capped	6.	9.None	
0.Wood	4.Asb/Asph	8.Alum/Vin		Kitchen Style	<b>2 Typical</b>			Unfinished %	<b>0%</b>		
1.Wood	5.T-111	9.Other		1.Modern	4.Obsolete	7.		Grade & Factor	<b>4 Good 100%</b>		
2.Wd Sh	6.Br/St	11.		2.Typical	5.	8.		1.E Grade	4.B Grade	7.AAA Grad	
3.Compos.	7.Nov	12.		3.Old Type	6.	9.None		2.D Grade	5.A Grade	8.	
Roof Surface	<b>1 Asphalt Shingles</b>			Bath(s) Style	<b>2 Typical Bath(s)</b>			3.C Grade	6.AA Grade	9.Same	
1.Asphalt	4.Composit	7.		1.Modern	4.Obsolete	7.		SQFT (Footprint)	<b>1344</b>		
2.Slate	5.Wood	8.		2.Typical	5.	8.		Condition	<b>8 Excellent</b>		
3.Metal	6.Other	9.		3.Old Type	6.	9.None		1.Poor	4.Avg	7.V G	
SF Masonry Trim	<b>0</b>			# Rooms	<b>5</b>			2.Fair	5.Avg+	8.Exc	
OPEN-3-	<b>0</b>			# Bedrooms	<b>2</b>			3.Avg-	6.Good	9.Same	
OPEN-4-	<b>0</b>			# Full Baths	<b>2</b>			Phys. % Good	<b>0%</b>		
Year Built	<b>2018</b>			# Half Baths	<b>0</b>			Funct. % Good	<b>100%</b>		
Year Remodeled	<b>0</b>			# Addn Fixtures	<b>0</b>			Functional Code	<b>9 None</b>		
Foundation	<b>1 Concrete</b>			# Fireplaces	<b>0</b>			1.Incomp	4.Small	7.Layout	
1.Concrete	4.Wood	7.						2.O-Built	5.CDU	8.Other	
2.C Block	5.Slab	8.						3.Damage	6.Style	9.None	
3.Br/Stone	6.Prs/Post	9.						Econ. % Good	<b>100%</b>		
Basement	<b>4 Full Basement</b>							Economic Code	<b>None</b>		
1.1/4 Bmt	4.Full Bmt	7.						0.None	3.Services	7.	
2.1/2 Bmt	5.None	8.						1.Location	4.Traffic	8.	
3.3/4 Bmt	6.	9.None						2.Encroach	9.None	9.	
Bsmt Gar # Cars	<b>1</b>							Entrance Code	<b>0</b>		
Wet Basement	<b>1 Dry Basement</b>							1.Interior	4.Vacant	7.	
1.Dry	4.	7.						2.Refusal	5.Estimate	8.	
2.Damp	5.	8.						3.Informed	6.Office	9.RS	
3.Wet	6.	9.						Information Code	<b>0</b>		
								1.Owner	4.Agent	7.	
								2.Relative	5.Estimate	8.	
								3.Tenant	6.Other	9.SNY	

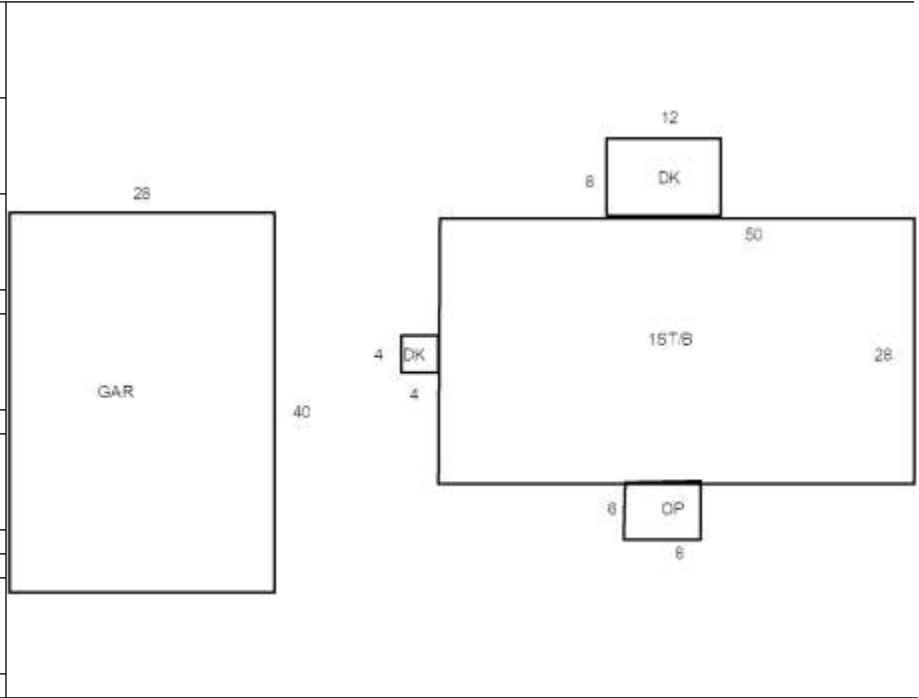

Date Inspected

**Additions, Outbuildings & Improvements**

Type	Year	Units	Grade	Cond	Phys.	Funct.	Sound Value	
23 Frame Garage	2018	1120	0 0	8	0 %	100 %		1.One Story Fram
21 Open Frame	0	720	0 0	0	0 %	100 %		2.Two Story Fram
68 Wood Deck	0	96	0 0	0	0 %	100 %		3.Three Story Fr
68 Wood Deck	0	48	0 0	0	0 %	100 %		4.1 & 1/2 Story
					%	%		5.1 & 3/4 Story
					%	%		6.2 & 1/2 Story
					%	%		21.Open Frame Por
					%	%		22.Encl Frame Por
					%	%		23.Frame Garage
					%	%		24.Frame Shed
					%	%		25.Frame Bay Wind
					%	%		26.1SFr Overhang
					%	%		27.Unfin Basement
					%	%		28.Unfinished Att
					%	%		29.Finished Attic