

LARIVIERE, SAMELIA
388 WEST ROAD
WATERBORO ME 04087

B16780P742 B17928P168 B17928P172 B18354P370

Previous Owner
REINCORP
468 MAIN STREET SUITE 300

SPRINGVALE ME 04083
Sale Date: 12/29/2020

Previous Owner
ZANTE REALTY LLC
PO BOX 205

OGUNQUIT ME 03907
Sale Date: 8/20/2020

Previous Owner
ZANTE REALTY LLC
PO BOX 205

OGUNQUIT ME 03907
Sale Date: 4/10/2019

Inspection Witnessed By:

X	Date
No./Date	Description
	Date Insp.

Notes:
21.0519 - changed from vacant lot to homesite, added 24x40
1st/b, 4x5 deck, 4x4 deck, 5x7 basement entry -sb
23.1220 - added 12x16 shed - vw

Property Data		
Neighborhood	63 WEST RD MID	
Tree Growth Year	0	
1ST MORTGAGE	0	
2ND MORTGAGE	0	
Zone/Land Use	31 Agricultural/Residential	
Secondary Zone		
Topography	2 Rolling	
1.Level	4.Below St	7.Steep
2.Rolling	5.Low	8.Wet
3.Above St	6.Swampy	9.Lev/Roll
Utilities	9 No Water/No Sewer	
1.Public	4.Improve	7.Improve
2.Water	5.Improve	8.
3.Sewer	6.Improve	9.None
Street	1 Paved	
1.Paved	4.Proposed	7.ROW
2.Semi Imp	5.Pvt	8.None
3.Gravel	6.Aband	9.TG PLAN
LAND USE	0	
BUILDING USE	0	
Sale Data		
Sale Date	12/29/2020	
Price	239,900	
Sale Type	1 Land Only	
1.Land	4.Mobile	7.
2.L & B	5.Other	8.
3.Building	6.	9.
Financing	9 Unknown	
1.Convent	4.Seller	7.
2.FHA/VA	5.Private	8.
3.Assumed	6.Cash	9.Unknown
Validity	1 Arms Length Sale	
1.Valid	4.Split	7.Renovate
2.Related	5.Partial	8.Other
3.Distress	6.Exempt	9.
Verified	5 Public Record	
1.Buyer	4.Agent	7.Family
2.Seller	5.Pub Rec	8.Other
3.Lender	6.MLS	9.

Assessment Record				
Year	Land	Buildings	Exempt	Total
2016	42,800	0	0	42,800
2017	42,800	0	0	42,800
2018	42,800	0	0	42,800
2019	42,800	0	0	42,800
2020	42,800	0	0	42,800
2021	47,000	0	0	47,000
2022	72,900	136,400	0	209,300
2023	80,100	151,300	0	231,400
2024	89,900	169,900	0	259,800
2025	109,900	245,300	0	355,200

Land Data						
Front Foot	Type	Effective		Influence		Influence Codes
		Frontage	Depth	Factor	Code	
11.Ossipee WF				%		1.Unimproved
12.Arrowhead WF				%		2.Excess Ftg /De
13.Waterfront				%		3.Topography
14.Rear Land				%		4.Size/Shape
15.Misc				%		5.Access or Rear
				%		6.Restriction
				%		7.Open Space
				%		8.View/Environ
				%		9.Fract Share
				%		Acres
				%		30.Rear (201+)
				%		31.Tillable/Horti
				%		32.Pasture
				%		33.Orchard
				%		34.Frontage
				%		35.Triangular Lot
				%		36.Commercial
21		2.00		100 %	0	37.Softwood
24		1.07		100 %	0	38.Mixed Wood
				%		39.Hardwood
				%		40.Wasteland
				%		41.Gravel Pit (Ac
				%		42.Mobile Home Si
				%		43.Condo Site
				%		44.Utility ROW
				%		45.Camp Lot
				%		46.Site Improve
Total Acreage		3.07				

Waterboro

Map Lot 003-044-003

Account 5079

Location 388 WEST ROAD

Card 1 Of 1 9/25/2024

Building Style 2 Ranch 1.Conv 5.Garr/Col 9.Other 2.Ranch 6.Split 10.Mohome 3.R Ranch 7.Contemp/ 11.Condo 4.Cape 8.Log 12. Dwelling Units 1 Other Units 0 Stories 1 One Story 1.1 4.1.50 7.1.25 2.2 5.1.75 8. 3.3 6.2.50 9. Exterior Walls 8 Aluminum/Vinyl 0.Wood 4.Asb/Asph 8.Alum/Vin 1.Wood 5.T-111 9.Other 2.Wd Sh 6.Br/St 11. 3.Compos. 7.Nov 12. Roof Surface 1 Asphalt Shingles 1.Asphalt 4.Composit 7. 2.Slate 5.Wood 8. 3.Metal 6.Other 9. SF Masonry Trim 0 OPEN-3- 0 OPEN-4- 0 Year Built 2020 Year Remodeled 0 Foundation 1 Concrete 1.Concrete 4.Wood 7. 2.C Block 5.Slab 8. 3.Br/Stone 6.Prs/Post 9. Basement 4 Full Basement 1.1/4 Bmt 4.Full Bmt 7. 2.1/2 Bmt 5.None 8. 3.3/4 Bmt 6. 9.None Bsmt Gar # Cars 0 Wet Basement 1 Dry Basement 1.Dry 4. 7. 2.Damp 5. 8. 3.Wet 6. 9.	SF Bsmt Living 0 Fin Bsmt Grade 0 0 OPEN 5 OPTIONAL 0 Heat Type 100% 1 Hot Water BB 1.HWBB 5.FWA 9.No Heat 2.HWCI 6.GravWA 10. 3.HWRAD 7.Electric 11. 4.Steam 8.F/WallM 12. Cool Type 0% 9 None 1.Refrig 4.W&C Air 7. 2.Evapor 5. 8. 3.H Pump 6. 9.None Kitchen Style 2 Typical 1.Modern 4.Obsolete 7. 2.Typical 5. 8. 3.Old Type 6. 9.None Bath(s) Style 2 Typical Bath(s) 1.Modern 4.Obsolete 7. 2.Typical 5. 8. 3.Old Type 6. 9.None # Rooms 5 # Bedrooms 3 # Full Baths 1 # Half Baths 0 # Addn Fixtures 0 # Fireplaces 0	Layout 1 Typical 1.Typical 4. 7. 2.Inadeq 5. 8. 3.Not func 6. 9. Attic 9 None 1.1/4 Fin 4.Full Fin 7.1/4 Unfi 2.1/2 Fin 5.FI/Stair 8. 3.3/4 Fin 6.1/2 Unfi 9.None Insulation 1 Full 1.Full 4.Minimal 7. 2.Heavy 5.Unk 8. 3.Capped 6. 9.None Unfinished % 0% Grade & Factor 4 Good 100% 1.E Grade 4.B Grade 7.AAA Grad 2.D Grade 5.A Grade 8. 3.C Grade 6.AA Grade 9.Same SQFT (Footprint) 960 Condition 4 Average 1.Poor 4.Avg 7.V G 2.Fair 5.Avg+ 8.Exc 3.Avg- 6.Good 9.Same Phys. % Good 0% Funct. % Good 100% Functional Code 9 None 1.Incomp 4.Small 7.Layout 2.O-Built 5.CDU 8.Other 3.Damage 6.Style 9.None Econ. % Good 100% Economic Code None 0.None 3.Services 7. 1.Location 4.Traffic 8. 2.Encroach 9.None 9. Entrance Code 0 1.Interior 4.Vacant 7. 2.Refusal 5.Estimate 8. 3.Informed 6.Office 9.RS Information Code 0 1.Owner 4.Agent 7. 2.Relative 5.Estimate 8. 3.Tenant 6.Other 9.SNY
--	---	--

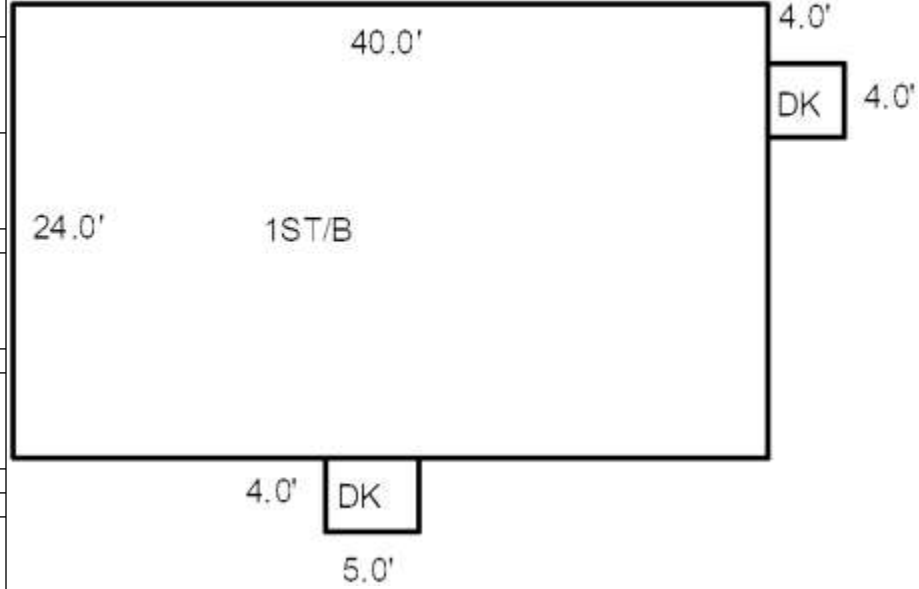

Date Inspected

Additions, Outbuildings & Improvements

Type	Year	Units	Grade	Cond	Phys.	Funct.	Sound Value	
68 Wood Deck	0	20	0 0	0	0	0	%	1.One Story Fram
68 Wood Deck	0	16	0 0	0	0	0	%	2.Two Story Fram
90 BSMT ENTRY	0	35	0 0	0	0	0	%	3.Three Story Fr
24 Frame Shed	2023	192	0 0	0	0	0	%	4.1 & 1/2 Story
							%	5.1 & 3/4 Story
							%	6.2 & 1/2 Story
							%	21.Open Frame Por
							%	22.Encl Frame Por
							%	23.Frame Garage
							%	24.Frame Shed
							%	25.Frame Bay Wind
							%	26.1SFr Overhang
							%	27.Unfin Basement
							%	28.Unfinished Att
							%	29.Finished Attic