

GREEN CHRISTIAN T
PO BOX 508
WATERBORO ME 04087

B14093P34 B15872P970

Previous Owner
CARLOCK STEVEN AND CYNTHIA
C/O CHRISTIAN T GREEN
PO BOX 508
WATERBORO ME 04087
Sale Date: 5/28/2010

Inspection Witnessed By:

X		Date
No./Date	Description	Date Insp.

Notes:

Waterboro

Property Data			Assessment Record						
Neighborhood 62 SAND CROSSING RD			Year	Land	Buildings	Exempt	Total		
Tree Growth Year 0			2012	68,400	136,100	0	204,500		
1ST MORTGAGE 0			2013	68,400	136,100	0	204,500		
2ND MORTGAGE 0			2014	68,400	136,100	0	204,500		
Zone/Land Use 11 Residential			2015	68,400	136,100	0	204,500		
Secondary Zone			2016	57,600	134,700	0	192,300		
Topography 2 Rolling			2017	57,600	134,700	0	192,300		
1.Level 4.Below St 7.Steep			2018	57,600	134,700	0	192,300		
2.Rolling 5.Low 8.Wet			2019	57,600	134,700	0	192,300		
3.Above St 6.Swampy 9.Lev/Roll			2020	57,600	136,300	0	193,900		
Utilities 9 No Water/No Sewer			2021	63,300	136,300	0	199,600		
1.Public 4.Improve 7.Improve			2022	69,100	149,900	0	219,000		
2.Water 5.Improve 8.			2023	76,000	166,300	0	242,300		
3.Sewer 6.Improve 9.None			2024	85,200	186,700	0	271,900		
Street 3 Gravel			2025	93,600	254,300	0	347,900		
1.Paved 4.Proposed 7.ROW			Land Data						
2.Semi Imp 5.Pvt 8.None									
3.Gravel 6.Aband 9.TG PLAN			Front Foot	Type	Effective		Influence		Influence Codes
LAND USE 0			11.Ossipee WF		Frontage	Depth	Factor	Code	
BUILDING USE 0			12.Arrowhead WF				%		1.Unimproved
Sale Data			13.Waterfront				%		2.Excess Ftg /De
Sale Date 5/28/2010			14.Rear Land				%		3.Topography
Price 187,000			15.Misc				%		4.Size/Shape
Sale Type 2 Land & Buildings							%		5.Access or Rear
1.Land 4.Mobile 7.							%		6.Restriction
2.L & B 5.Other 8.			Square Foot	Square Feet					7.Open Space
3.Building 6. 9.			16.Regular Lot				%		8.View/Environ
Financing 1 Conventional			17.Secondary Lot				%		9.Fract Share
1.Convent 4.Seller 7.			18.Excess Land				%		Acres
2.FHA/VA 5.Private 8.			19.Condominium				%		30.Rear (201+)
3.Assumed 6.Cash 9.Unknown			20.Pavement				%		31.Tillable/Horti
Validity 1 Arms Length Sale							%		32.Pasture
1.Valid 4.Split 7.Renovate			Fract. Acre	Acreege/Sites					33.Orchard
2.Related 5.Partial 8.Other			21.Homesite (Frac	21	1.00	100	%	0	34.Frontage
3.Distress 6.Exempt 9.			22.Vacant Lot (Fr	26	1.00	100	%	0	35.Triangular Lot
Verified 1 Buyer			23.Non Conforming				%		36.Commercial
1.Buyer 4.Agent 7.Family			Acres				%		37.Softwood
2.Seller 5.Pub Rec 8.Other			24.Excess (5-10)				%		38.Mixed Wood
3.Lender 6.MLS 9.			25.Excess (10+)				%		39.Hardwood
			26.Excess				%		40.Wasteland
			27.Rear (1-100)				%		41.Gravel Pit (Ac
			28.Rear (101-150)				%		42.Mobile Home Si
			29.Rear (151-200)				%		43.Condo Site
			Total Acreage		2.00				44.Utility ROW
									45.Camp Lot
									46.Site Improve

Waterboro

Map Lot 001-023-006

Account 37

Location 13 GERRY LANE

Card 1

Of 1

9/25/2024

Building Style	2 Ranch			SF Bsmt Living	840	Layout	1 Typical			
1.Conv	5.Garr/Col	9.Other		Fin Bsmt Grade	3 100	1.Typical	4.	7.		
2.Ranch	6.Split	10.Mohome		OPEN 5 OPTIONAL	0	2.Inadeq	5.	8.		
3.R Ranch	7.Contemp/	11.Condo		Heat Type	100% 1 Hot Water BB	3.Not func	6.	9.		
4.Cape	8.Log	12.		1.HWBB	5.FWA	9.No Heat				
Dwelling Units	1			2.HWCI	6.GravWA	10.				
Other Units	0			3.HWRAD	7.Electric	11.				
Stories	1 One Story			4.Steam	8.F/WallM	12.				
1.1	4.1.50	7.1.25		Cool Type	0% 9 None			Attic	9 None	
2.2	5.1.75	8.		1.Refrig	4.W&C Air	7.		1.1/4 Fin	4.Full Fin	7.1/4 Unfi
3.3	6.2.50	9.		2.Evapor	5.	8.		2.1/2 Fin	5.FI/Stair	8.
Exterior Walls	1 Wood Siding			3.H Pump	6.	9.None		3.3/4 Fin	6.1/2 Unfi	9.None
0.Wood	4.Asb/Asph	8.Alum/Vin		Kitchen Style	2 Typical			Insulation	1 Full	
1.Wood	5.T-111	9.Other		1.Modern	4.Obsolete	7.		1.Full	4.Minimal	7.
2.Wd Sh	6.Br/St	11.		2.Typical	5.	8.		2.Heavy	5.Unk	8.
3.Compos.	7.Nov	12.		3.Old Type	6.	9.None		3.Capped	6.	9.None
Roof Surface	1 Asphalt Shingles			Bath(s) Style	2 Typical Bath(s)			Unfinished %	0%	
1.Asphalt	4.Composit	7.		1.Modern	4.Obsolete	7.		Grade & Factor	3 Average 110%	
2.Slate	5.Wood	8.		2.Typical	5.	8.		1.E Grade	4.B Grade	7.AAA Grad
3.Metal	6.Other	9.		3.Old Type	6.	9.None		2.D Grade	5.A Grade	8.
SF Masonry Trim	0			# Rooms	5			3.C Grade	6.AA Grade	9.Same
OPEN-3-	0			# Bedrooms	3			SQFT (Footprint)	1120	
OPEN-4-	0			# Full Baths	1			Condition	7 Very Good	
Year Built	1995			# Half Baths	0			1.Poor	4.Avg	7.V G
Year Remodeled	0			# Addn Fixtures	0			2.Fair	5.Avg+	8.Exc
Foundation	1 Concrete			# Fireplaces	0			3.Avg-	6.Good	9.Same
1.Concrete	4.Wood	7.						Phys. % Good	0%	
2.C Block	5.Slab	8.						Funct. % Good	100%	
3.Br/Stone	6.Prs/Post	9.						Functional Code	9 None	
Basement	4 Full Basement							1.Incomp	4.Small	7.Layout
1.1/4 Bmt	4.Full Bmt	7.						2.O-Built	5.CDU	8.Other
2.1/2 Bmt	5.None	8.						3.Damage	6.Style	9.None
3.3/4 Bmt	6.	9.None						Econ. % Good	100%	
Bsmt Gar # Cars	0							Economic Code	None	
Wet Basement	1 Dry Basement							0.None	3.Services	7.
1.Dry	4.	7.						1.Location	4.Traffic	8.
2.Damp	5.	8.						2.Encroach	9.None	9.
3.Wet	6.	9.						Entrance Code	0	
								1.Interior	4.Vacant	7.
								2.Refusal	5.Estimate	8.
								3.Informed	6.Office	9.RS
								Information Code	0	
								1.Owner	4.Agent	7.
								2.Relative	5.Estimate	8.
								3.Tenant	6.Other	9.SNY

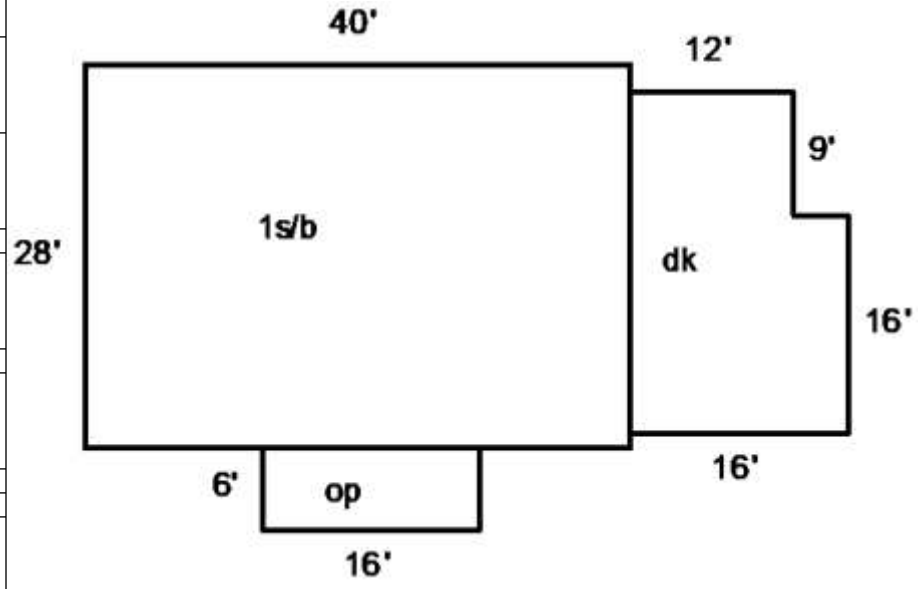

Date Inspected

Additions, Outbuildings & Improvements

Type	Year	Units	Grade	Cond	Phys.	Funct.	Sound Value	
21 Open Frame	1995	96	0 0	0	0	% 0	%	1.One Story Fram
68 Wood Deck	0	364	0 0	0	0	% 0	%	2.Two Story Fram
						%	%	3.Three Story Fr
						%	%	4.1 & 1/2 Story
						%	%	5.1 & 3/4 Story
						%	%	6.2 & 1/2 Story
						%	%	21.Open Frame Por
						%	%	22.Encl Frame Por
						%	%	23.Frame Garage
						%	%	24.Frame Shed
						%	%	25.Frame Bay Wind
						%	%	26.1SFr Overhang
						%	%	27.Unfin Basement
						%	%	28.Unfinished Att
						%	%	29.Finished Attic

