

053-008

CHARETTE NORMAN R & JOAN E
19 EVERGREEN DRIVE
B 4564 P 2

PROPERTY DATA

NEIGHBORHOOD CODE 38

STREET CODE

LAND USE

11. Residential
21. Village
22. Village/Res.
31. Agricultural/Res.
33. Forest/Agri.
40. Conservation
45. General Purpose
48. Shoreland
49. Resource Protection
3L

SECONDARY ZONE

TOPOGRAPHY

1. Level 5. Low
2. Rolling 6. Swampy
3. Above St. 7. Steep
4. Below St. 8.
2

UTILITIES
1. All Public 5. Dug Well
2. Public Water 6. Septic
3. Public Sewer 7. Cess Pool
4. Drilled Well 9. No Utilities
9

STREET
1. Paved 4. Proposed
2. Semi-Improved
3. Gravel 9. No Street
1

SALE DATA

DATE(MM/YY) - - / - -

PRICE - - - - - / - - - - -

SALE TYPE
1. Land 4. Mobile
2. Land & Bldg. Home
3. Building Only 5. Other

FINANCING
1. Conv. 5. Private
2. FHA/VA 6. Cash
3. Assumed 7. FMHA
4. Seller 9. Unknown

VERIFIED
1. Buyer 6. MLS
2. Seller 7. Family
3. Lender 8. Other
4. Agent 9. Confid.
5. Record

VALIDITY
1. Valid 5. Partial
2. Related 6. Exempt
3. Distress 7. Changed
4. Split 8. Other

BOOK PAGE DATE CONSIDERATION

Table with 4 columns: BOOK, PAGE, DATE, CONSIDERATION. All fields are currently empty.

ASSESSMENT RECORD

Table with 5 columns: YEAR, LAND, BUILDINGS, EXEMPT, TOTAL. Row 1: 02, 22900, 52500, (blank), 75400.

LAND DATA

Table with columns: FRONT FOOT, SQUARE FOOT, FRACT. ACRE, ACRES, TYPE, EFFECTIVE (Frontage, Depth), INFLUENCE (Factor, Code), INFLUENCE CODES. Includes list of codes and a total of 4.28 acres.

Table with 3 columns: No./Date, Description, Date Insp. All fields are empty.

NOTES:

Table with 3 columns: No./Date, Description, Date Insp. All fields are empty.

TOWN OF WATERBORO, MAINE

MAP **53** LOT **8** ACCOUNT NO. ADDRESS CARD NO. OF

BUILDING STYLE		S/F BSMT LIVING		INSULATION		
1. Conv. 6. Split Lev.	2	FIN BSMT GRADE	0	1. Full 4. Minimal	1	
2. Ranch 7. Contemp.				2. Heavy 9. None		
3. R. Ranch 6. Log				3. Capped		
4. Cape 9. Other				UNFINISHED %		
5. Garrison				GRADE & FACTOR		110 %
DWELLING UNITS		HEAT TYPE	1	1. E 4. B	3	
OTHER UNITS		1. HW BB 6. Grav. WA		2. D 5. A		
STORIES	1	2. HW CI 7. Electric		3. C 6. AA		
1. One 4. 1 1/2		3. HW Radiant 8. Units		SQ. FOOTAGE		0960
2. Two 5. 1 3/4		4. Steam 9. No Heat		CONDITION		5
3. Three 6. 2 1/2		COOL TYPE	9 %	1. Poor 5. Avg +	9	
EXTERIOR WALLS	8	1. Central 9. None		2. Fair 6. Good		
1. Clapboard 6. BR./Stone		KITCHEN STYLE	2	3. Avg - 7. V Good		
2. WD.SH. 7. Novelty		1. Good 3. Old Style		4. Avg. 8. Exc. %		
3. Comp. 8. AL/Vinyl		2. Typical 4. Obsolete		PHYS. % GOOD		%
4. ASB/ASP 9. Other		BATH(S) STYLE	2	FUNCT. % GOOD	%	
5. T1-11		1. Good 3. Old Style		FUNCT. CODE		
ROOF SURFACE	1	2. Typical 4. Obsolete		1. Incomp. 5. CDU	9	
1. Asphalt 4. Comp.		# ROOMS	3	2. Overbuilt 6. Style		
2. Slate 5. Wood		# BEDROOMS		3. Delap. 7. Layout		
3. Metal 6. Other		# FULL BATHS		4. Small Size 8. Other		
S/F MASONRY TRIM		# HALF BATHS		9. None		
YEAR BUILT	1987	# ADDN FIXTURES		ECON. % GOOD	%	
YEAR REMODELED		# FIREPLACES		ECON. CODE	9	
FOUNDATION	1	# HEARTHES		1. Location 3. Services	5	
1. Conc. 4. Wood		LAYOUT	1	2. Encroach 9. None		
2. C Blk 5. Slab		1. Typical 2. In adeg.		ENTRANCE CODE		
3. Br./Stone 6. Piers		ATTIC	9	1. Inspct. 3. Vacant		
BASEMENT	4	1. 1/4 Fin 4. Full Fin.		2. Refused 5. Estim.		
1. 1/4 3. 3/4 5. Crawl		2. 1/2 Fin. 5. Fl/Stairs		3. Info Only		
2. 1/2 4. Full 6. None		3. 3/4 Fin. 9. None		INFO. CODE	5	
BSMT GAR # CARS	0	INT COMP TO EXIT + = -		1. Owner 4. Agent	5	
WET BASEMENT	1	INSPECTED BY	DK	2. Relative 5. Estimate		
1. Dry 3. Wet		DATE INSPECTED	9-30-05	3. Tenant 6. Other		
2. Damp 9. None				2. Refused 5. Estim.		

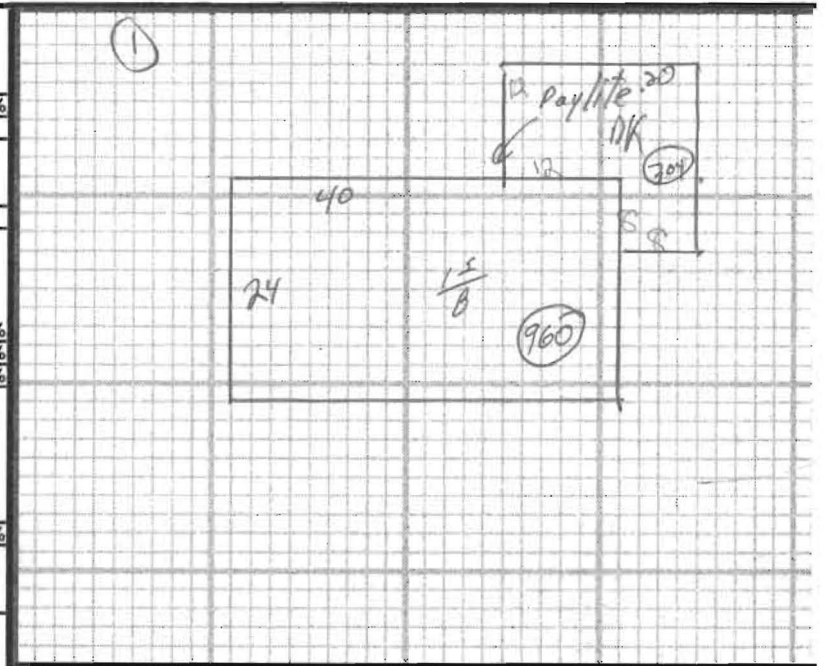

ADDITIONS, OUTBUILDINGS & IMPROVEMENTS						PERCENT GOOD		CODES
TYPE	YEAR	UNITS	GRADE	COND	Phys.	Funct.		
12	001	1987	0960					1. 1S Fr.
DK	068		0304					2. 2S Fr.
								3. 3S Fr.
								4. 1 1/2S Fr.
								5. 1 3/4S Fr.
								6. 2 1/2S Fr.
								Add 10 for Bsmt
								21. OFP
								22. EFP
								23. Garage
								24. Shed
								25. Bay Window
								26. Overhang
								27. Unf. Bsmt
								28. Unf. Attic
								29. Fin. Attic
								Add 20 for 2 Story
								61. Carport
								62. Patio
								63. Swimming Pool
								64. Tennis Court
								65. Stable w/loft
								66. Greenhouse
								67. Natatorium
								68. Wood Deck
								69. Jacuzzi

PHOTO

NOTES: