

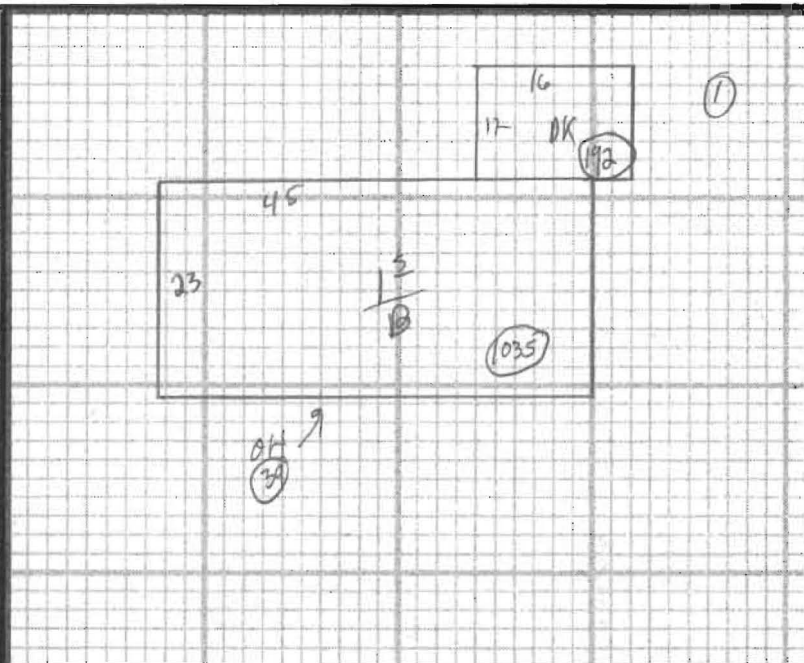

MAP 49 LOT 2A ACCOUNT NO. 4013 BUILDING RECORD ADDRESS CARD NO. OF

<b>BUILDING STYLE</b> 1. Conv. 6. Split Lev. 2. Ranch 7. Contemp. 3. R. Ranch 8. Log 4. Cape 9. Other 5. Garrison	3	<b>S/F BSMT LIVING</b>	3	<b>INSULATION</b> 1. Full 4. Minimal 2. Heavy 9. None 3. Capped	1
<b>DWELLING UNITS</b>		<b>FIN BSMT GRADE</b>	100	<b>UNFINISHED %</b>	
<b>OTHER UNITS</b>		<b>HEAT TYPE</b> 1. HW BB 6. Grav. WA 2. HW CI 7. Electric 3. HW Radiant 8. Units 4. Steam 9. No Heat 5. FWA	8	<b>GRADE &amp; FACTOR</b> 1. E 4. B 2. D 5. A 3. C 6. AA	3
<b>STORIES</b> 1. One 4. 1 1/2 2. Two 5. 1 3/4 3. Three 6. 2 1/2	1	<b>COOL TYPE</b> 1. Central 9. None	9	<b>SQ. FOOTAGE</b>	1035
<b>EXTERIOR WALLS</b> 1. Clapboard 6. BR./Stone 2. WD.SH. 7. Novelty 3. Comp. 8. AL/Vinyl 4. ASB/ASP 9. Other 5. T1-11	1	<b>KITCHEN STYLE</b> 1. Good 3. Old Style 2. Typical 4. Obsolete	2	<b>CONDITION</b> 1. Poor 5. Avg + 2. Fair 6. Good 3. Avg - 7. V Good 4. Avg. 8. Exc.	5
<b>ROOF SURFACE</b> 1. Asphalt 4. Comp. 2. Slate 5. Wood 3. Metal 6. Other	1	<b>BATH(S) STYLE</b> 1. Good 3. Old Style 2. Typical 4. Obsolete	2	<b>PHYS. % GOOD</b>	%
<b>S/F MASONRY TRIM</b>		<b># ROOMS</b>	7	<b>FUNCT. % GOOD</b>	%
<b>YEAR BUILT</b>	1972	<b># BEDROOMS</b>	7	<b>FUNCT. CODE</b> 1. Incomp. 5. CDU 2. Overbuilt 6. Style 3. Delap. 7. Layout 4. Small Size 8. Other 9. None	9
<b>YEAR REMODELED</b>		<b># FULL BATHS</b>		<b>ECON. % GOOD</b>	%
<b>FOUNDATION</b> 1. Conc. 4. Wood 2. C Blk 5. Stab 3. Br./Stone 6. Piers	1	<b># HALF BATHS</b>		<b>ECON. CODE</b> 1. Location 3. Services 2. Encroach 9. None	9
<b>BASEMENT</b> 1. 1/4 3. 3/4 5. Crawl 2. 1/2 4. Full 6. None	4	<b># ADDN FIXTURES</b>		<b>ENTRANCE CODE</b> 1. Inspct. 3. Vacant 2. Refused 5. Estim. 3. Info Only	5
<b>BSMT GAR # CARS</b>	0	<b># FIREPLACES</b>		<b>INFO. CODE</b> 1. Owner 4. Agent 2. Relative 5. Estimate 3. Tenant 6. Other 2. Refused 5. Estim.	5
<b>WET BASEMENT</b> 1. Dry 3. Wet 2. Damp 9. None	1	<b># HEARTHES</b>			
		<b>LAYOUT</b> 1. Typical 2. In adeq.	1		
		<b>ATTIC</b> 1. 1/4 Fin 4. Full Fin. 2. 1/2 Fin. 5. Fl/Stairs 3. 3/4 Fin. 9. None	9		
		<b>INT COMP TO EXIT + - -</b>			
		<b>INSPECTED BY</b>	BAK		
		<b>DATE INSPECTED</b>	11-18-05		



ADDITIONS, OUTBUILDINGS & IMPROVEMENTS						PERCENT GOOD		CODES
TYPE	YEAR	UNITS	GRADE	COND	Phys.	Funct.		
12	1972	1035			%	%	1. 1S Fr.	
DK	68	192			%	%	2. 2S Fr.	
OH	26	34			%	%	3. 3S Fr.	
					%	%	4. 1 1/2S Fr.	
					%	%	5. 1 3/4S Fr.	
					%	%	6. 2 1/2S Fr.	
					%	%	Add 10 for Bsmt	
					%	%	21. OFP	
					%	%	22. EFP	
					%	%	23. Garage	
					%	%	24. Shed	
					%	%	25. Bay Window	
					%	%	26. Overhang	
					%	%	27. Unf. Bsmt	
					%	%	28. Unf. Attic	
					%	%	29. Fin. Attic	
					%	%	Add 20 for 2 Story	
					%	%	61. Carport	
					%	%	62. Patio	
					%	%	63. Swimming Pool	
					%	%	64. Tennis Court	
					%	%	65. Stable w/lot	
					%	%	66. Greenhouse	
					%	%	67. Natatorium	
					%	%	68. Wood Deck	
					%	%	69. Jacuzzi	

PHOTO

NOTES: