

047-039

DUDLEY CHRISTOPHER D & STACEY EB
214 LAKE SHERBURNE ROAD
B 8760 P 345

047-039

STOMSKI MARK, JOHN & IRENE
214 LAKE SHERBURNE ROAD
05/11/2006 \$185,000

PROPERTY DATA	
NEIGHBORHOOD CODE	___
STREET CODE	___
LAND USE	48
11. Residential 21. Village 22. Village/Res. 31. Agricultural/Res. 33. Forest/Agri. 40. Conservation 45. General Purpose 48. Shoreland 49. Resource Protection	
SECONDARY ZONE	___
TOPOGRAPHY	71
1. Level 2. Rolling 3. Above St. 4. Below St.	
5. Low 6. Swampy 7. Steep 8.	
UTILITIES	___
1. All Public 2. Public Water 3. Public Sewer 4. Drilled Well	
5. Dug Well 6. Septic 7. Cess Pool 9. No Utilities	
STREET	3
1. Paved 2. Semi-Improved 3. Gravel	
4. Proposed 9. No Street	
SALE DATA	
DATE(MM/YY)	___/___/___
PRICE	___,___,___
SALE TYPE	___
1. Land 2. Land & Bldg. 3. Building Only	
4. Mobile Home 5. Other	
FINANCING	___
1. Conv. 2. FHA/VA 3. Assumed 4. Seller	
5. Private 6. Cash 7. FMHA 9. Unknown	
VERIFIED	___
1. Buyer 2. Seller 3. Lender 4. Agent 5. Record	
6. MLS 7. Family 8. Other 9. Confid.	
VALIDITY	___
1. Valid 2. Related 3. Distress 4. Split	
5. Partial 6. Exempt 7. Changed 8. Other	

BOOK	PAGE	DATE	CONSIDERATION

ASSESSMENT RECORD				
YEAR	LAND	BUILDINGS	EXEMPT	TOTAL
02	39 100	70 900		110 000

LAND DATA						
FRONT FOOT	TYPE	EFFECTIVE		INFLUENCE		INFLUENCE CODES
		Frontage	Depth	Factor	Code	
11. Regular Lot				---	%	1=Vacancy
12. Delta Triangle				---	%	2=Excess Frontage
13. Nabla Triangle				---	%	3=Topography
14. Rear Land				---	%	4=Size/Shape
15.				---	%	5=Access
				---	%	6=Restrictions
				---	%	7=Corner
				---	%	8=Environment
				---	%	9=Fractional Share
SQUARE FOOT		SQUARE FEET				
16. Regular Lot				---	%	
17. Secondary				---	%	
18. Excess Land				---	%	
19. Condo.				---	%	
20.				---	%	
FRACT. ACRE		ACREAGE/SITES				
21. Homesite				---	%	
22. Baselot				---	%	
23.				---	%	
ACRES						
24. Homesite				---	%	
25. Baselot				---	%	
26. Secondary				---	%	
27. Frontage				---	%	
28. Rear 1				---	%	
29. Rear 2				---	%	
30. Rear 3				---	%	
31. Tillable				---	%	
32. Pasture				---	%	
33. Orchard				---	%	
Total				---	%	

No./Date	Description	Date Insp.

NOTES:

- ACRES (cont.)
34. Softwood (F&O)
35. Mixed Wood (F&O)
36. Hardwood (F&O)
37. Softwood (T.G.)
38. Mixed Wood (T.G.)
39. Hardwood (T.G.)
40. Waste
41. Gravel Pit
- SITE
42. Moho Site
43. Condo Site
44. Lot Improvements

70
-10

MAP 47 LOT 39 ACCOUNT NO. 3826 BUILDING RECORD ADDRESS CARD NO. OF

BUILDING STYLE 1. Conv. 6. Split Lev. 2. Ranch 7. Contemp. 3. R. Ranch 8. Log 4. Cape 9. Other 5. Garrison	<u>2</u>	S/F BSMT LIVING		INSULATION 1. Full 4. Minimal 2. Heavy 9. None 3. Capped	<u>1</u>
DWELLING UNITS		FIN BSMT GRADE		UNFINISHED %	<u>3</u>
OTHER UNITS		HEAT TYPE 1. HW BB 6. Grav. WA 2. HW CI 7. Electric 3. HW Radiant 8. Units 4. Steam 9. No Heat 5. FWA	<u>8</u>	GRADE & FACTOR 1. E 4. B 2. D 5. A 3. C 6. AA	<u>3</u>
STORIES 1. One 4. 1 1/2 2. Two 5. 1 3/4 3. Three 6. 2 1/2	<u>1</u>	COOL TYPE 1. Central 9. None	<u>9</u>	SQ. FOOTAGE	<u>816</u>
EXTERIOR WALLS 1. Clapboard 6. BR/Stone 2. WD.SH. 7. Novelty 3. Comp. 8. AL/Vinyl 4. ASB/ASP 9. Other 5. T1-11	<u>8</u>	KITCHEN STYLE 1. Good 3. Old Style 2. Typical 4. Obsolete	<u>2</u>	CONDITION 1. Poor 5. Avg + 2. Fair 6. Good 3. Avg - 7. V Good 4. Avg. 8. Exc.	<u>4</u>
ROOF SURFACE 1. Asphalt 4. Comp. 2. Slate 5. Wood 3. Metal 6. Other	<u>1</u>	BATH(S) STYLE 1. Good 3. Old Style 2. Typical 4. Obsolete	<u>2</u>	PHYS. % GOOD	<u>9</u>
S/F MASONRY TRIM	<u>1988</u>	# ROOMS	<u>7</u>	FUNCT. % GOOD	<u>9</u>
YEAR BUILT		# BEDROOMS	<u>1</u>	FUNCT. CODE 1. Incomp. 5. CDU 2. Overbuilt 6. Style 3. Delap. 7. Layout 4. Small Size 8. Other 9. None	<u>9</u>
YEAR REMODELED		# FULL BATHS	<u>1</u>	ECON. % GOOD	<u>9</u>
FOUNDATION 1. Conc. 4. Wood 2. C Blk 5. Slab 3. Br./Stone 6. Piers	<u>1</u>	# HALF BATHS	<u>2</u>	ECON. CODE 1. Location 3. Services 2. Encroach 9. None	<u>5</u>
BASEMENT 1. 1/4 3. 3/4 5. Crawl 2. 1/2 4. Full 6. None	<u>4</u>	# ADDN FIXTURES		ENTRANCE CODE 1. Inspct, 3. Vacant 2. Refused 5. Estim. 3. Info Only	<u>5</u>
BSMT GAR # CARS	<u>0</u>	# FIREPLACES		INFO. CODE 1. Owner 4. Agent 2. Relative 5. Estimate 3. Tenant 6. Other 2. Refused 5. Estim.	<u>5</u>
WET BASEMENT 1. Dry 3. Wet 2. Damp 9. None	<u>1</u>	# HEARTHES			
		LAYOUT 1. Typical 2. In adeq.	<u>1</u>		
		ATTIC 1. 1/4 Fin 4. Full Fin. 2. 1/2 Fin. 5. FV/Stairs 3. 3/4 Fin. 9. None	<u>2</u>		
		INT COMP TO EXIT + = -			
		INSPECTED BY	<u>RAK</u>		
		DATE INSPECTED	<u>1-16-06</u>		

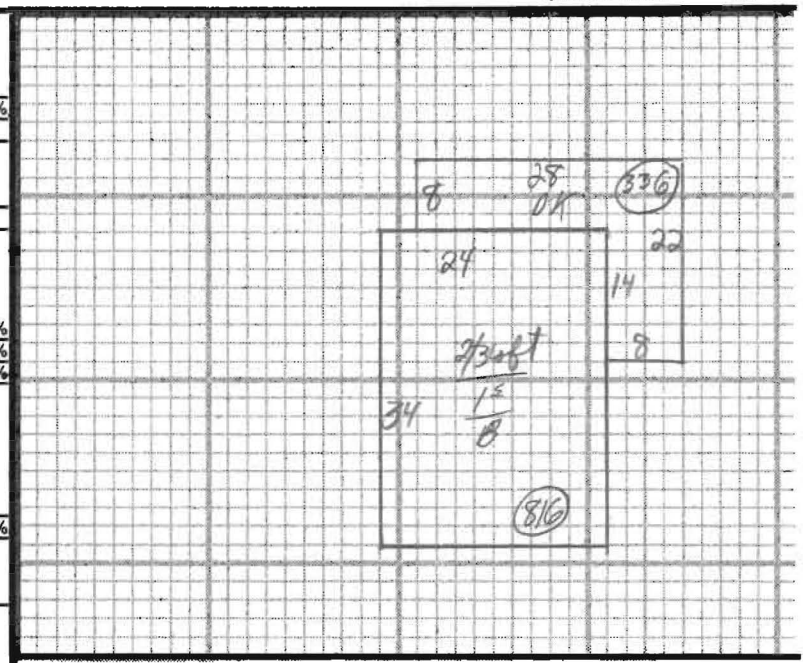

ADDITIONS, OUTBUILDINGS & IMPROVEMENTS						PERCENT GOOD		CODES
TYPE	YEAR	UNITS	GRADE	COND	Phys.	Funct.		
<u>1</u>	<u>1988</u>	<u>816</u>			<u>---</u>	<u>---</u>	1. 1S Fr.	
<u>AK</u>	<u>68</u>	<u>336</u>			<u>---</u>	<u>---</u>	2. 2S Fr.	
							3. 3S Fr.	
							4. 1 1/2S Fr.	
							5. 1 3/4S Fr.	
							6. 2 1/2S Fr.	
							Add 10 for Bsmt	
							21. OFF	
							22. EFP	
							23. Garage	
							24. Shed	
							25. Bay Window	
							26. Overhang	
							27. Unf. Bsmt	
							28. Unf. Attic	
							29. Fin. Attic	
							Add 20 for 2 Story	
							61. Carport	
							62. Patio	
							63. Swimming Pool	
							64. Tennis Court	
							65. Stable w/lot	
							66. Greenhouse	
							67. Natatorium	
							68. Wood Deck	
							69. Jacuzzi	

NOTES:

PHOTO