

MAP LOT

ACCOUNT NO. 03664 ADDRESS

TOWN OF WATERBORO, MAINE

CARD NO. OF

046-002-111

CLAUSSEN KAREN R

25 PINECREST CIRCLE

PROPERTY DATA	
NEIGHBORHOOD CODE	__ __
STREET CODE	__ __ __
LAND USE	__ __
SECONDARY ZONE	__ __
TOPOGRAPHY	__ __
UTILITIES	__ __
STREET	3
SALE DATA	
DATE(MM/YY)	__ / __ / __
PRICE	__ / __ / __
SALE TYPE	__
FINANCING	__
VERIFIED	__
VALIDITY	__

BOOK	PAGE	DATE	CONSIDERATION

ASSESSMENT RECORD				
YEAR	LAND	BUILDINGS	EXEMPT	TOTAL

LAND DATA						
FRONT FOOT	TYPE	EFFECTIVE		INFLUENCE		INFLUENCE CODES
		Frontage	Depth	Factor	Code	
11. Regular Lot				___ %	___	ACRES (cont.) 34. Softwood (F&O) 35. Mixed Wood (F&O) 36. Hardwood (F&O) 37. Softwood (T.G.) 38. Mixed Wood (T.G.) 39. Hardwood (T.G.) 40. Waste 41. Gravel Pit SITE 42. Moho Site 43. Condo Site 44. Lot Improvements
12. Delta Triangle				___ %	___	
13. Nabra Triangle				___ %	___	
14. Rear Land				___ %	___	
15.				___ %	___	
				___ %	___	
				___ %	___	
				___ %	___	
				___ %	___	
				___ %	___	
				___ %	___	
				___ %	___	
				___ %	___	
				___ %	___	
				___ %	___	
SQUARE FOOT		SQUARE FEET				
16. Regular Lot				___ %	___	
17. Secondary				___ %	___	
18. Excess Land				___ %	___	
19. Condo.				___ %	___	
20.				___ %	___	
FRACT. ACRE		ACREAGE/SITES				
21. Homesite				___ %	___	
22. Baselot				___ %	___	
23.				___ %	___	
ACRES						
24. Homesite				___ %	___	
25. Baselot				___ %	___	
26. Secondary				___ %	___	
27. Frontage				___ %	___	
28. Rear 1				___ %	___	
29. Rear 2				___ %	___	
30. Rear 3				___ %	___	
31. Tillable				___ %	___	
32. Pasture				___ %	___	
33. Orchard				___ %	___	
Total				___ %	___	

No./Date	Description	Date Insp.

NOTES:

BT

BUILDING RECORD

MAP LOT ACCOUNT NO. ADDRESS CARD NO. OF

Table with 5 columns: Building Style, Dwelling Units, Other Units, Stories, Exterior Walls, Roof Surface, S/F Masonry Trim, Year Built, Year Remodeled, Foundation, Basement, BSMT Gar # Cars, Wet Basement, S/F BSMT Living, FIN BSMT Grade, Heat Type, Kitchen Style, Bath(S) Style, # Rooms, # Bedrooms, # Full Baths, # Half Baths, # Addn Fixtures, # Fireplaces, # Hearths, Layout, Attic, Int Comp to Exit, Inspected By, Date Inspected, Insulation, Unfinished %, Grade & Factor, Sq. Footage, Condition, Phys. % Good, Funct. % Good, Funct. Code, Econ. % Good, Econ. Code, Entrance Code, Info. Code.

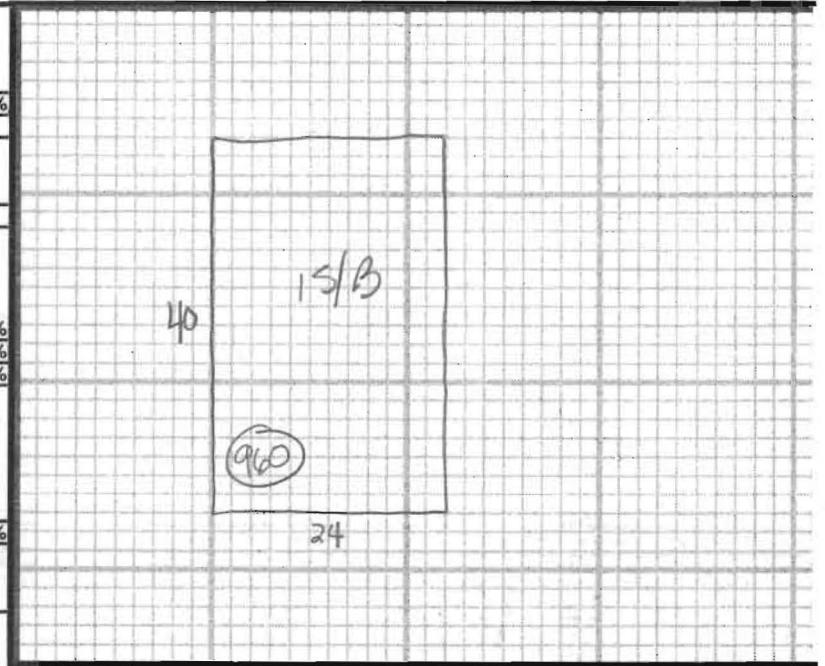

ADDITIONS, OUTBUILDINGS & IMPROVEMENTS

Table with 8 columns: TYPE, YEAR, UNITS, GRADE, COND, Phys. %, Funct. %. Row 1: TYPE 15/B, YEAR 960, UNITS 1, GRADE 3, COND 9.

- CODES
1. 1S Fr.
2. 2S Fr.
3. 3S Fr.
4. 1 1/2S Fr.
5. 1 3/4S Fr.
6. 2 1/2S Fr.
Add 10 for Bsmt
21. OFP
22. EFP
23. Garage
24. Shed
25. Bay Window
26. Overhang
27. Unf. Bsmt
28. Unf. Attic
29. Fin. Attic
Add 20 for 2 Story
61. Carport
62. Patio
63. Swimming Pool
64. Tennis Court
65. Stable w/lot
66. Greenhouse
67. Natatorium
68. Wood Deck
69. Jacuzzi

PHOTO

NOTES: