

MAP LOT

ACCOUNT NO. **3570**

ADDRESS

TOWN OF WATERBORO, MAINE

CARD NO. OF

046-001-277

CARON STEPHEN R  
11 ALLVIEW TERRACE  
B 12079 P 1

046-001-277

DEANGELIS MICHAEL & KERRY  
11 ALLVIEW TERRACE  
11/02/2005 \$110,900

PROPERTY DATA	
NEIGHBORHOOD CODE	<u>  1  </u>
STREET CODE	<u>    </u>
LAND USE	<u>  47  </u>
SECONDARY ZONE	<u>    </u>
TOPOGRAPHY	<u>  2  </u>
UTILITIES	<u>  9  </u>
STREET	<u>  3  </u>
SALE DATA	<u>    </u>
FINANCING	<u>    </u>
VERIFIED	<u>    </u>
VALIDITY	<u>    </u>

BOOK	PAGE	DATE	CONSIDERATION
14371	655, 657	2-18-05	
14658	900	11-2-05	110,900

ASSESSMENT RECORD				
YEAR	LAND	BUILDINGS	EXEMPT	TOTAL

LAND DATA						
FRONT FOOT	TYPE	EFFECTIVE		INFLUENCE		INFLUENCE CODES
		Frontage	Depth	Factor	Code	
11. Regular Lot						1=Vacancy
12. Delta Triangle						2=Excess Frontage
13. Nabla Triangle						3=Topography
14. Rear Land						4=Size/Shape
15.						5=Access
						6=Restrictions
						7=Corner
						8=Environment
						9=Fractional Share
SQUARE FOOT	TYPE	SQUARE FEET				ACRES (cont.)
16. Regular Lot						
17. Secondary						35. Mixed Wood (F&O)
18. Excess Land						36. Hardwood (F&O)
19. Condo.						37. Softwood (T.G.)
20.						38. Mixed Wood (T.G.)
FRACT. ACRE	TYPE	ACREAGE/SITES				SITE
21. Homesite						
22. Baselot						43. Condo Site
23.						44. Lot Improvements
ACRES	TYPE					
24. Homesite						
25. Baselot						
26. Secondary						
27. Frontage						
28. Rear 1						
29. Rear 2						
30. Rear 3						
31. Tillable						
32. Pasture						
33. Orchard						
Total						

No./Date	Description	Date Insp.

**NOTES:**

115

BUILDING RECORD

MAP LOT ACCOUNT NO. ADDRESS CARD NO. OF

<b>BUILDING STYLE</b> 1. Conv. 6. Split Lev. 2. Ranch 7. Contemp. 3. R. Ranch 8. Log 4. Cape 9. Other 5. Garrison	2	<b>S/F BSMT LIVING</b> <b>FIN BSMT GRADE</b>		<b>INSULATION</b> 1. Full 4. Minimal 2. Heavy 9. None 3. Capped	1
<b>DWELLING UNITS</b> <b>OTHER UNITS</b>		<b>HEAT TYPE</b> 1. HW BB 6. Grav. WA 2. HW CI 7. Electric 3. HW Radiant 8. Units 4. Steam 9. No Heat 5. FWA	5 100%	<b>UNFINISHED %</b> <b>GRADE &amp; FACTOR</b> 1. E 4. B 2. D 5. A 3. C 6. AA	80 -3
<b>STORIES</b> 1. One 4. 1 1/2 2. Two 5. 1 3/4 3. Three 6. 2 1/2	1	<b>COOL TYPE</b> 1. Central 9. None	9%	<b>SQ. FOOTAGE</b> <b>CONDITION</b> 1. Poor 5. Avg + 2. Fair 6. Good 3. Avg - 7. V Good 4. Avg. 8. Exc.	1216 4
<b>EXTERIOR WALLS</b> 1. Clapboard 6. BR./Stone 2. WD.SH. 7. Novelty 3. Comp. 8. AL/Vnryl 4. ASB/ASP 9. Other 5. T1-11	9 WOOD	<b>KITCHEN STYLE</b> 1. Good 3. Old Style 2. Typical 4. Obsolete	2	<b>PHYS. % GOOD</b> <b>FUNCT. % GOOD</b> <b>FUNCT. CODE</b> 1. Incomp. 5. CDU 2. Overbuilt 6. Style 3. Delap. 7. Layout 4. Small Size 8. Other 9. None	100% 100%
<b>ROOF SURFACE</b> 1. Asphalt 4. Comp. 2. Slate 5. Wood 3. Metal 6. Other	1	<b>BATH(S) STYLE</b> 1. Good 3. Old Style 2. Typical 4. Obsolete	2	<b>ECON. % GOOD</b> <b>ECON. CODE</b> 1. Location 3. Services 2. Encroach 9. None	100%
<b>S/F MASONRY TRIM</b> <b>YEAR BUILT</b> <b>YEAR REMODELED</b>	1989	<b># ROOMS</b> <b># BEDROOMS</b> <b># FULL BATHS</b> <b># HALF BATHS</b> <b># ADDN FIXTURES</b> <b># FIREPLACES</b> <b># HEARTHES</b>	3 1 1	<b>ENTRANCE CODE</b> 1. Inspt. 3. Vacant 2. Refused 5. Estim. 3. Info Only	5
<b>FOUNDATION</b> 1. Conc. 4. Wood 2. C Blk 5. Slab 3. Br./Stone 6. Piers	4	<b>LAYOUT</b> 1. Typical 2. In adeg.	1	<b>INFO. CODE</b> 1. Owner 4. Agent 2. Relative 5. Estimate 3. Tenant 6. Other 2. Refused 5. Estim.	5
<b>BASEMENT</b> 1. 1/4 3. 3/4 5. Crawl 2. 1/2 4. Full 6. None	5	<b>ATTIC</b> 1. 1/4 Fin 4. Full Fin. 2. 1/2 Fin. 5. Fl/Stairs 3. 3/4 Fin. 9. None	9		
<b>BSMT GAR # CARS</b> <b>WET BASEMENT</b> 1. Dry 3. Wet 2. Damp 9. None	1	<b>INT COMP TO EXIT +- =</b> <b>INSPECTED BY</b> <b>DATE INSPECTED</b>	KSH 6/28/05		5

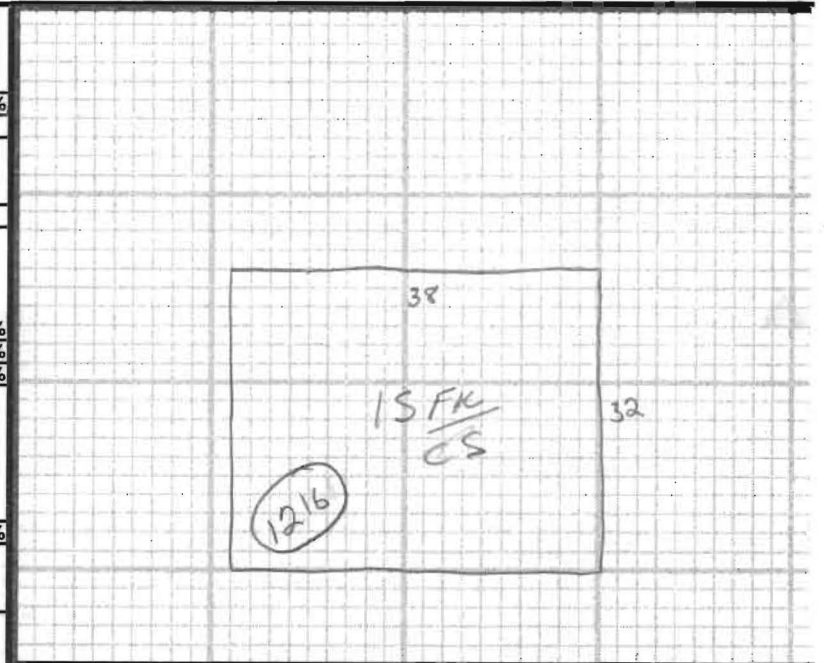

ADDITIONS, OUTBUILDINGS & IMPROVEMENTS						PERCENT GOOD		CODES
TYPE	YEAR	UNITS	GRADE	COND	Phys.	Funct.		
15 GAR	01	1216						1. 1S Fr.
	23	864						2. 2S Fr.
								3. 3S Fr.
								4. 1 1/2S Fr.
								5. 1 3/4S Fr.
								6. 2 1/2S Fr.
								Add 10 for Bsmt
								21. OFFP
								22. EFP
								23. Garage
								24. Shed
								25. Bay Window
								26. Overhang
								27. Unf. Bsmt
								28. Unf. Attic
								29. Fin. Attic
								Add 20 for 2 Story
								61. Carport
								62. Patio
								63. Swimming Pool
								64. Tennis Court
								65. Stable w/lot
								66. Greenhouse
								67. Natatorium
								68. Wood Deck
								69. Jacuzzi

PHOTO

NOTES: