

MAP LOT

ACCOUNT NO. 3425 ADDRESS

TOWN OF WATERBORO, MAINE

CARD NO. OF

045-001-620

DOWD THOMAS

8 SEQUOIA LANE

PROPERTY DATA

NEIGHBORHOOD CODE

STREET CODE

LAND USE

- 11. Residential
- 21. Village
- 22. Village/Res.
- 31. Agricultural/Res.
- 33. Forest/Agri.
- 40. Conservation
- 45. General Purpose
- 48. Shoreland
- 49. Resource Protection

SECONDARY ZONE

TOPOGRAPHY

- 1. Level
- 2. Rolling
- 3. Above St.
- 4. Below St.
- 5. Low
- 6. Swampy
- 7. Steep
- 8.

UTILITIES

- 1. All Public
- 2. Public Water
- 3. Public Sewer
- 4. Drilled Well
- 5. Dug Well
- 6. Septic
- 7. Cess Pool
- 9. No Utilities

STREET

- 1. Paved
- 2. Semi-Improved
- 3. Gravel
- 4. Proposed
- 9. No Street

SALE DATA

DATE(MM/YY)

PRICE

SALE TYPE

- 1. Land
- 2. Land & Bldg.
- 3. Building Only
- 4. Mobile Home
- 5. Other

FINANCING

- 1. Conv.
- 2. FHA/VA
- 3. Assumed
- 4. Seller
- 5. Private
- 6. Cash
- 7. FMHA
- 9. Unknown

VERIFIED

- 1. Buyer
- 2. Seller
- 3. Lender
- 4. Agent
- 5. Record
- 6. MLS
- 7. Family
- 8. Other
- 9. Confid.

VALIDITY

- 1. Valid
- 2. Related
- 3. Distress
- 4. Split
- 5. Partial
- 6. Exempt
- 7. Changed
- 8. Other

BOOK	PAGE	DATE	CONSIDERATION

ASSESSMENT RECORD

YEAR	LAND	BUILDINGS	EXEMPT	TOTAL

LAND DATA

TYPE	EFFECTIVE		INFLUENCE		INFLUENCE CODES
	Frontage	Depth	Factor	Code	
FRONT FOOT 11. Regular Lot 12. Delta Triangle 13. Nabla Triangle 14. Rear Land 15.					
SQUARE FOOT 16. Regular Lot 17. Secondary 18. Excess Land 19. Condo. 20.					
FRACT. ACRE 21. Homesite 22. Baselot 23.					
ACRES 24. Homesite 25. Baselot 26. Secondary 27. Frontage 28. Rear 1 29. Rear 2 30. Rear 3 31. Tillable 32. Pasture 33. Orchard					
Total					

- 1=Vacancy
- 2=Excess Frontage
- 3=Topography
- 4=Size/Shape
- 5=Access
- 6=Restrictions
- 7=Corner
- 8=Environment
- 9=Fractional Share

- ACRES (cont.)
- 34. Softwood (F&O)
- 35. Mixed Wood (F&O)
- 36. Hardwood (F&O)
- 37. Softwood (T.G.)
- 38. Mixed Wood (T.G.)
- 39. Hardwood (T.G.)
- 40. Waste
- 41. Gravel Pit

- SITE
- 42. Moho Site
- 43. Condo Site
- 44. Lot Improvements

No./Date	Description	Date Insp.

NOTES:

142

BUILDING RECORD

MAP LOT ACCOUNT NO. ADDRESS CARD NO. OF

<b>BUILDING STYLE</b> 1. Conv. 6. Split Lev. 2. Ranch 7. Contemp. 3. R. Ranch 8. Log 4. Cape 9. Other 5. Garrison	SATON 4	<b>S/F BSMT LIVING</b> <b>FIN BSMT GRADE</b>	<b>INSULATION</b> 1. Full 4. Minimal 2. Heavy 9. None 3. Capped	1
<b>DWELLING UNITS</b> <b>OTHER UNITS</b>	1	<b>HEAT TYPE</b> 1. HW BB 6. Grav. WA 2. HW CI 7. Electric 3. HW Radiant 8. Units 4. Steam 9. No Heat 5. FWA	<b>UNFINISHED %</b> <b>GRADE &amp; FACTOR</b> 1. E 4. B 2. D 5. A 3. C 6. AA	3+
<b>STORIES</b> 1. One 4. 1 1/2 2. Two 5. 1 3/4 3. Three 6. 2 1/2	4	<b>COOL TYPE</b> 1. Central 9. None	<b>SQ. FOOTAGE</b> <b>CONDITION</b> 1. Poor 5. Avg + 2. Fair 6. Good 3. Avg - 7. V Good 4. Avg. 8. Exc.	5
<b>EXTERIOR WALLS</b> 1. Clapboard 6. BR./Stone 2. WD.SH. 7. Novelty 3. Comp. 8. AL/Vinyl 4. ASB/ASP 9. Other 5. T1-11	1	<b>KITCHEN STYLE</b> 1. Good 3. Old Style 2. Typical 4. Obsolete	<b>PHYS. % GOOD</b> <b>FUNCT. % GOOD</b> <b>FUNCT. CODE</b> 1. Incomp. 5. CDU 2. Overbuilt 6. Style 3. Delap. 7. Layout 4. Small Size 8. Other 9. None	9
<b>ROOF SURFACE</b> 1. Asphalt 4. Comp. 2. Slate 5. Wood 3. Metal 6. Other	1	<b>BATH(S) STYLE</b> 1. Good 3. Old Style 2. Typical 4. Obsolete	<b>ECON. % GOOD</b> <b>ECON. CODE</b> 1. Location 3. Services 2. Encroach 9. None	9
<b>S/F MASONRY TRIM</b> <b>YEAR BUILT</b> <b>YEAR REMODELED</b>	1988	<b># ROOMS</b> <b># BEDROOMS</b> <b># FULL BATHS</b> <b># HALF BATHS</b> <b># ADDN FIXTURES</b> <b># FIREPLACES</b> <b># HEARTHES</b>	<b>ENTRANCE CODE</b> 1. Inspt. 3. Vacant 2. Refused 5. Estim. 3. Info Only	5
<b>FOUNDATION</b> 1. Conc. 4. Wood 2. C Blk 5. Stab 3. Br./Stone 6. Piers	1	<b>LAYOUT</b> 1. Typical 2. In adeq. <b>ATTIC</b> 1. 1/4 Fin 4. Full Fin. 2. 1/2 Fin. 5. FI/Stairs 3. 3/4 Fin. 9. None	<b>INFO. CODE</b> 1. Owner 4. Agent 2. Relative 5. Estimate 3. Tenant 6. Other 2. Refused 5. Estim.	5
<b>BASEMENT</b> 1. 1/4 3. 3/4 5. Crawl 2. 1/2 4. Full 6. None	4	<b>INT COMP TO EXIT + = -</b> <b>INSPECTED BY</b> <b>DATE INSPECTED</b>		5
<b>BSMT GAR # CARS</b> <b>WET BASEMENT</b> 1. Dry 3. Wet 2. Damp 9. None	1			

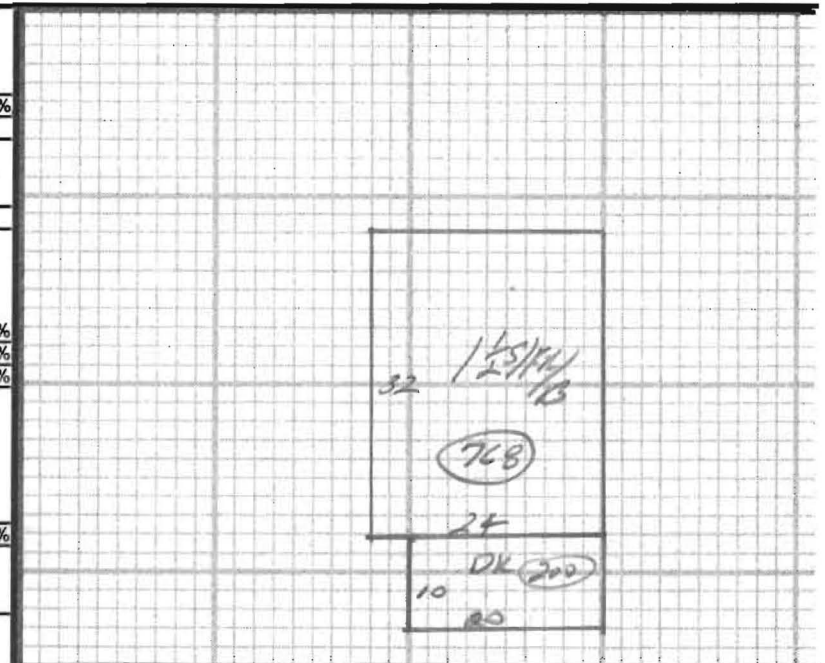

ADDITIONS, OUTBUILDINGS & IMPROVEMENTS

	TYPE	YEAR	UNITS	GRADE	COND	PERCENT GOOD		CODES
						Phys.	Funct.	
ARC	CB		200	300		%	%	1. 1S Fr. 2. 2S Fr. 3. 3S Fr. 4. 1 1/2S Fr. 5. 1 3/4S Fr. 6. 2 1/2S Fr. Add 10 for Bsmt 21. OFP 22. EFP 23. Garage 24. Shed 25. Bay Window 26. Overhang 27. Unf. Bsmt 28. Unf. Attic 29. Fin. Attic Add 20 for 2 Story 61. Carport 62. Patio 63. Swimming Pool 64. Tennis Court 65. Stable w/loft 66. Greenhouse 67. Natatorium 68. Wood Deck 69. Jacuzzi
						%	%	
						%	%	
						%	%	
						%	%	
						%	%	
						%	%	
						%	%	
						%	%	
						%	%	

PHOTO

NOTES: