

D7

MAP 45 LOT 1542 ACCOUNT NO. 3861 ADDRESS

CARD NO. OF

BUILDING STYLE	2	S/F BSMT LIVING	526	INSULATION	1
1. Conv. 6. Split Lev.		FIN BSMT GRADE	3	1. Full 4. Minimal	
2. Ranch 7. Contemp.		HEAT TYPE	1	2. Heavy 9. None	
3. R. Ranch 8. Log		1. HW BB 6. Grav. WA		3. Capped	
4. Cape 9. Other		2. HW CI 7. Electric		UNFINISHED %	%
5. Garrison		3. HW Radiant 8. Units		GRADE & FACTOR	
DWELLING UNITS	1	4. Steam 9. No Heat	100 %	1. E 4. B	3+
OTHER UNITS		5. FWA		2. D 5. A	
STORIES	1	COOL TYPE	9 %	3. C 6. AA	
1. One 4. 1 1/2		1. Central 9. None		SQ. FOOTAGE	
2. Two 5. 1 3/4		KITCHEN STYLE	2	CONDITION	4
3. Three 6. 2 1/2		1. Good 3. Old Style		1. Poor 5. Avg +	
EXTERIOR WALLS	8	2. Typical 4. Obsolete		2. Fair 6. Good	
1. Clapboard 6. BR./Stone		BATH(S) STYLE	2	3. Avg - 7. V Good	%
2. WD.SH. 7. Novelty		1. Good 3. Old Style		4. Avg. 8. Exc.	%
3. Comp. 8. AL/Minyl		2. Typical 4. Obsolete		PHYS. % GOOD	100 %
4. ASB/ASP 9. Other		# ROOMS	2	FUNCT. % GOOD	100 %
5. T1-11		# BEDROOMS	2	FUNCT. CODE	
ROOF SURFACE	1	# FULL BATHS	1	1. Incomp. 5. CDU	9
1. Asphalt 4. Comp.		# HALF BATHS		2. Overbuilt 6. Style	
2. Slate 5. Wood		# ADDN FIXTURES		3. Delap. 7. Layout	
3. Metal 6. Other		# FIREPLACES		4. Small Size 8. Other	
S/F MASONRY TRIM	1995	# HEARTHES	1	9. None	
YEAR BUILT		LAYOUT		ECON. % GOOD	100 %
YEAR REMODELED		1. Typical 2. In adeq.		ECON. CODE	
FOUNDATION		ATTIC	9	1. Location 3. Services	
1. Conc. 4. Wood		1. 1/4 Fin 4. Full Fin.		2. Encroach 9. None	
2. C Blk 5. Stab		2. 1/2 Fin. 5. Fl/Stairs		ENTRANCE CODE	
3. Br./Stone 6. Piers		3. 3/4 Fin. 9. None		1. Inspt. 3. Vacant	5
BASEMENT	4	INT COMP TO EXIT + - -		2. Refused 5. Estim.	
1. 1/4 3. 3/4 5. Crawl		INSPECTED BY	KSH	3. Info Only	
2. 1/2 4. Full 6. None		DATE INSPECTED	7/28/05	INFO. CODE	5
BSMT GAR # CARS	1			1. Owner 4. Agent	
WET BASEMENT				2. Relative 5. Estimate	
1. Dry 3. Wet				3. Tenant 6. Other	
2. Damp 9. None				2. Refused 5. Estim.	

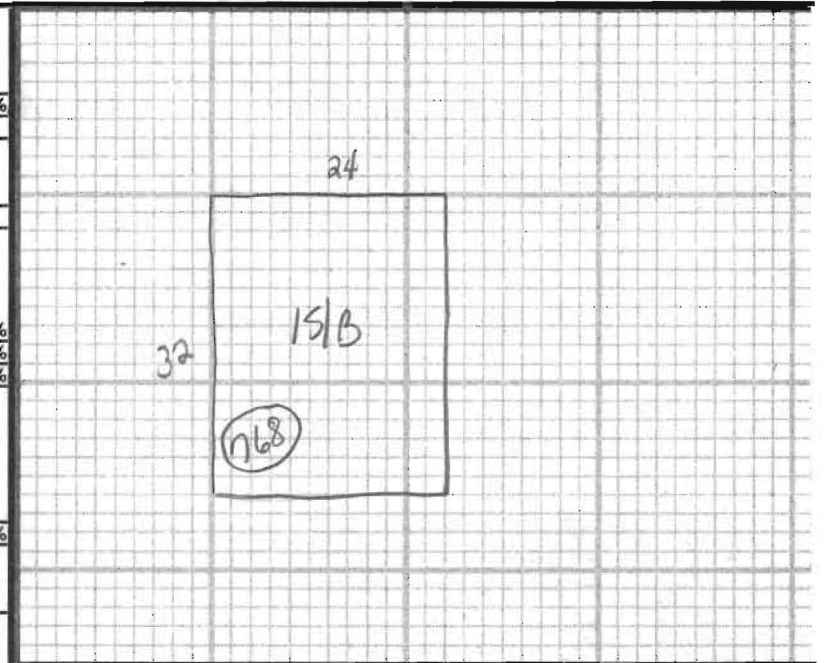

ADDITIONS, OUTBUILDINGS & IMPROVEMENTS						PERCENT GOOD		CODES
TYPE	YEAR	UNITS	GRADE	COND	Phys.	Funct.		
1518		768	3+	4	---	---	1. 1S Fr.	
Gar	24-24	576	3.00	7	---	---	2. 2S Fr.	
							3. 3S Fr.	
							4. 1 1/2S Fr.	
							5. 1 3/4S Fr.	
							6. 2 1/2S Fr.	
							Add 10 for Bsmt	
							21. OFP	
							22. EFP	
							23. Garage	
							24. Shed	
							25. Bay Window	
							26. Overhang	
							27. Unf. Bsmt	
							28. Unf. Attic	
							29. Fin. Attic	
							Add 20 for 2 Story	
							61. Carport	
							62. Patio	
							63. Swimming Pool	
							64. Tennis Court	
							65. Stable w/loft	
							66. Greenhouse	
							67. Natatorium	
							68. Wood Deck	
							69. Jacuzzi	

6.3.07 p.840

PHOTO

NOTES: