

MAP 44 LOT 1914 ACCOUNT NO. 3058 BUILDING RECORD ADDRESS CARD NO. OF

| | | | | |
|---|---|---|--|---|
| BUILDING STYLE 1. Conv. 6. Split Lev. 2. Ranch 7. Contemp. 3. R. Ranch 8. Log 4. Cape 9. Other 5. Garrison | 4 | S/F BSMT LIVING 0 | INSULATION 1. Full 4. Minimal 2. Heavy 9. None | 1 |
| DWELLING UNITS | | FIN BSMT GRADE 0 | UNFINISHED % % | |
| OTHER UNITS | | HEAT TYPE 1. HW BB 6. Grav. WA 2. HW CI 7. Electric 3. HW Radiant 8. Units 4. Steam 9. No Heat 5. FWA | GRADE & FACTOR 1. E 4. B 2. D 5. A 3. C 6. AA | 3 |
| STORIES 1. One 4. 1 1/2 2. Two 5. 1 3/4 3. Three 6. 2 1/2 | 1 | COOL TYPE 1. Central 9. None | SQ. FOOTAGE 768 | 5 |
| EXTERIOR WALLS 1. Clapboard 6. BR./Stone 2. WD.SH. 7. Novelty 3. Comp. 8. AL/Vinyl 4. ASB/ASP 9. Other 5. T1-11 | 1 | KITCHEN STYLE 1. Good 3. Old Style 2. Typical 4. Obsolete | CONDITION 1. Poor 5. Avg + 2. Fair 6. Good 3. Avg - 7. V Good 4. Avg. 8. Exc. | 9 |
| ROOF SURFACE 1. Asphalt 4. Comp. 2. Slate 5. Wood 3. Metal 6. Other | 1 | BATH(S) STYLE 1. Good 3. Old Style 2. Typical 4. Obsolete | PHYS. % GOOD % | |
| S/F MASONRY TRIM | | # ROOMS 31 | FUNCT. % GOOD % | |
| YEAR BUILT 1988 | | # BEDROOMS 3 | FUNCT. CODE 1. Incomp. 5. CDU 2. Overbuilt 6. Style 3. Delap. 7. Layout 4. Small Size 8. Other 9. None | 9 |
| YEAR REMODELED | | # FULL BATHS 1 | ECON. % GOOD % | |
| FOUNDATION 1. Conc. 4. Wood 2. C Blk 5. Stab 3. Br./Stone 6. Piers | 1 | # HALF BATHS 4 | ECON. CODE 1. Location 3. Services 2. Encroach 9. None | 9 |
| BASEMENT 1. 1/4 3. 3/4 5. Crawl 2. 1/2 4. Full 6. None | 4 | INT COMP TO EXIT + = - | ENTRANCE CODE 1. Inspct. 3. Vacant 2. Refused 5. Estim. 3. Info Only | 1 |
| BSMT GAR # CARS 0 | | INSPECTED BY RAK | INFO. CODE 1. Owner 4. Agent 2. Relative 5. Estimate 3. Tenant 6. Other 2. Refused 5. Estim. | 1 |
| WET BASEMENT 1. Dry 3. Wet 2. Damp 9. None | 1 | DATE INSPECTED 8-19-05 | | |

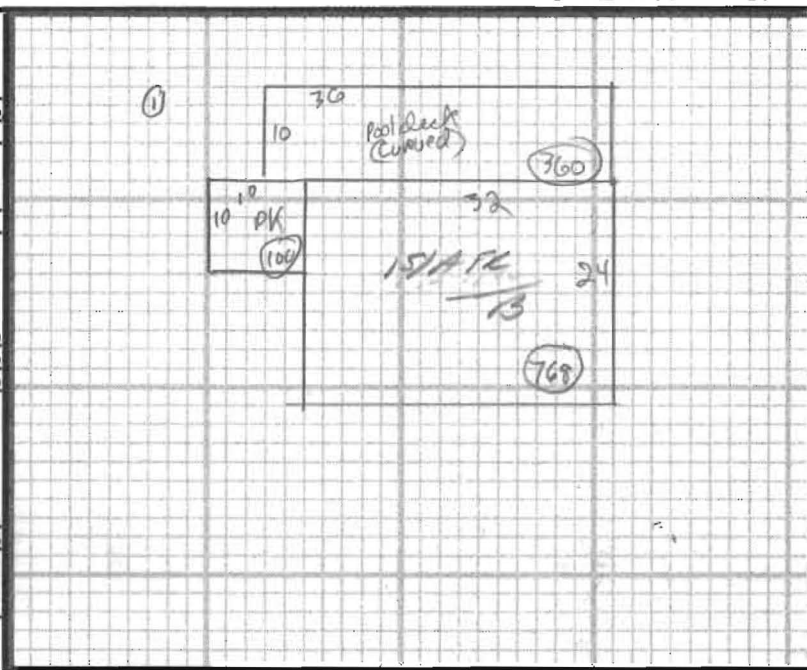

| ADDITIONS, OUTBUILDINGS & IMPROVEMENTS | | | | | | PERCENT GOOD | | CODES |
|--|------|-------|-------|------|-------|--------------|--------------------|-------|
| TYPE | YEAR | UNITS | GRADE | COND | Phys. | Funct. | | |
| 1/2 | 1988 | 0768 | | | % | % | 1. 1S Fr. | |
| PK | | 0100 | | | % | % | 2. 2S Fr. | |
| DK | | 0360 | | | % | % | 3. 3S Fr. | |
| | | | | | % | % | 4. 1 1/2S Fr. | |
| | | | | | % | % | 5. 1 3/4S Fr. | |
| | | | | | % | % | 6. 2 1/2S Fr. | |
| | | | | | % | % | Add 10 for Bsmt | |
| | | | | | % | % | 21. OFP | |
| | | | | | % | % | 22. EFP | |
| | | | | | % | % | 23. Garage | |
| | | | | | % | % | 24. Shed | |
| | | | | | % | % | 25. Bay Window | |
| | | | | | % | % | 26. Overhang | |
| | | | | | % | % | 27. Unf. Bsmt | |
| | | | | | % | % | 28. Unf. Attic | |
| | | | | | % | % | 29. Fin. Attic | |
| | | | | | % | % | Add 20 for 2 Story | |
| | | | | | % | % | 61. Carport | |
| | | | | | % | % | 62. Patio | |
| | | | | | % | % | 63. Swimming Pool | |
| | | | | | % | % | 64. Tennis Court | |
| | | | | | % | % | 65. Stable w/loft | |
| | | | | | % | % | 66. Greenhouse | |
| | | | | | % | % | 67. Natatorium | |
| | | | | | % | % | 68. Wood Deck | |
| | | | | | % | % | 69. Jacuzzi | |

PHOTO

NOTES: