

MAP LOT

ACCOUNT NO. 02809 ADDRESS

TOWN OF WATERBORO, MAINE

CARD NO. OF

043-788

MELICK PHILIP W & BRENDA A
570 NEW DAM ROAD
B 7323 P 211

PROPERTY DATA

NEIGHBORHOOD CODE	__ __
STREET CODE	__ __ __
	__ __ __
	__ __ __

LAND USE

11. Residential	
21. Village	
22. Village/Res.	
31. Agricultural/Res.	
33. Forest/Agri.	
40. Conservation	
45. General Purpose	
48. Shoreland	
49. Resource Protection	

SECONDARY ZONE

TOPOGRAPHY

1. Level	5. Low
2. Rolling	6. Swampy
3. Above St.	7. Steep
4. Below St.	8.

UTILITIES

1. All Public	5. Dug Well
2. Public Water	6. Septic
3. Public Sewer	7. Cess Pool
4. Drilled Well	9. No Utilities

STREET

1. Paved	4. Proposed
2. Semi-Improved	
3. Gravel	9. No Street

SALE DATA

DATE(MM/YY)

PRICE

SALE TYPE

1. Land	4. Mobile
2. Land & Bldg.	Home
3. Building Only	5. Other

FINANCING

1. Conv.	5. Private
2. FHA/VA	6. Cash
3. Assumed	7. FMHA
4. Seller	9. Unknown

VERIFIED

1. Buyer	6. MLS
2. Seller	7. Family
3. Lender	8. Other
4. Agent	9. Confid.
5. Record	

VALIDITY

1. Valid	5. Partial
2. Related	6. Exempt
3. Distress	7. Changed
4. Split	8. Other

BOOK	PAGE	DATE	CONSIDERATION

ASSESSMENT RECORD

YEAR	LAND	BUILDINGS	EXEMPT	TOTAL

LAND DATA

FRONT FOOT	TYPE	EFFECTIVE		INFLUENCE		INFLUENCE CODES
		Frontage	Depth	Factor	Code	
11. Regular Lot				---	%	
12. Delta Triangle				---	%	
13. Nabla Triangle				---	%	
14. Rear Land				---	%	
15.				---	%	
SQUARE FOOT		SQUARE FEET				
16. Regular Lot				---	%	
17. Secondary				---	%	
18. Excess Land				---	%	
19. Condo.				---	%	
20.				---	%	
FRACT. ACRE		ACREAGE/SITES				
21. Homesite				---	%	
22. Baselot				---	%	
23.				---	%	
ACRES						
24. Homesite				---	%	
25. Baselot				---	%	
26. Secondary				---	%	
27. Frontage				---	%	
28. Rear 1				---	%	
29. Rear 2				---	%	
30. Rear 3				---	%	
31. Tillable				---	%	
32. Pasture				---	%	
33. Orchard				---	%	
Total				---	%	

- 1=Vacancy
- 2=Excess Frontage
- 3=Topography
- 4=Size/Shape
- 5=Access
- 6=Restrictions
- 7=Corner
- 8=Environment
- 9=Fractional Share

- ACRES (cont.)
- 34. Softwood (F&O)
 - 35. Mixed Wood (F&O)
 - 36. Hardwood (F&O)
 - 37. Softwood (T.G.)
 - 38. Mixed Wood (T.G.)
 - 39. Hardwood (T.G.)
 - 40. Waste
 - 41. Gravel Pit

- SITE
- 42. Moho Site
 - 43. Condo Site
 - 44. Lot Improvements

No./Date	Description	Date Insp.

NOTES:

12D

BUILDING RECORD

MAP LOT ACCOUNT NO. 2809 ADDRESS CARD NO. OF

BUILDING STYLE 1. Conv. 6. Split Lev. 2. Ranch 7. Contemp. 3. R. Ranch 8. Log 4. Cape 9. Other 5. Garrison	2	S/F BSMT LIVING FIN BSMT GRADE		INSULATION 1. Full 4. Minimal 2. Heavy 9. None 3. Capped	1
DWELLING UNITS	1	HEAT TYPE 1. HW BB 6. Grav. WA 2. HW CI 7. Electric 3. HW Radiant 8. Units 4. Steam 9. No Heat 5. FWA	100 %	UNFINISHED %	%
OTHER UNITS		COOL TYPE 1. Central 9. None	9 %	GRADE & FACTOR 1. E 4. B 2. D 5. A 3. C 6. AA	3+
STORIES 1. One 4. 1 1/2 2. Two 5. 1 3/4 3. Three 6. 2 1/2	1	KITCHEN STYLE 1. Good 3. Old Style 2. Typical 4. Obsolete	2	SQ. FOOTAGE	
EXTERIOR WALLS 1. Clapboard 6. BR./Stone 2. WD.SH. 7. Novelty 3. Comp. 8. AL/Vinyl 4. ASB/ASP 9. Other 5. T1-11	1	BATH(S) STYLE 1. Good 3. Old Style 2. Typical 4. Obsolete	2	CONDITION 1. Poor 5. Avg + 2. Fair 6. Good 3. Avg - 7. V Good 4. Avg. 8. Exc.	6
ROOF SURFACE 1. Asphalt 4. Comp. 2. Slate 5. Wood 3. Metal 6. Other	1	# ROOMS	5	PHYS. % GOOD	100 %
S/F MASONRY TRIM		# BEDROOMS	3	FUNCT. % GOOD	100 %
YEAR BUILT	1988	# FULL BATHS	1	FUNCT. CODE 1. Incomp. 5. CDU 2. Overbuilt 6. Style 3. Delap. 7. Layout 4. Small Size 8. Other 9. None	9
YEAR REMODELED		# HALF BATHS		ECON. % GOOD	100 %
FOUNDATION 1. Conc. 4. Wood 2. C Blk 5. Stab 3. Br./Stone 6. Piers	1	# ADDN FIXTURES		ECON. CODE 1. Location 3. Services 2. Encroach 9. None	
BASEMENT 1. 1/4 3. 3/4 5. Crawl 2. 1/2 4. Full 6. None	4	# FIREPLACES		ENTRANCE CODE 1. Inspct. 3. Vacant 2. Refused 5. Estim. 3. Info Only	3
BSMT GAR # CARS		# HEARTHES	1	INFO. CODE 1. Owner 4. Agent 2. Relative 5. Estimate 3. Tenant 6. Other 2. Refused 5. Estim.	1
WET BASEMENT 1. Dry 3. Wet 2. Damp 9. None	1	LAYOUT 1. Typical 2. In adeq.			
		ATTIC 1. 1/4 Fin. 4. Full Fin. 2. 1/2 Fin. 5. Fl/Stairs 3. 3/4 Fin. 9. None	9		
		INT COMP TO EXIT + = -			
		INSPECTED BY	KSH		
		DATE INSPECTED	6/6/05		

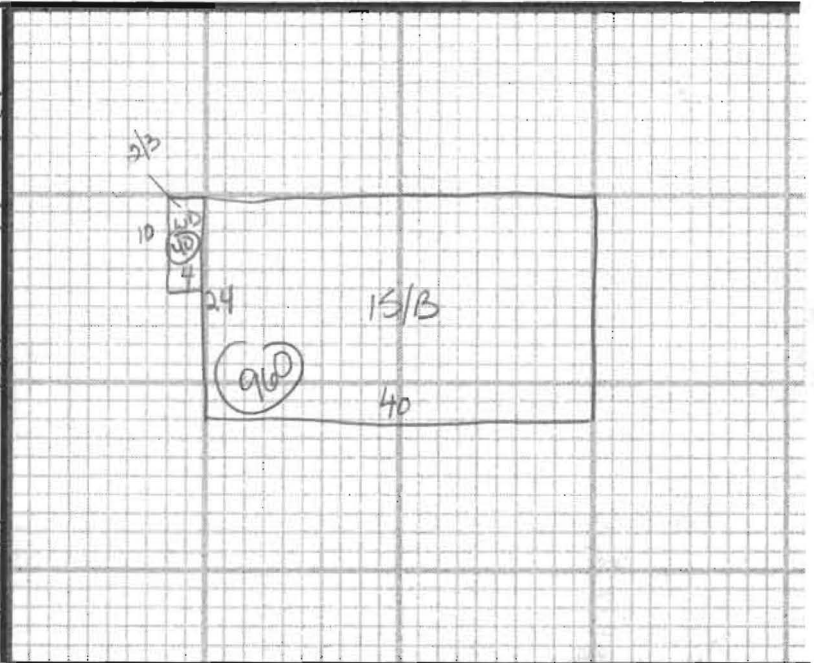

ADDITIONS, OUTBUILDINGS & IMPROVEMENTS						PERCENT GOOD		CODES
TYPE	YEAR	UNITS	GRADE	COND	Phys.	Funct.		
13/3	1	960			%	%	1. 1S Fr. 2. 2S Fr. 3. 3S Fr. 4. 1 1/2S Fr. 5. 1 3/4S Fr. 6. 2 1/2S Fr. Add 10 for Bsmt	
WD	68	40	2	3	%	%	21. OFP 22. EFP 23. Garage 24. Shed	
SHED	24	80			%	%	25. Bay Window 26. Overhang 27. Unf. Bsmt 28. Unf. Attic 29. Fin. Attic	
					%	%	Add 20 for 2 Story 61. Carport 62. Patio 63. Swimming Pool 64. Tennis Court 65. Stable w/loft 66. Greenhouse 67. Natatorium 68. Wood Deck 69. Jacuzzi	

PHOTO
y0

NOTES: