

HARFOUSH DANIEL & CLINCH, BELINDA

40 NORTHLAND ROAD

HARFOUSH, BELINDA
 B15143P892 B4983P13
 Maplot: 042-00A-198
 40 NORTHLAND ROAD
 Acres 0.00

2583

ADDRESS

TOWN OF WATERBORO, MAINE

CARD NO. OF

PROPERTY DATA	
NEIGHBORHOOD CODE	2
T CODE	
USE	47
SECONDARY ZONE	
TOPOGRAPHY	2
UTILITIES	9
STREET	3

BOOK	PAGE	DATE	CONSIDERATION
4983	13		

ASSESSMENT RECORD				
YEAR	LAND	BUILDINGS	EXEMPT	TOTAL
02	14500	64900		79400

SALE DATA	
DATE(MM/YY)	1
PRICE	
SALE TYPE	
FINANCING	
VERIFIED	
VALIDITY	

LAND DATA						
	TYPE	EFFECTIVE		INFLUENCE		INFLUENCE CODES
		Frontage	Depth	Factor	Code	
FRONT FOOT				%		1=Vacancy 2=Excess Frontage 3=Topography 4=Size/Shape 5=Access 6=Restrictions 7=Corner 8=Environment 9=Fractional Share ACRES (cont.) 34. Softwood (F&O) 35. Mixed Wood (F&O) 36. Hardwood (F&O) 37. Softwood (T.G.) 38. Mixed Wood (T.G.) 39. Hardwood (T.G.) 40. Waste 41. Gravel Pit SITE 42. Moho Site 43. Condo Site 44. Lot Improvements
11. Regular Lot				%		
12. Delta Triangle				%		
13. Nabla Triangle				%		
14. Rear Land				%		
15.				%		
SQUARE FOOT		SQUARE FEET				
16. Regular Lot				%		
17. Secondary				%		
18. Excess Land				%		
19. Condo.				%		
20.				%		
FRACT. ACRE		ACREAGE/SITES				
21. Homesite				%		
22. Baselot				%		
23.				%		
ACRES				%		
24. Homesite				%		
25. Baselot				%		
26. Secondary				%		
27. Frontage				%		
28. Rear 1				%		
29. Rear 2				%		
30. Rear 3				%		
31. Tillable				%		
32. Pasture				%		
33. Orchard				%		
Total						

No./Date	Description	Date Insp.

NOTES:

MAP 42 LOT A198 ACCOUNT NO. 2583 BUILDING RECORD ADDRESS CARD NO. OF

BUILDING STYLE		S/F BSMT LIVING		INSULATION	
1. Conv. 6. Split Lev. 2. Ranch 7. Contemp. 3. R. Ranch 8. Log 4. Cape 9. Other 5. Garrison	7	FIN BSMT GRADE		1. Full 4. Minimal 2. Heavy 9. None 3. Capped	1
DWELLING UNITS		HEAT TYPE		UNFINISHED %	%
OTHER UNITS		1. HW BB 6. Grav. WA 2. HW CI 7. Electric 3. HW Radiant 8. Units 4. Steam 9. No Heat 5. FWA	1	GRADE & FACTOR	1/0 3+
STORIES	1	COOL TYPE	9 %	1. E 4. B 2. D 5. A 3. C 6. AA	0936
1. One 4. 1 1/2 2. Two 5. 1 3/4 3. Three 6. 2 1/2		KITCHEN STYLE	2	SQ. FOOTAGE	5
EXTERIOR WALLS	1	1. Good 3. Old Style 2. Typical 4. Obsolete		CONDITION	
1. Clapboard 6. BR./Stone 2. WD.SH. 7. Novelty 3. Comp. 8. AL/Vinyl 4. ASB/ASP 9. Other 5. T1-11		BATH(S) STYLE	2	1. Poor 5. Avg + 2. Fair 6. Good 3. Avg - 7. V Good 4. Avg. 8. Exc.	%
ROOF SURFACE	1	1. Good 3. Old Style 2. Typical 4. Obsolete		PHYS. % GOOD	%
1. Asphalt 4. Comp. 2. Slate 5. Wood 3. Metal 6. Other		# ROOMS	3	FUNCT. % GOOD	%
S/F MASONRY TRIM		# BEDROOMS	3	FUNCT. CODE	
YEAR BUILT	1988	# FULL BATHS	2	1. Incomp. 5. CDU 2. Overbuilt 6. Style 3. Delap. 7. Layout 4. Small Size 8. Other 9. None	9
YEAR REMODELED		# HALF BATHS	2	ECON. % GOOD	%
FOUNDATION		# ADDN FIXTURES	1	ECON. CODE	9
1. Conc. 4. Wood 2. C Blk 5. Stab 3. Br./Stone 6. Piers	5	# FIREPLACES	1	1. Location 3. Services 2. Encroach 9. None	
BASEMENT	6	# HEARTHES	1	ENTRANCE CODE	1
1. 1/4 3. 3/4 5. Crawl 2. 1/2 4. Full 6. None		LAYOUT	1	1. Inspct. 3. Vacant 2. Refused 5. Estim. 3. Info Only	
BSMT GAR # CARS	2	1. Typical 2. In adeq.		INFO. CODE	1
WET BASEMENT	9	ATTIC	4	1. Owner 4. Agent 2. Relative 5. Estimate 3. Tenant 6. Other 2. Refused 5. Estim.	
1. Dry 3. Wet 2. Damp 9. None		1. 1/4 Fin. 4. Full Fin. 2. 1/2 Fin. 5. Fl/Stairs 3. 3/4 Fin. 9. None		DATE INSPECTED	7-8-05

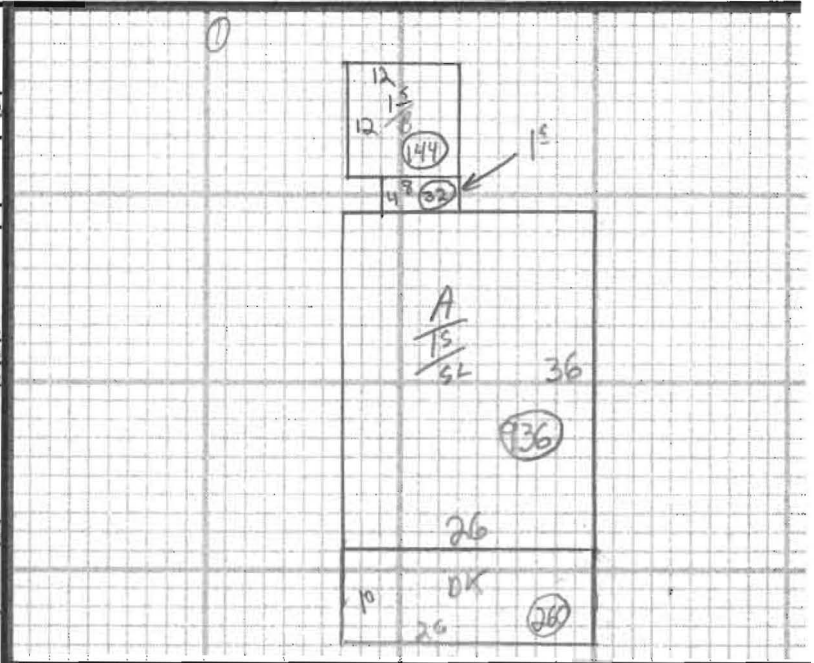

ADDITIONS, OUTBUILDINGS & IMPROVEMENTS						PERCENT GOOD		CODES
TYPE	YEAR	UNITS	GRADE	COND	Phys.	Funct.		
15	001	1988	0936					1. 1S Fr.
15	001		0144					2. 2S Fr.
BSMT	027		0144					3. 3S Fr.
DK	068		0260					4. 1 1/2S Fr.
15	001		0032					5. 1 3/4S Fr.
								6. 2 1/2S Fr.
								Add 10 for Bsmt
								21. OFP
								22. EFP
								23. Garage
								24. Shed
								25. Bay Window
								26. Overhang
								27. Unf. Bsmt
								28. Unf. Attic
								29. Fin. Attic
								Add 20 for 2 Story
Shed	024		0080					61. Carport
								62. Patio
								63. Swimming Pool
								64. Tennis Court
								65. Stable w/oft
								68. Greenhouse
								67. Natatorium
								68. Wood Deck
								69. Jacuzzi

PHOTO

NOTES: 15/1/06