

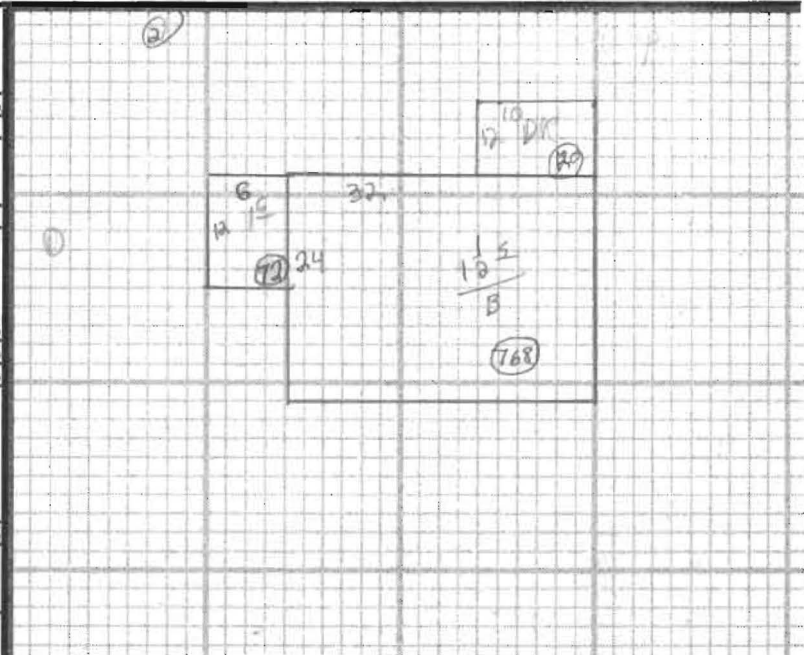

TOWN OF WATERBORO, MAINE

MAP **42** LOT **A 186** ACCOUNT NO. BUILDING RECORD ADDRESS CARD NO. OF

|   |   |   |
|---|---|---|
| <b>BUILDING STYLE</b><br>1. Conv. 6. Split Lev.<br>2. Ranch 7. Contemp.<br>3. R. Ranch 8. Log<br>4. Cape 9. Other<br>5. Garrison      | <b>S/F BSMT LIVING</b><br>FIN BSMT GRADE  | <b>INSULATION</b><br>1. Full 4. Minimal<br>2. Heavy 9. None<br>3. Capped  |
| <b>DWELLING UNITS</b>   | <b>HEAT TYPE</b><br>1. HW BB 6. Grav. WA<br>2. HW CI 7. Electric<br>3. HW Radiant 8. Units<br>4. Steam 9. No Heat<br>5. FWA                             | <b>UNFINISHED %</b><br>GRADE & FACTOR<br>1. E 4. B<br>2. D 5. A<br>3. C 6. AA                                   |
| <b>OTHER UNITS</b>  | <b>COOL TYPE</b><br>1. Central 9. None  | <b>SQ. FOOTAGE</b>  |
| <b>STORIES</b><br>1. One 4. 1 1/2<br>2. Two 5. 1 3/4<br>3. Three 6. 2 1/2   | <b>KITCHEN STYLE</b><br>1. Good 3. Old Style<br>2. Typical 4. Obsolete  | <b>CONDITION</b><br>1. Poor 5. Avg +<br>2. Fair 6. Good<br>3. Avg - 7. V Good<br>4. Avg. 8. Exc.                |
| <b>EXTERIOR WALLS</b><br>1. Clapboard 6. BR./Stone<br>2. WD.SH. 7. Novelty<br>3. Comp. 8. AL/Vinyl<br>4. ASB/ASP 9. Other<br>5. T1-11 | <b>BATH(S) STYLE</b><br>1. Good 3. Old Style<br>2. Typical 4. Obsolete  | <b>PHYS. % GOOD</b><br><b>FUNCT. % GOOD</b>   |
| <b>ROOF SURFACE</b><br>1. Asphalt 4. Comp.<br>2. Slate 5. Wood<br>3. Metal 6. Other   | <b># ROOMS</b><br><b># BEDROOMS</b><br><b># FULL BATHS</b><br><b># HALF BATHS</b><br><b># ADDN FIXTURES</b><br><b># FIREPLACES</b><br><b># HEARTHES</b> | <b>ECON. % GOOD</b><br><b>ECON. CODE</b><br>1. Location 3. Services<br>2. Encroach 9. None                      |
| <b>S/F MASONRY TRIM</b>   | <b>LAYOUT</b><br>1. Typical 2. In adeq.   | <b>ENTRANCE CODE</b><br>1. Inspt. 3. Vacant<br>2. Refused 5. Estim.<br>3. Info Only                             |
| <b>YEAR BUILT</b>   | <b>ATTIC</b><br>1. 1/4 Fin. 4. Full Fin.<br>2. 1/2 Fin. 5. Fl/Stairs<br>3. 3/4 Fin. 9. None   | <b>INFO. CODE</b><br>1. Owner 4. Agent<br>2. Relative 5. Estimate<br>3. Tenant 6. Other<br>2. Refused 5. Estim. |
| <b>YEAR REMODELED</b>   | <b>INT COMP TO EXIT + = -</b>   |   |
| <b>FOUNDATION</b><br>1. Conc. 4. Wood<br>2. C Blk 5. Stab<br>3. Br./Stone 6. Piers  | <b>INSPECTED BY</b><br><i>JAR RAK</i>   |   |
| <b>BASEMENT</b><br>1. 1/4 3. 3/4 5. Crawl<br>2. 1/2 4. Full 6. None   | <b>DATE INSPECTED</b><br><i>3-29-06 7-10-05</i>   |   |
| <b>BSMT GAR # CARS</b>  |   |   |
| <b>WET BASEMENT</b><br>1. Dry 3. Wet<br>2. Damp 9. None   |   |   |



3-29-06  
100-0081  
GAR Completion

PHOTO

| ADDITIONS, OUTBUILDINGS & IMPROVEMENTS |            |             |             |             |          | PERCENT GOOD |  | CODES              |
|--|------------|-------------|-------------|-------------|----------|--------------|--|--------------------|
| TYPE                                   | YEAR       | UNITS       | GRADE       | COND        | Phys.    | Funct.       |  |                    |
| <i>1/2</i>                             | <i>004</i> | <i>1997</i> | <i>0768</i> |             |          |              |  | 1. 1S Fr.          |
| <i>1 1/2</i>                           | <i>001</i> |             | <i>0072</i> |             |          |              |  | 2. 2S Fr.          |
| <i>DK</i>                              | <i>068</i> |             | <i>0120</i> |             |          |              |  | 3. 3S Fr.          |
| <i>Gar</i>                             | <i>023</i> | <i>2005</i> | <i>0624</i> | <i>3.00</i> | <i>Z</i> |              |  | 4. 1 1/2S Fr.      |
|  |            |             |             |             |          |              |  | 5. 1 3/4S Fr.      |
|  |            |             |             |             |          |              |  | 6. 2 1/2S Fr.      |
|  |            |             |             |             |          |              |  | Add 10 for Bsmt    |
|  |            |             |             |             |          |              |  | 21. OFF            |
|  |            |             |             |             |          |              |  | 22. EFP            |
|  |            |             |             |             |          |              |  | 23. Garage         |
|  |            |             |             |             |          |              |  | 24. Shed           |
|  |            |             |             |             |          |              |  | 25. Bay Window     |
|  |            |             |             |             |          |              |  | 26. Overhang       |
|  |            |             |             |             |          |              |  | 27. Unf. Bsmt      |
|  |            |             |             |             |          |              |  | 28. Unf. Attic     |
|  |            |             |             |             |          |              |  | 29. Fin. Attic     |
|  |            |             |             |             |          |              |  | Add 20 for 2 Story |
|  |            |             |             |             |          |              |  | 61. Carport        |
|  |            |             |             |             |          |              |  | 62. Patio          |
|  |            |             |             |             |          |              |  | 63. Swimming Pool  |
|  |            |             |             |             |          |              |  | 64. Tennis Court   |
|  |            |             |             |             |          |              |  | 65. Stable w/loft  |
|  |            |             |             |             |          |              |  | 66. Greenhouse     |
|  |            |             |             |             |          |              |  | 67. Natatorium     |
|  |            |             |             |             |          |              |  | 68. Wood Deck      |
|  |            |             |             |             |          |              |  | 69. Jacuzzi        |

NOTES: