

CST RUMOD 4/06
OF 2

MAP LOT

ACCOUNT NO. 2305

ADDRESS

TOWN OF WATERBORO, MAINE

CARD NO.

OF

035-024

PREBLE LUVERNE
228 EAST SHORE ROAD
B 2826 P 107

PROPERTY DATA	
NEIGHBORHOOD CODE	24
STREET CODE	---
LAND USE	48
11. Residential 21. Village 22. Village/Res. 31. Agricultural/Res. 33. Forest/Agri. 40. Conservation 45. General Purpose 48. Shoreland 49. Resource Protection	
SECONDARY ZONE	---
TOPOGRAPHY	02
1. Level 2. Rolling 3. Above St. 4. Below St.	5. Low 6. Swampy 7. Steep 8.
UTILITIES	09
1. All Public 2. Public Water 3. Public Sewer 4. Drilled Well	5. Dug Well 6. Septic 7. Cess Pool 9. No Utilities
STREET	3
1. Paved 2. Semi-Improved 3. Gravel	4. Proposed 9. No Street
SALE DATA	
DATE(MM/YY)	1/---
PRICE	---
SALE TYPE	---
1. Land 2. Land & Bldg. 3. Building Only	4. Mobile Home 5. Other
FINANCING	---
1. Conv. 2. FHA/VA 3. Assumed 4. Seller	5. Private 6. Cash 7. FMHA 9. Unknown
VERIFIED	---
1. Buyer 2. Seller 3. Lender 4. Agent 5. Record	6. MLS 7. Family 8. Other 9. Confid.
VALIDITY	---
1. Valid 2. Related 3. Distress 4. Split	5. Partial 6. Exempt 7. Changed 8. Other

BOOK	PAGE	DATE	CONSIDERATION

ASSESSMENT RECORD				
YEAR	LAND	BUILDINGS	EXEMPT	TOTAL
9/29/06		93,120 x 55%		757,200

LAND DATA						
FRONT FOOT	TYPE	EFFECTIVE		INFLUENCE		INFLUENCE CODES
		Frontage	Depth	Factor	Code	
11. Regular Lot		109	230	%		1=Vacancy
12. Delta Triangle				%		2=Excess Frontage
13. Nabla Triangle				%		3=Topography
14. Rear Land				%		4=Size/Shape
15.				%		5=Access
				%		6=Restrictions
				%		7=Corner
				%		8=Environment
				%		9=Fractional Share
SQUARE FOOT		SQUARE FEET				
16. Regular Lot				%		ACRES (cont.)
17. Secondary				%		34. Softwood (F&O)
18. Excess Land				%		35. Mixed Wood (F&O)
19. Condo.				%		36. Hardwood (F&O)
20.				%		37. Softwood (T.G.)
				%		38. Mixed Wood (T.G.)
FRACT. ACRE		ACREAGE/SITES				39. Hardwood (T.G.)
21. Homesite				%		40. Waste
22. Basemat				%		41. Gravel Pit
23.				%		
ACRES				%		SITE
24. Homesite				%		42. Moho Site
25. Basemat				%		43. Condo Site
26. Secondary				%		44. Lot Improvements
27. Frontage				%		
28. Rear 1				%		
29. Rear 2				%		
30. Rear 3				%		
31. Tillable				%		
32. Pasture				%		
33. Orchard				%		
Total						

No./Date	Description	Date Insp.

NOTES:

MAP 35 LOT 24 ACCOUNT NO. 2305 BUILDING RECORD ADDRESS CARD NO. OF

BUILDING STYLE		S/F BSMT LIVING		INSULATION	
1. Conv. 6. Split Lev. 2. Ranch 7. Contemp. 3. R. Ranch 8. Log 4. Cape 9. Other 5. Garrison	2	FIN BSMT GRADE		1. Full 4. Minimal 2. Heavy 9. None 3. Capped	1
DWELLING UNITS	1	HEAT TYPE		UNFINISHED %	%
OTHER UNITS	0	1. HW BB 6. Grav. WA 2. HW CI 7. Electric 3. HW Radiant 8. Units 4. Steam 9. No Heat 5. FWA	5	GRADE & FACTOR	
STORIES	1	COOL TYPE		1. E 4. B 2. D 5. A 3. C 6. AA	3
1. One 4. 1 1/2 2. Two 5. 1 3/4 3. Three 6. 2 1/2		1. Central 9. None	9	SQ. FOOTAGE	750
EXTERIOR WALLS	2	KITCHEN STYLE		CONDITION	6
1. Clapboard 6. BR./Stone 2. WD.SH. 7. Novelty 3. Comp. 8. AL/Vntrl 4. ASB/ASP 9. Other 5. T1-11		1. Good 3. Old Style 2. Typical 4. Obsolete	2	1. Poor 5. Avg + 2. Fair 6. Good 3. Avg - 7. V Good 4. Avg. 8. Exc.	
ROOF SURFACE	3	BATH(S) STYLE		PHYS. % GOOD	%
1. Asphalt 4. Comp. 2. Slate 5. Wood 3. Metal 6. Other		1. Good 3. Old Style 2. Typical 4. Obsolete	2	FUNCT. % GOOD	%
S/F MASONRY TRIM		# ROOMS	4	FUNCT. CODE	
YEAR BUILT	1978	# BEDROOMS	7	1. Incomp. 5. CDU 2. Overbuilt 6. Style 3. Delap. 7. Layout 4. Small Size 8. Other 9. None	9
YEAR REMODELED	2003	# FULL BATHS	1	ECON. % GOOD	%
FOUNDATION		# HALF BATHS		ECON. CODE	
1. Conc. 4. Wood 2. C Blk 5. Slab 3. Br./Stone 6. Piers	1	# ADDN FIXTURES		1. Location 3. Services 2. Encroach 9. None	9
BASEMENT	4	# FIREPLACES	1	ENTRANCE CODE	5
1. 1/4 3. 3/4 5. Crawl 2. 1/2 4. Full 6. None		# HEARTHES		1. Inspt. 3. Vacant 2. Refused 5. Estim. 3. Info Only	
BSMT GAR # CARS		LAYOUT		INFO. CODE	5
WET BASEMENT	1	1. Typical 2. In adeq.		1. Owner 4. Agent 2. Relative 5. Estimate 3. Tenant 6. Other 2. Refused 5. Estim.	
1. Dry 3. Wet 2. Damp 9. None		ATTIC	9		
		1. 1/4 Fin 4. Full Fin. 2. 1/2 Fin. 5. FV/Stairs 3. 3/4 Fin. 9. None			
		INT COMP TO EXIT + = -	7		
		INSPECTED BY	3/17/06 PJA		
		DATE INSPECTED			

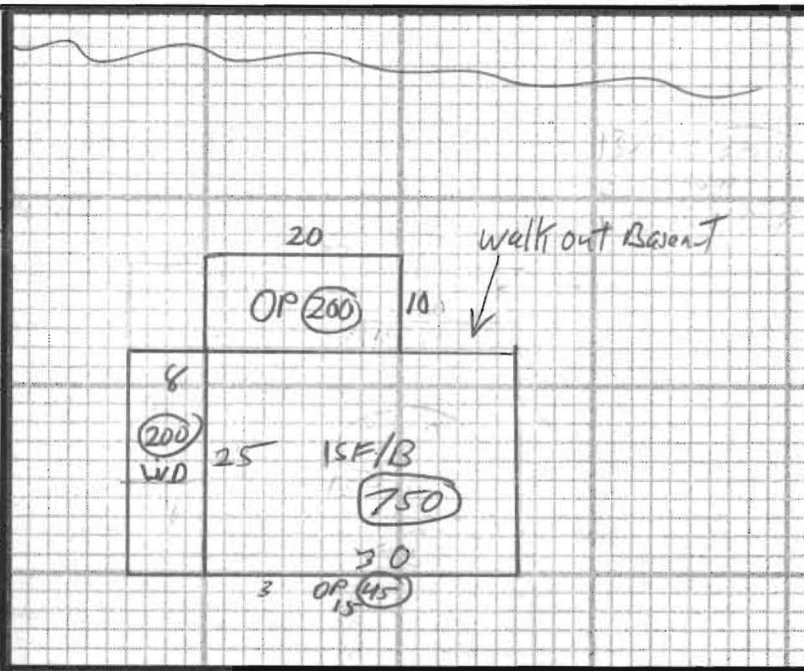

ADDITIONS, OUTBUILDINGS & IMPROVEMENTS						PERCENT GOOD		CODES
TYPE	YEAR	UNITS	GRADE	COND	Phys.	Funct.		
WD	028	200			%	%	1. 1S Fr.	
OP	021	200			%	%	2. 2S Fr.	
					%	%	3. 3S Fr.	
					%	%	4. 1 1/2S Fr.	
					%	%	5. 1 3/4S Fr.	
					%	%	6. 2 1/2S Fr.	
					%	%	Add 10 for Bsmt	
					%	%	21. OPF	
					%	%	22. EFP	
					%	%	23. Garage	
					%	%	24. Shed	
					%	%	25. Bay Window	
					%	%	26. Overhang	
					%	%	27. Unf. Bsmt	
					%	%	28. Unf. Attic	
					%	%	29. Fin. Attic	
					%	%	Add 20 for 2 Story	
					%	%	61. Carport	
					%	%	62. Patio	
					%	%	63. Swimming Pool	
					%	%	64. Tennis Court	
					%	%	65. Stable w/loft	
					%	%	66. Greenhouse	
					%	%	67. Natatorium	
					%	%	68. Wood Deck	
					%	%	69. Jacuzzi	

PHOTO

NOTES: