

MAP LOT

ACCOUNT NO. 01980

ADDRESS

TOWN OF WATERBORO, MAINE

CARD NO. OF

028-014
DODGE MARK
9 SECOND ST
B 2082 P 634

PROPERTY DATA

NEIGHBORHOOD CODE 28

STREET CODE

LAND USE

11. Residential
21. Village
22. Village/Res.
31. Agricultural/Res.
33. Forest/Agri.
40. Conservation
45. General Purpose
48. Shoreland
49. Resource Protection
48

SECONDARY ZONE

TOPOGRAPHY

1. Level 5. Low
2. Rolling 6. Swampy
3. Above St. 7. Steep
4. Below St. 8.
01

UTILITIES

1. All Public 5. Dug Well
2. Public Water 6. Septic
3. Public Sewer 7. Cess Pool
4. Drilled Well 9. No Utilities
09

STREET

1. Paved 4. Proposed
2. Semi-Improved
3. Gravel 9. No Street
3

SALE DATA

DATE(MM/YY)

PRICE

SALE TYPE

1. Land 4. Mobile
2. Land & Bldg. Home
3. Building Only 5. Other

FINANCING

1. Conv. 5. Private
2. FHA/VA 6. Cash
3. Assumed 7. FMHA
4. Seller 9. Unknown

VERIFIED

1. Buyer 6. MLS
2. Seller 7. Family
3. Lender 8. Other
4. Agent 9. Confid.
5. Record

VALIDITY

1. Valid 5. Partial
2. Related 6. Exempt
3. Distress 7. Changed
4. Split 8. Other

BOOK

PAGE

DATE

CONSIDERATION

ASSESSMENT RECORD

YEAR

LAND

BUILDINGS

EXEMPT

TOTAL

LAND DATA

TYPE	EFFECTIVE		INFLUENCE		INFLUENCE CODES
	Frontage	Depth	Factor	Code	
FRONT FOOT			%		1=Vacancy 2=Excess Frontage 3=Topography 4=Size/Shape 5=Access 6=Restrictions 7=Corner 8=Environment 9=Fractional Share ACRES (cont.) 34. Softwood (F&O) 35. Mixed Wood (F&O) 36. Hardwood (F&O) 37. Softwood (T.G.) 38. Mixed Wood (T.G.) 39. Hardwood (T.G.) 40. Waste 41. Gravel Pit SITE 42. Moho Site 43. Condo Site 44. Lot Improvements
11. Regular Lot			%		
12. Delta Triangle			%		
13. Nabla Triangle			%		
14. Rear Land			%		
15.			%		
SQUARE FOOT	SQUARE FEET		%		
16. Regular Lot			%		
17. Secondary			%		
18. Excess Land			%		
19. Condo.			%		
20.			%		
FRACT. ACRE	ACREAGE/SITES		%		
21. Homesite			%		
22. Baselot			%		
23.			%		
ACRES			%		
24. Homesite			%		
25. Baselot			%		
26. Secondary			%		
27. Frontage			%		
28. Rear 1			%		
29. Rear 2			%		
30. Rear 3			%		
31. Tillable			%		
32. Pasture			%		
33. Orchard			%		
Total			%		

No./Date	Description	Date Insp.

NOTES:

TOWN OF WATERBORO, MAINE

MAP 029 LOT 014 ACCOUNT NO. 01980 BUILDING RECORD ADDRESS 9 Second St CARD NO. OF

BUILDING STYLE 1. Conv. 6. Split Lev. 2. Ranch 7. Contemp. 3. R. Ranch 8. Log 4. Cape 9. Other 5. Garrison	2	S/F BSMT LIVING FIN BSMT GRADE		INSULATION 1. Full 4. Minimal 2. Heavy 9. None 3. Capped	9
DWELLING UNITS		HEAT TYPE 1. HW BB 6. Grav. WA 2. HW CI 7. Electric 3. HW Radiant 8. Units 4. Steam 9. No Heat 5. FWA	9	UNFINISHED %	%
OTHER UNITS		COOL TYPE 1. Central 9. None	9	GRADE & FACTOR 1. E 4. B 2. D 5. A 3. C 6. AA	3
STORIES 1. One 4. 1 1/2 2. Two 5. 1 3/4 3. Three 6. 2 1/2	1	KITCHEN STYLE 1. Good 3. Old Style 2. Typical 4. Obsolete	2	SQ. FOOTAGE	504
EXTERIOR WALLS 1. Clapboard 6. BR/Stone 2. WD.SH. 7. Novelty 3. Comp. 8. AL/Vinyl 4. ASB/ASP 9. Other 5. T1-11	1	BATH(S) STYLE 1. Good 3. Old Style 2. Typical 4. Obsolete	2	CONDITION 1. Poor 5. Avg + 2. Fair 6. Good 3. Avg - 7. V Good 4. Avg. 8. Exc.	2
ROOF SURFACE 1. Asphalt 4. Comp. 2. Slate 5. Wood 3. Metal 6. Other	1	# ROOMS	1	PHYS. % GOOD	%
S/F MASONRY TRIM		# BEDROOMS	1	FUNCT. % GOOD	%
YEAR BUILT	1910	# FULL BATHS		FUNCT. CODE 1. Incomp. 5. CDU 2. Overbuilt 6. Style 3. Delap. 7. Layout 4. Small Size 8. Other 9. None	9
YEAR REMODELED		# HALF BATHS		ECON. % GOOD	%
FOUNDATION 1. Conc. 4. Wood 2. C Blk 5. Slab 3. Br/Stone 6. Piers	6	# ADDN FIXTURES		ECON. CODE 1. Location 3. Services 2. Encroach 9. None	Lake 7
BASEMENT 1. 1/4 3. 3/4 5. Crawl 2. 1/2 4. Full 6. None	9	LAYOUT 1. Typical 2. In adeq. ATTIC 1. 1/4 Fin 4. Full Fin. 2. 1/2 Fin. 5. Fl/Stairs 3. 3/4 Fin. 9. None	9	ENTRANCE CODE 1. Inspect. 3. Vacant 2. Refused 5. Estim. 3. Info Only	5
BSMT GAR # CARS		INT COMP TO EXIT + = -		INFO. CODE 1. Owner 4. Agent 2. Relative 5. Estimate 3. Tenant 6. Other 2. Refused 5. Estim.	5
WET BASEMENT 1. Dry 3. Wet 2. Damp 9. None	9	INSPECTED BY	TOR		
		DATE INSPECTED	11.3.05		

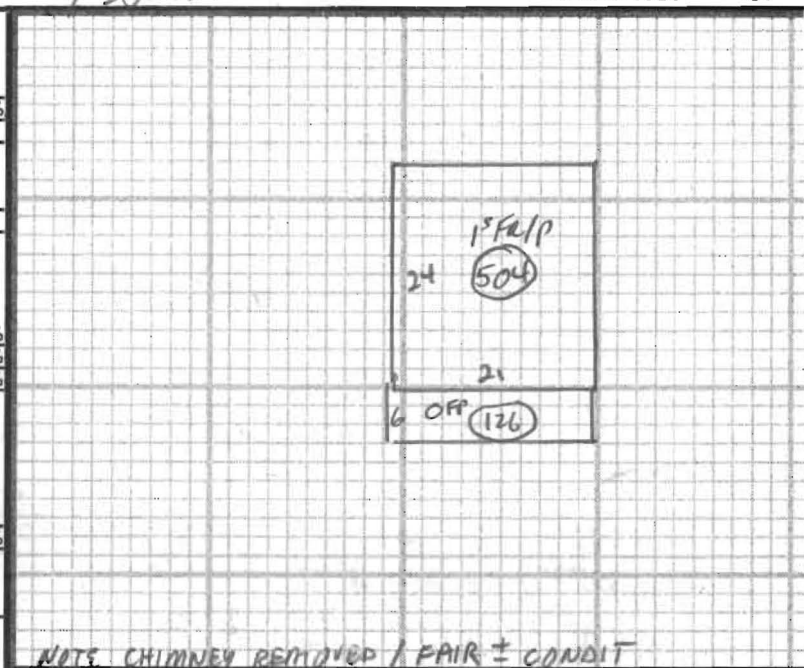

ADDITIONS, OUTBUILDINGS & IMPROVEMENTS						PERCENT GOOD		CODES
TYPE	YEAR	UNITS	GRADE	COND	Phys.	Funct.		
OFF	221	126			%	%	1. 1S Fr. 2. 2S Fr. 3. 3S Fr. 4. 1 1/2S Fr. 5. 1 3/4S Fr. 6. 2 1/2S Fr. Add 10 for Bsmt 21. OFF 22. EFP 23. Garage 24. Shed 25. Bay Window 26. Overhang 27. Unf. Bsmt 28. Unf. Attic 29. Fin. Attic Add 20 for 2 Story 61. Carport 62. Patio 63. Swimming Pool 64. Tennis Court 65. Stable w/loft 66. Greenhouse 67. Natatorium 68. Wood Deck 69. Jacuzzi	

Picture 81

PHOTO

NOTES: