



BUILDING RECORD

19A

MAP LOT ACCOUNT NO. 1923 ADDRESS CARD NO. OF

<b>BUILDING STYLE</b> 1. Conv. 8. Split Lev. 2. Ranch 7. Contemp. 3. R. Ranch 8. Log 4. Cape 9. Other 5. Gambeson	4	<b>S/F BSMT LIVING</b>		<b>INSULATION</b> 1. Full 4. Minimal 2. Heavy 9. None 3. Capped	1
<b>DWELLING UNITS</b>	1	<b>FIN BSMT GRADE</b>		<b>UNFINISHED %</b>	%
<b>OTHER UNITS</b>		<b>HEAT TYPE</b> 1. HW BB 6. Grav. WA 2. HW CI 7. Electric 3. HW Radiant 8. Units 4. Steam 9. No Heat 5. FWA	8	<b>GRADE &amp; FACTOR</b> 1. E 4. B 2. D 5. A 3. C 6. AA	3
<b>STORIES</b> 1. One 4. 1 1/2 2. Two 5. 1 3/4 3. Three 6. 2 1/2	1	<b>COOL TYPE</b> 1. Central 9. None	%	<b>SQ. FOOTAGE</b>	576
<b>EXTERIOR WALLS</b> 1. Clapboard 6. BR./Stone 2. WD.SH. 7. Novelty 3. Comp. 8. AL/Vinyl 4. ASB/ASP 9. Other 5. T1-11	5	<b>KITCHEN STYLE</b> 1. Good 3. Old Style 2. Typical 4. Obsolete	2	<b>CONDITION</b> 1. Poor 5. Avg + 2. Fair 6. Good 3. Avg - 7. V Good 4. Avg. 8. Exc.	4
<b>ROOF SURFACE</b> 1. Asphalt 4. Comp. 2. Slate 5. Wood 3. Metal 6. Other	1	<b>BATH(S) STYLE</b> 1. Good 3. Old Style 2. Typical 4. Obsolete	2	<b>PHYS. % GOOD</b>	%
<b>S/F MASONRY TRIM</b>	1969	<b># ROOMS</b>	3	<b>FUNCT. % GOOD</b>	%
<b>YEAR BUILT</b>	1999	<b># BEDROOMS</b>	1	<b>FUNCT. CODE</b> 1. Incomp. 5. CDU 2. Overbuilt 6. Style 3. Delap. 7. Layout 4. Small Size 8. Other 9. None	9
<b>YEAR REMODELED</b>		<b># FULL BATHS</b>		<b>ECON. % GOOD</b>	%
<b>FOUNDATION</b> 1. Conc. 4. Wood 2. C Blk 5. Stab 3. Br./Stone 6. Piers	6	<b># HALF BATHS</b>		<b>ECON. CODE</b> 1. Location 3. Services 2. Encroach 9. None	1
<b>BASEMENT</b> 1. 1/4 3. 3/4 5. Crawl 2. 1/2 4. Full 6. None	9	<b># ADDN FIXTURES</b>		<b>ENTRANCE CODE</b> 1. Inspt, 3. Vacant 2. Refused 5. Estim. 3. Info Only	5
<b>BSMT GAR # CARS</b>	9	<b># FIREPLACES</b>		<b>INFO. CODE</b> 1. Owner 4. Agent 2. Relative 5. Estimate 3. Tenant 6. Other 2. Refused 5. Estim.	5
<b>WET BASEMENT</b> 1. Dry 3. Wet 2. Damp 9. None	9	<b># HEARTHES</b>			
		<b>LAYOUT</b> 1. Typical 2. In adeq.	1		
		<b>ATTIC</b> 1. 1/4 Fin 4. Full Fin. 2. 1/2 Fin. 5. F/Stairs 3. 3/4 Fin. 9. None	4		
		<b>INT COMP TO EXIT + = -</b>			
		<b>INSPECTED BY</b>	18th		
		<b>DATE INSPECTED</b>	3/15/06		

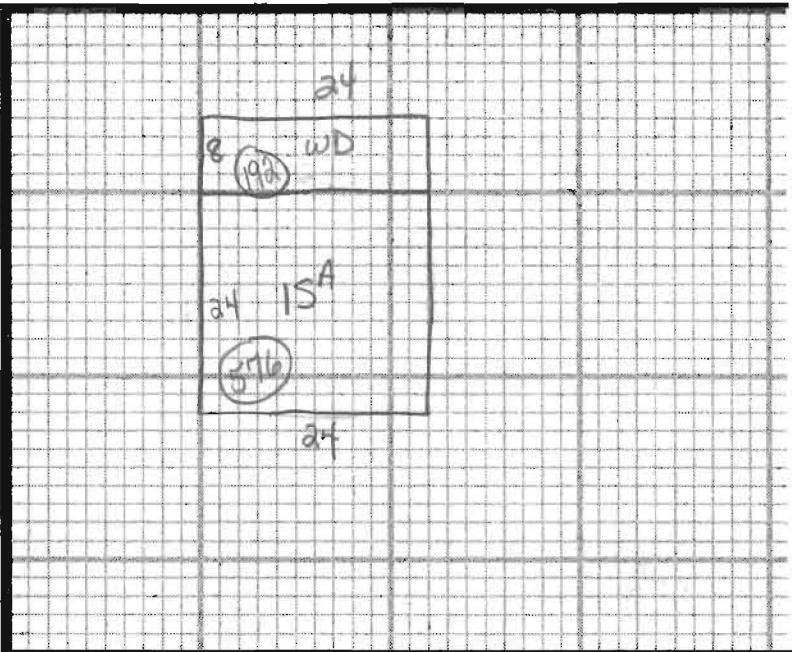

ADDITIONS, OUTBUILDINGS & IMPROVEMENTS						PERCENT GOOD		CODES
	TYPE	YEAR	UNITS	GRADE	COND	Phys.	Funct.	
ISA	1		576			___ %	___ %	1. 1S Fr.
WD	68		192			___ %	___ %	2. 2S Fr.
SHED	24		80			___ %	___ %	3. 3S Fr.
						___ %	___ %	4. 1 1/2S Fr.
						___ %	___ %	5. 1 3/4S Fr.
						___ %	___ %	6. 2 1/2S Fr.
						___ %	___ %	Add 10 for Bsmt
						___ %	___ %	21. OFP
						___ %	___ %	22. EFP
						___ %	___ %	23. Garage
						___ %	___ %	24. Shed
						___ %	___ %	25. Bay Window
						___ %	___ %	26. Overhang
						___ %	___ %	27. Unf. Bsmt
						___ %	___ %	28. Unf. Attic
						___ %	___ %	29. Fin. Attic
						___ %	___ %	Add 20 for 2-Story
						___ %	___ %	61. Carport
						___ %	___ %	62. Patio
						___ %	___ %	63. Swimming Pool
						___ %	___ %	64. Tennis Court
						___ %	___ %	65. Stable w/loft
						___ %	___ %	66. Greenhouse
						___ %	___ %	67. Natatorium
						___ %	___ %	68. Wood Deck
						___ %	___ %	69. Jacuzzi

PHOTO

new windows