

MAP 17 LOT 4-8

ACCOUNT NO.

4698

ADDRESS

TOWN OF WATERBORO, MAINE

CARD NO.

OF

NH ✓

017-004-008

BERUBE NORMAND BLDRS

7 RENE CIRCLE

PROPERTY DATA

NEIGHBORHOOD CODE

STREET CODE

LAND USE

- 11. Residential
- 21. Village
- 22. Village/Res.
- 31. Agricultural/Res.
- 33. Forest/Agri.
- 40. Conservation
- 45. General Purpose
- 48. Shoreland
- 49. Resource Protection

SECONDARY ZONE

TOPOGRAPHY

- 1. Level
- 2. Rolling
- 3. Above St.
- 4. Below St.
- 5. Low
- 6. Swampy
- 7. Steep
- 8.

UTILITIES

- 1. All Public
- 2. Public Water
- 3. Public Sewer
- 4. Drilled Well
- 5. Dug Well
- 6. Septic
- 7. Cess Pool
- 9. No Utilities

STREET

- 1. Paved
- 2. Semi-Improved
- 3. Gravel
- 4. Proposed
- 9. No Street

SALE DATA

DATE(MM/YY)

PRICE

SALE TYPE

- 1. Land
- 2. Land & Bldg.
- 3. Building Only
- 4. Mobile Home
- 5. Other

FINANCING

- 1. Conv.
- 2. FHA/VA
- 3. Assumed
- 4. Seller
- 5. Private
- 6. Cash
- 7. FMHA
- 9. Unknown

VERIFIED

- 1. Buyer
- 2. Seller
- 3. Lender
- 4. Agent
- 5. Record
- 6. MLS
- 7. Family
- 8. Other
- 9. Confid.

VALIDITY

- 1. Valid
- 2. Related
- 3. Distress
- 4. Split
- 5. Partial
- 6. Exempt
- 7. Changed
- 8. Other

BOOK

PAGE

DATE

CONSIDERATION

ASSESSMENT RECORD

YEAR

LAND

BUILDINGS

EXEMPT

TOTAL

LAND DATA

TYPE

EFFECTIVE

Frontage

Depth

INFLUENCE

Factor

Code

INFLUENCE CODES

- FRONT FOOT
- 11. Regular Lot
- 12. Delta Triangle
- 13. Nabla Triangle
- 14. Rear Land
- 15.

- SQUARE FOOT
- 16. Regular Lot
- 17. Secondary
- 18. Excess Land
- 19. Condo.
- 20.

- FRACT. ACRE
- 21. Homesite
- 22. Basemat
- 23.

- ACRES
- 24. Homesite
- 25. Basemat
- 26. Secondary
- 27. Frontage
- 28. Rear 1
- 29. Rear 2
- 30. Rear 3
- 31. Tillable
- 32. Pasture
- 33. Orchard

Total

- 1=Vacancy
- 2=Excess Frontage
- 3=Topography
- 4=Size/Shape
- 5=Access
- 6=Restrictions
- 7=Corner
- 8=Environment
- 9=Fractional Share

- ACRES (cont.)
- 34. Softwood (F&O)
- 35. Mixed Wood (F&O)
- 36. Hardwood (F&O)
- 37. Softwood (T.G.)
- 38. Mixed Wood (T.G.)
- 39. Hardwood (T.G.)
- 40. Waste
- 41. Gravel Pit

- SITE
- 42. Moho Site
- 43. Condo Site
- 44. Lot Improvements

No./Date Description Date Insp.

NOTES: 4/08 RENE CIRCLE

BUILDING RECORD

MAP LOT ACCOUNT NO. 4698 ADDRESS CARD NO. OF

Main building record table with categories: BUILDING STYLE, DWELLING UNITS, OTHER UNITS, STORIES, EXTERIOR WALLS, ROOF SURFACE, S/F MASONRY TRIM, YEAR BUILT, YEAR REMODELED, FOUNDATION, BASEMENT, BSMT GAR # CARS, WET BASEMENT, S/F BSMT LIVING, FIN BSMT GRADE, HEAT TYPE, COOL TYPE, KITCHEN STYLE, BATH(S) STYLE, # ROOMS, # BEDROOMS, # FULL BATHS, # HALF BATHS, # ADDN FIXTURES, # FIREPLACES, # HEARTHES, LAYOUT, ATTIC, INT COMP TO EXIT + = -, INSPECTED BY, DATE INSPECTED, INSULATION, UNFINISHED %, GRADE & FACTOR, SQ. FOOTAGE, CONDITION, PHYS. % GOOD, FUNCT. % GOOD, ECON. % GOOD, ENTRANCE CODE, INFO. CODE.

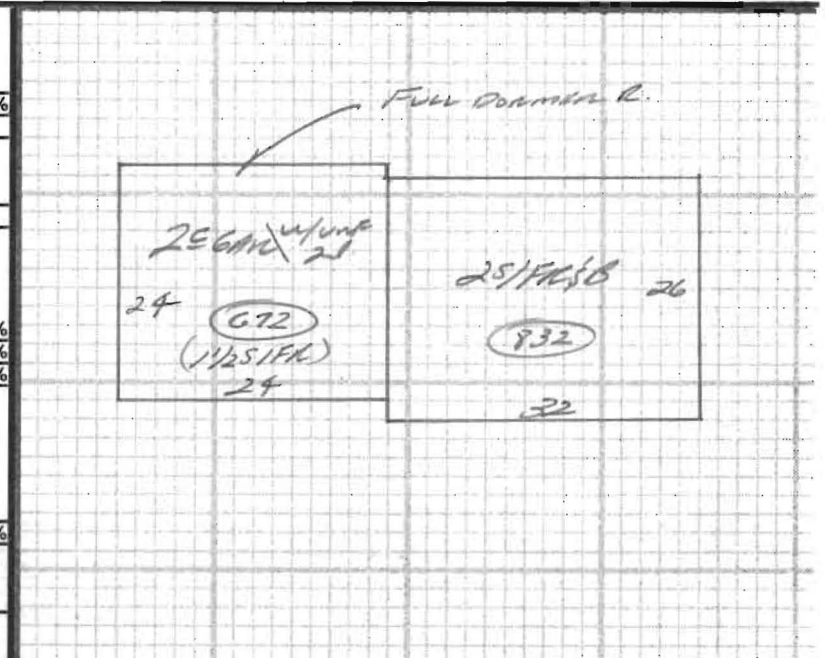

ADDITIONS, OUTBUILDINGS & IMPROVEMENTS

CODES

Table for tracking additions and improvements. Columns: TYPE, YEAR, UNITS, GRADE, COND, PERCENT GOOD (Phys., Funct.). Includes a handwritten entry: TYPE: GAR w/ump # 47, YEAR: 2007, UNITS: G72, GRADE: 3+.

- 1. 1S Fr.
2. 2S Fr.
3. 3S Fr.
4. 1 1/2S Fr.
5. 1 3/4S Fr.
6. 2 1/2S Fr.
Add 10 for Bsmt
21. OFF
22. EFP
23. Garage
24. Shed
25. Bay Window
26. Overhang
27. Unf. Bsmf
28. Unf. Attic
29. Fin. Attalc
Add 20 for 2 Story
61. Carport
62. Patio
63. Swimming Pool
64. Tennis Court
65. Stable w/loft
66. Greenhouse
67. Natatorium
68. Wood Deck
69. Jacuzzi

PHOTO

NOTES: NH CO 10/15/09 [Signature]