

BUILDING RECORD

MAP 012 LOT 008 002 ACCOUNT NO. 01374 ADDRESS 226 Thynor Mill Rd. CARD NO. OF

BUILDING STYLE 1. Conv. 6. Split Lev. 2. Ranch 7. Contemp. 3. R. Ranch 8. Log 4. Cape 9. Other 5. Garrison	MH 9*	S/F BSMT LIVING FIN BSMT GRADE		INSULATION 1. Full 4. Minimal 2. Heavy 9. None 3. Capped	1
DWELLING UNITS		HEAT TYPE 1. HW BB 6. Grav. WA 2. HW CI 7. Electric 3. HW Radiant 8. Units 4. Steam 9. No Heat 5. FWA	1	UNFINISHED %	%
OTHER UNITS		COOL TYPE 1. Central 9. None	9	GRADE & FACTOR 1. E 4. B 2. D 5. A 3. C 6. AA	3
STORIES 1. One 4. 1 1/2 2. Two 5. 1 3/4 3. Three 6. 2 1/2	1	KITCHEN STYLE 1. Good 3. Old Style 2. Typical 4. Obsolete	2	SQ. FOOTAGE CONDITION 1. Poor 5. Avg + 2. Fair 6. Good 3. Avg - 7. V Good 4. Avg. 8. Exc.	4
EXTERIOR WALLS 1. Clapboard 6. BR/Stone 2. WD.SH. 7. Novelty 3. Comp. 8. AL/Minyl 4. ASB/ASP 9. Other 5. T1-11	8	BATH(S) STYLE 1. Good 3. Old Style 2. Typical 4. Obsolete	2	PHYS. % GOOD	%
ROOF SURFACE 1. Asphalt 4. Comp. 2. Slate 5. Wood 3. Metal 6. Other	1	# ROOMS # BEDROOMS # FULL BATHS # HALF BATHS # ADDN FIXTURES	5 2 1	FUNCT. % GOOD	%
S/F MASONRY TRIM		# FIREPLACES # HEARTHES		FUNCT. CODE 1. Incomp. 5. CDU 2. Overbuilt 6. Style 3. Delap. 7. Layout 4. Small Size 8. Other 9. None	9
YEAR BUILT	1997	LAYOUT 1. Typical 2. In adeq.	1	ECON. % GOOD	%
YEAR REMODELED		ATTIC 1. 1/4 Fin 4. Full Fin. 2. 1/2 Fin. 5. Fl/Stairs 3. 3/4 Fin. 9. None	9	ECON. CODE 1. Location 3. Services 2. Encroach 9. None	9
FOUNDATION 1. Conc. 4. Wood 2. C Blk 5. Slab 3. Br./Stone 6. Piers	5	INT COMP TO EXIT + = -		ENTRANCE CODE 1. Inspt. 3. Vacant 2. Refused 5. Estim. 3. Info Only	5
BASEMENT 1. 1/4 3. 3/4 5. Crawl 2. 1/2 4. Full 6. None	6	INSPECTED BY	JMC	INFO. CODE 1. Owner 4. Agent 2. Relative 5. Estimate 3. Tenant 6. Other 2. Refused 5. Estim.	5
BSMT GAR # CARS		DATE INSPECTED	12.15.05		
WET BASEMENT 1. Dry 3. Wet 2. Damp 9. None	9				

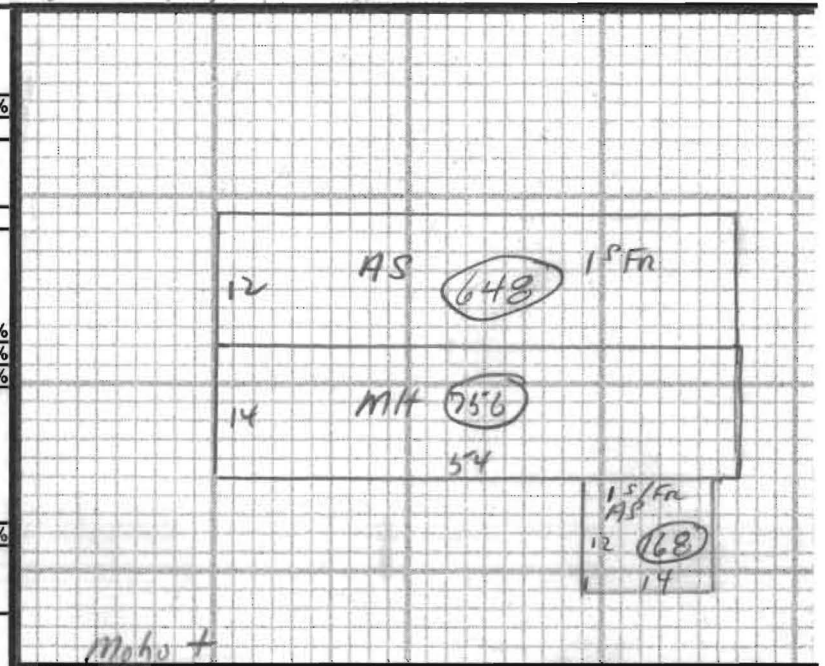

12 15 - 05 0027

ADDITIONS, OUTBUILDINGS & IMPROVEMENTS

	TYPE	YEAR	UNITS	GRADE	COND	PERCENT GOOD		CODES
						Phys.	Funct.	
ADD	001		648	3.	4	%	%	1. 1S Fr.
ADD	001		168	3.	4	%	%	2. 2S Fr.
Shed	024		256	3.	3	%	%	3. 3S Fr.
* MOHO	99B	1997	756	3.	4	%	%	4. 1 1/2S Fr.
						%	%	5. 1 3/4S Fr.
						%	%	6. 2 1/2S Fr.
						%	%	Add 10 for Bsmt
						%	%	21. OFP
						%	%	22. EFP
						%	%	23. Garage
						%	%	24. Shed
						%	%	25. Bay Window
						%	%	26. Overhang
						%	%	27. Unf. Bsmt
						%	%	28. Unf. Attic
						%	%	29. Fin. Attic
						%	%	Add 20 for 2 Story
						%	%	61. Carport
						%	%	62. Patio
						%	%	63. Swimming Pool
						%	%	64. Tennis Court
						%	%	65. Stable w/loft
						%	%	66. Greenhouse
						%	%	67. Natatorium
						%	%	68. Wood Deck
						%	%	69. Jacuzzi

PHOTO

NOTES: * Full finished Attached Porch 648 + 168 ADDITIONS.