

MAP LOT

ACCOUNT NO.

117

ADDRESS

TOWN OF WATERBORO, MAINE

CARD NO.

OF

008-020

CYR MARK A & BETH M  
26 LOTS A ROCK  
B 7311 P 259

PROPERTY DATA

NEIGHBORHOOD CODE 44

STREET CODE

LAND USE

11. Residential  
21. Village  
22. Village/Res.  
31. Agricultural/Res.  
33. Forest/Agri.  
40. Conservation  
45. General Purpose  
48. Shoreland  
49. Resource Protection  
31

SECONDARY ZONE

TOPOGRAPHY

1. Level 5. Low  
2. Rolling 6. Swampy  
3. Above St. 7. Steep  
4. Below St. 8.  
02

UTILITIES

1. All Public 5. Dug Well  
2. Public Water 6. Septic  
3. Public Sewer 7. Cess Pool  
4. Drilled Well 9. No Utilities  
09

STREET

1. Paved 4. Proposed  
2. Semi-Improved  
3. Gravel 9. No Street  
1

SALE DATA

DATE(MMYY)

PRICE

SALE TYPE

1. Land 4. Mobile  
2. Land & Bldg. Home  
3. Building Only 5. Other

FINANCING

1. Conv. 5. Private  
2. FHA/VA 6. Cash  
3. Assumed 7. FMHA  
4. Seller 9. Unknown

VERIFIED

1. Buyer 6. MLS  
2. Seller 7. Family  
3. Lender 8. Other  
4. Agent 9. Confid.  
5. Record

VALIDITY

1. Valid 5. Partial  
2. Related 6. Exempt  
3. Distress 7. Changed  
4. Split 8. Other

BOOK PAGE DATE CONSIDERATION

Table with 4 columns: BOOK, PAGE, DATE, CONSIDERATION. All cells are empty.

ASSESSMENT RECORD

Table with 5 columns: YEAR, LAND, BUILDINGS, EXEMPT, TOTAL. All cells are empty.

LAND DATA

Table with columns: TYPE, EFFECTIVE (Frontage, Depth), INFLUENCE (Factor, Code), INFLUENCE CODES. Includes lists for FRONT FOOT, SQUARE FOOT, and FRACT. ACRE.

Table with 3 columns: No./Date, Description, Date Insp. All cells are empty.

NOTES:

ACRES (cont.)  
34. Softwood (F&O)  
35. Mixed Wood (F&O)  
36. Hardwood (F&O)  
37. Softwood (T.G.)  
38. Mixed Wood (T.G.)  
39. Hardwood (T.G.)  
40. Waste  
41. Gravel Pit  
SITE  
42. Moho Site  
43. Condo Site  
44. Lot Improvements

TOWN OF WATERBORO, MAINE

MAP 8 LOT 020 ACCOUNT NO. 817 BUILDING RECORD ADDRESS 26 LOT A ROCK RD. CARD NO. OF

|                         |               |                        |              |                           |             |
|-------------------------|---------------|------------------------|--------------|---------------------------|-------------|
| <b>BUILDING STYLE</b>   |               | <b>S/F BSMT LIVING</b> |              | <b>INSULATION</b>         |             |
| 1. Conv.                | 6. Split Lev. | <b>FIN BSMT GRADE</b>  |              | 1. Full                   | 4. Minimal  |
| 2. Ranch                | 7. Contemp.   |                        |              | 2. Heavy                  | 9. None     |
| 3. R. Ranch             | 8. Log        |                        |              | 3. Capped                 |             |
| 4. Cape                 | 9. Other      |                        |              | <b>UNFINISHED %</b>       |             |
| 5. Garrison             |               |                        |              | %                         |             |
| <b>DWELLING UNITS</b>   |               | <b>HEAT TYPE</b>       |              | <b>GRADE &amp; FACTOR</b> |             |
|                         |               | 1. HW BB               | 6. Grav. WA  | 1. E                      | 4. B        |
|                         |               | 2. HW CI               | 7. Electric  | 2. D                      | 5. A        |
|                         |               | 3. HW Radiant          | 8. Units     | 3. C                      | 6. AA       |
|                         |               | 4. Steam               | 9. No Heat   |                           |             |
|                         |               | 5. FWA                 |              |                           |             |
| <b>OTHER UNITS</b>      |               | <b>COOL TYPE</b>       |              | <b>SQ. FOOTAGE</b>        |             |
|                         |               | 1. Central             | 9. None      | 783                       |             |
| <b>STORIES</b>          |               |                        |              | <b>CONDITION</b>          |             |
| 1. One                  | 4. 1 1/2      |                        |              | 1. Poor                   | 5. Avg +    |
| 2. Two                  | 5. 1 3/4      |                        |              | 2. Fair                   | 6. Good     |
| 3. Three                | 6. 2 1/2      |                        |              | 3. Avg -                  | 7. V Good   |
|                         |               |                        |              | 4. Avg.                   | 8. Exc.     |
|                         |               |                        |              | %                         |             |
| <b>EXTERIOR WALLS</b>   |               | <b>KITCHEN STYLE</b>   |              | <b>PHYS. % GOOD</b>       |             |
| 1. Clapboard            | 6. BR./Stone  | 1. Good                | 3. Old Style | %                         |             |
| 2. WD.SH.               | 7. Novelty    | 2. Typical             | 4. Obsolete  | <b>FUNCT. % GOOD</b>      |             |
| 3. Comp.                | 8. AL/Vinyl   |                        |              | %                         |             |
| 4. ASB/ASP              | 9. Other      |                        |              | <b>FUNCT. CODE</b>        |             |
| 5. T1-11                |               |                        |              | 1. Incomp.                | 5. CDU      |
| <b>ROOF SURFACE</b>     |               | <b>BATH(S) STYLE</b>   |              | 2. Overbuilt              | 6. Style    |
| 1. Asphalt              | 4. Comp.      | 1. Good                | 3. Old Style | 3. Delap.                 | 7. Layout   |
| 2. Slate                | 5. Wood       | 2. Typical             | 4. Obsolete  | 4. Small Size             | 8. Other    |
| 3. Metal                | 6. Other      |                        |              | 9. None                   |             |
| <b>S/F MASONRY TRIM</b> |               | <b># ROOMS</b>         |              | <b>ECON. % GOOD</b>       |             |
|                         |               | 2                      |              | %                         |             |
| <b>YEAR BUILT</b>       |               | <b># BEDROOMS</b>      |              | <b>ECON. CODE</b>         |             |
| 1974                    |               | 2                      |              | 1. Location               | 3. Services |
| <b>YEAR REMODELED</b>   |               | <b># FULL BATHS</b>    |              | 2. Encroach               | 9. None     |
|                         |               | 1                      |              |                           |             |
| <b>FOUNDATION</b>       |               | <b># HALF BATHS</b>    |              | <b>ENTRANCE CODE</b>      |             |
| 1. Conc.                | 4. Wood       | 1                      |              | 1. Inspct.                | 3. Vacant   |
| 2. C Blk                | 5. Stab       |                        |              | 2. Refused                | 5. Estim.   |
| 3. Br./Stone            | 6. Piers      |                        |              | 3. Info Only              |             |
| <b>BASEMENT</b>         |               | <b># ADDN FIXTURES</b> |              | <b>INFO. CODE</b>         |             |
| 1. 1/4                  | 3. 3/4        | 1                      |              |                           |             |
| 2. 1/2                  | 4. Full       |                        |              |                           |             |
|                         |               |                        |              |                           |             |
| <b>BSMT GAR # CARS</b>  |               | <b># FIREPLACES</b>    |              | <b>1. Owner</b>           |             |
| 1                       |               | 1                      |              | 4. Agent                  |             |
| <b>WET BASEMENT</b>     |               | <b># HEARTHES</b>      |              | 2. Relative               |             |
| 1. Dry                  | 3. Wet        | 1                      |              | 5. Estimate               |             |
| 2. Damp                 | 9. None       |                        |              | 3. Tenant                 |             |
|                         |               |                        |              | 6. Other                  |             |
|                         |               |                        |              | 2. Refused                |             |
|                         |               |                        |              | 5. Estim.                 |             |

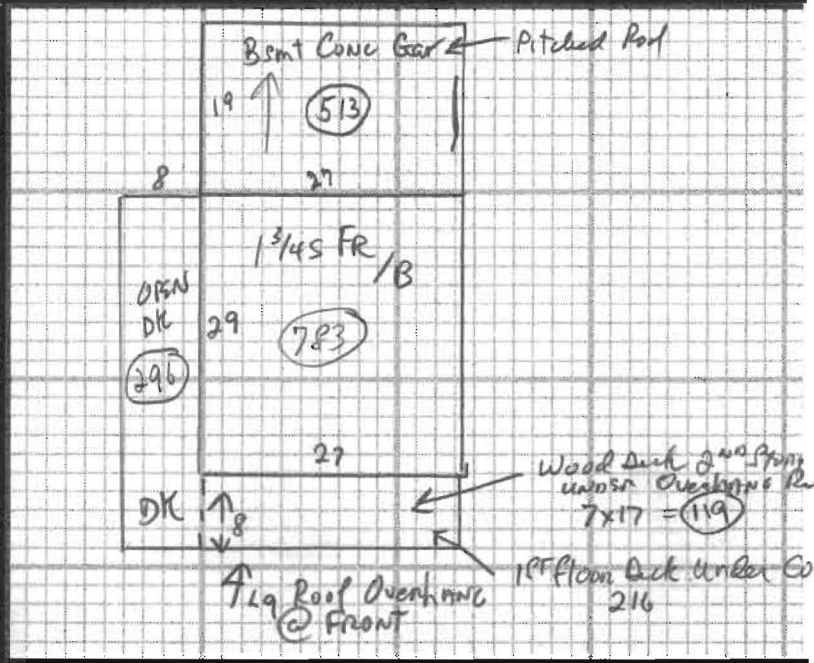

| ADDITIONS, OUTBUILDINGS & IMPROVEMENTS |      |       |       |      |       | PERCENT GOOD |                    | CODES |
|--|------|-------|-------|------|-------|--------------|--------------------|-------|
| TYPE                                   | YEAR | UNITS | GRADE | COND | Phys. | Funct.       |                    |       |
| GAR*                                   | 023  | 513   | 3     | 5    | %     | %            | 1. 1S Fr.          |       |
| Dk.                                    | 068  | 296   | 3     | 5    | %     | %            | 2. 2S Fr.          |       |
| **DK 2 <sup>nd</sup>                   | 068  | 119   | 3     | 5    | %     | %            | 3. 3S Fr.          |       |
|  |      |       |       |      |       |              | 4. 1 1/2S Fr.      |       |
|  |      |       |       |      |       |              | 5. 1 3/4S Fr.      |       |
|  |      |       |       |      |       |              | 6. 2 1/2S Fr.      |       |
|  |      |       |       |      |       |              | Add 10 for Bsm't   |       |
|  |      |       |       |      |       |              | 21. OFP            |       |
|  |      |       |       |      |       |              | 22. EFP            |       |
|  |      |       |       |      |       |              | 23. Garage         |       |
|  |      |       |       |      |       |              | 24. Shed           |       |
|  |      |       |       |      |       |              | 25. Bay Window     |       |
|  |      |       |       |      |       |              | 26. Overhang       |       |
|  |      |       |       |      |       |              | 27. Unf. Bsm't     |       |
|  |      |       |       |      |       |              | 28. Unf. Attic     |       |
|  |      |       |       |      |       |              | 29. Fin. Attic     |       |
|  |      |       |       |      |       |              | Add 20 for 2 Story |       |
|  |      |       |       |      |       |              | 61. Carport        |       |
|  |      |       |       |      |       |              | 62. Patio          |       |
|  |      |       |       |      |       |              | 63. Swimming Pool  |       |
|  |      |       |       |      |       |              | 64. Tennis Court   |       |
|  |      |       |       |      |       |              | 65. Stable w/loft  |       |
|  |      |       |       |      |       |              | 66. Greenhouse     |       |
|  |      |       |       |      |       |              | 67. Natatorium     |       |
|  |      |       |       |      |       |              | 68. Wood Deck      |       |
|  |      |       |       |      |       |              | 69. Jacuzzi        |       |

PHOTO  
10.19.05 041

NOTES: \* GAMBLE # OR OFF?