

MAP

LOT

ACCOUNT NO. 234

ADDRESS

TOWN OF WATERBORO, MAINE

CARD NO. OF

006
600
4/1/02

003-60A

COOMBS HERBERT S & CAROLE TRUSTEES
167 MIDDLE ROAD
B 7640 P 92

PROPERTY DATA

NEIGHBORHOOD CODE 65

STREET CODE

LAND USE

- 11. Residential
 - 21. Village
 - 22. Village/Res.
 - 31. Agricultural/Res.
 - 33. Forest/Agri.
 - 40. Conservation
 - 45. General Purpose
 - 48. Shoreland
 - 49. Resource Protection
- 33

SECONDARY ZONE

TOPOGRAPHY

- 1. Level
 - 2. Rolling
 - 3. Above St.
 - 4. Below St.
 - 5. Low
 - 6. Swampy
 - 7. Steep
 - 8.
- 03

UTILITIES

- 1. All Public
 - 2. Public Water
 - 3. Public Sewer
 - 4. Drilled Well
 - 5. Dug Well
 - 6. Septic
 - 7. Cess Pool
 - 9. No Utilities
- 09

STREET

- 1. Paved
 - 2. Semi-Improved
 - 3. Gravel
 - 4. Proposed
 - 9. No Street
- 1

SALE DATA

DATE(MM/YY)

PRICE

SALE TYPE

- 1. Land
- 2. Land & Bldg.
- 3. Building Only
- 4. Mobile Home
- 5. Other

FINANCING

- 1. Conv.
- 2. FHA/VA
- 3. Assumed
- 4. Seller
- 5. Private
- 6. Cash
- 7. FMHA
- 9. Unknown

VERIFIED

- 1. Buyer
- 2. Seller
- 3. Lender
- 4. Agent
- 5. Record
- 6. MLS
- 7. Family
- 8. Other
- 9. Confid.

VALIDITY

- 1. Valid
- 2. Related
- 3. Distress
- 4. Split
- 5. Partial
- 6. Exempt
- 7. Changed
- 8. Other

| BOOK | PAGE | DATE | CONSIDERATION |
|------|------|------|---------------|
| | | | |
| | | | |
| | | | |
| | | | |

ASSESSMENT RECORD

| YEAR | LAND | BUILDINGS | EXEMPT | TOTAL |
|------|--------|-----------|--------|---------|
| 08 | 96,200 | 322,500 | | 418,700 |
| 09 | 96,200 | 304,200 | | 400,400 |
| | | | | |
| | | | | |
| | | | | |

LAND DATA

| TYPE | EFFECTIVE | | INFLUENCE | | INFLUENCE CODES |
|--------------------|---------------|-------|-----------|------|-----------------|
| | Frontage | Depth | Factor | Code | |
| FRONT FOOT | | | | | |
| 11. Regular Lot | | | | | |
| 12. Delta Triangle | | | | | |
| 13. Nabla Triangle | | | | | |
| 14. Rear Land | | | | | |
| 15. | | | | | |
| SQUARE FOOT | SQUARE FEET | | | | |
| 16. Regular Lot | | | | | |
| 17. Secondary | | | | | |
| 18. Excess Land | | | | | |
| 19. Condo. | | | | | |
| 20. | | | | | |
| FRACT. ACRE | ACREAGE/SITES | | | | |
| 21. Homesite | | | | | |
| 22. Baselit | | | | | |
| 23. | | | | | |
| ACRES | | | | | |
| 24. Homesite | | | | | |
| 25. Baselit | | | | | |
| 26. Secondary | | | | | |
| 27. Frontage | | | | | |
| 28. Rear 1 | | | | | |
| 29. Rear 2 | | | | | |
| 30. Rear 3 | | | | | |
| 31. Tillable | | | | | |
| 32. Pasture | | | | | |
| 33. Orchard | | | | | |
| Total | | | | | |

- 1=Vacancy
 - 2=Excess Frontage
 - 3=Topography
 - 4=Size/Shape
 - 5=Access
 - 6=Restrictions
 - 7=Corner
 - 8=Environment
 - 9=Fractional Share
- ACRES (cont.)
- 34. Softwood (F&O)
 - 35. Mixed Wood (F&O)
 - 36. Hardwood (F&O)
 - 37. Softwood (T.G.)
 - 38. Mixed Wood (T.G.)
 - 39. Hardwood (T.G.)
 - 40. Waste
 - 41. Gravel Pit
- SITE
- 42. Moho Site
 - 43. Condo Site
 - 44. Lot Improvements

| No./Date | Description | Date Insp. |
|----------|-------------|------------|
| | | |
| | | |
| | | |
| | | |
| | | |

NOTES: No pmt will be addt.
 best view house of garage 3.27.06
 call GARAGE 4/1/02 R
 6/10/07 TRAV 1st Fall + Comb. Com - can't tell
 if go up in living area, P.U. 2nd car
 in woods 1256 ft, CHANGE ft OF LEFT
 ADDITION TO 480 ft
 *BLOB REVISIT COMA 2/1/08 MET
 ADD. Part Report. R

BUILDING RECORD

MAP 3 LOT 60 A ACCOUNT NO. 234 ADDRESS _____

CARD NO. ____ OF ____

| | | | | | | |
|-------------------------|---------------|-------------------------------|--------------|---------------------------|-------------|-----|
| BUILDING STYLE | | S/F BSMT LIVING | 0 | INSULATION | | |
| 1. Conv. | 6. Split Lev. | FIN BSMT GRADE | | 1. Full | 4. Minimal | 1 |
| 2. Ranch | 7. Contemp. | | | 2. Heavy | 9. None | |
| 3. R. Ranch | 8. Log | HEAT TYPE | | 3. Capped | | |
| 4. Cape | 9. Other | 1. HW BB | 6. Grav. WA | UNFINISHED % | | |
| 5. Garrison | | 2. HW CI | 7. Electric | GRADE & FACTOR | | 110 |
| DWELLING UNITS | | 3. HW Radiant | 8. Units | 1. E | 4. B | 3 |
| OTHER UNITS | | 4. Steam | 9. No Heat | 2. D | 5. A | |
| STORIES | | 5. FWA | | 3. C | 6. AA | |
| 1. One | 4. 1 1/2 | COOL TYPE | | SQ. FOOTAGE | | 864 |
| 2. Two | 5. 1 3/4 | 1. Central | 9. None | CONDITION | | |
| 3. Three | 6. 2 1/2 | | | 1. Poor | 5. Avg + | 5 |
| EXTERIOR WALLS | | KITCHEN STYLE | | 2. Fair | 6. Good | |
| 1. Clapboard | 6. BR./Stone | 1. Good | 3. Old Style | 3. Avg - | 7. V Good | |
| 2. WD.SH. | 7. Novelty | 2. Typical | 4. Obsolete | 4. Avg. | 8. Exc. | |
| 3. Comp. | 8. AL/Vinyl | BATH(S) STYLE | | PHYS. % GOOD | | |
| 4. ASB/ASP | 9. Other | 1. Good | 3. Old Style | FUNCT. % GOOD | | |
| 5. T1-11 | | 2. Typical | 4. Obsolete | FUNCT. CODE | | |
| ROOF SURFACE | | # ROOMS | | 1. Incomp. | 5. CDU | 9 |
| 1. Asphalt | 4. Comp. | # BEDROOMS | 3 | 2. Overbuilt | 6. Style | |
| 2. Slate | 5. Wood | # FULL BATHS | 2 | 3. Delap. | 7. Layout | |
| 3. Metal | 6. Other | # HALF BATHS | | 4. Small Size | 8. Other | |
| S/F MASONRY TRIM | | # ADDN FIXTURES | | ECON. % GOOD | | |
| YEAR BUILT | | # FIREPLACES | 1 | ECON. CODE | | |
| YEAR REMODELED | | # HEARTHES | | 1. Location | 3. Services | 9 |
| FOUNDATION | | LAYOUT | 1 | 2. Encroach | 9. None | |
| 1. Conc. | 4. Wood | 1. Typical | 2. In adeg. | ENTRANCE CODE | | |
| 2. C Blk | 5. Slab | ATTIC | | 1. Inspct. | 3. Vacant | 1 |
| 3. Br./Stone | 6. Piers | 1. 1/4 Fin | 4. Full Fin. | 2. Refused | 5. Estim. | |
| BASEMENT | | 2. 1/2 Fin. | 5. Fl/Stairs | INFO. CODE | | |
| 1. 1/4 | 3. 3/4 | 3. 3/4 Fin. | 9. None | 1. Owner | 4. Agent | 1 |
| 2. 1/2 | 4. Full | INT COMP TO EXIT + - - | | 2. Relative | 5. Estimate | |
| BSMT GAR # CARS | | INSPECTED BY | 222 OK JLD | 3. Tenant | 6. Other | |
| WET BASEMENT | | DATE INSPECTED | JMC 11/20/05 | 2. Refused | 5. Estim. | |
| 1. Dry | 3. Wet | | | | | |
| 2. Damp | 9. None | | | | | |

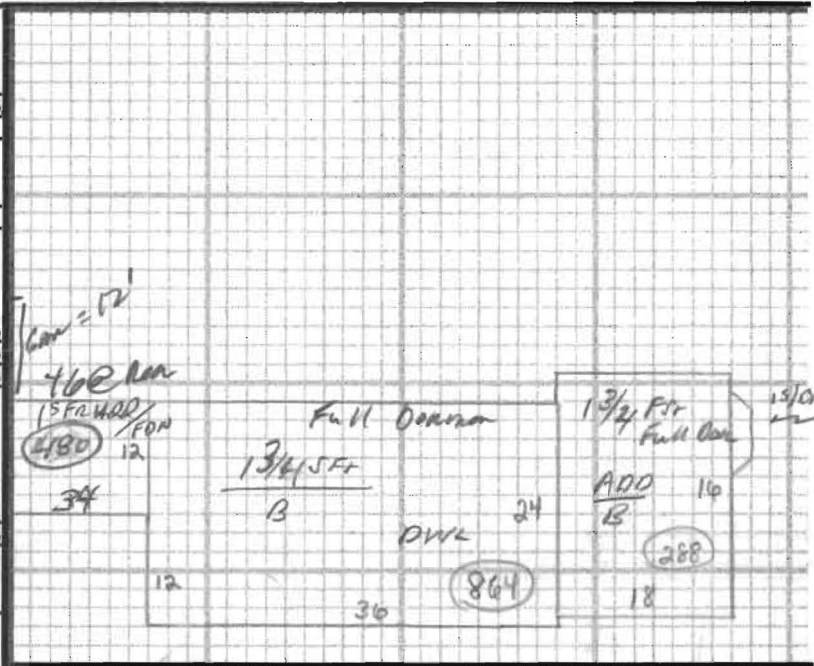

R 992-993

| ADDITIONS, OUTBUILDINGS & IMPROVEMENTS | | | | | | PERCENT GOOD | | CODES |
|--|------|-------|-------|------|-------|--------------|-----|--------------------|
| TYPE | YEAR | UNITS | GRADE | COND | Phys. | Funct. | | |
| DWL | 04 | 1975 | 864 | 3+ | 5 | --- | --- | 1. 1S Fr. |
| ADD | 04 | 1986 | 288 | | 7 | --- | --- | 2. 2S Fr. |
| 15 FR ADD | 06 | 2006 | 480 | 3+ | 5 | --- | --- | 3. 3S Fr. |
| GARAGE | 49 | 2006 | 1320 | 3. | 5 | --- | --- | 4. 1 1/2S Fr. |
| BSMT | 27 | 1996 | 288 | 3. | | --- | --- | 5. 1 3/4S Fr. |
| Sq. Gar | 23 | 2005 | 1296 | 3+ | 5 | --- | 80% | 6. 2 1/2S Fr. |
| BSMT | 27 | 2006 | 480 | 4.0 | 5 | --- | --- | Add 10 for Bsmt |
| | | | | | | --- | --- | 21. OFF |
| | | | | | | --- | --- | 22. EFP |
| | | | | | | --- | --- | 23. Garage |
| | | | | | | --- | --- | 24. Shed |
| | | | | | | --- | --- | 25. Bay Window |
| | | | | | | --- | --- | 26. Overhang |
| | | | | | | --- | --- | 27. Unf. Bsmt |
| | | | | | | --- | --- | 28. Unf. Attic |
| | | | | | | --- | --- | 29. Fin. Attic |
| | | | | | | --- | --- | Add 20 for 2 Story |
| | | | | | | --- | --- | 61. Carport |
| | | | | | | --- | --- | 62. Patio |
| | | | | | | --- | --- | 63. Swimming Pool |
| | | | | | | --- | --- | 64. Tennis Court |
| | | | | | | --- | --- | 65. Stable w/loft |
| | | | | | | --- | --- | 66. Greenhouse |
| | | | | | | --- | --- | 67. Natatorium |
| | | | | | | --- | --- | 68. Wood Deck |
| | | | | | | --- | --- | 69. Jacuzzi |

PHOTO

NOTES: GARAGE - GAMBREL ROOF W 30 x 44