

BEVERAGE JUDITH J  
BEVERAGE, ROGER W  
8 CRYSTAL LANE  
N WATERBORO ME 04061

B5298P167 B15873P740 B16872P44

Previous Owner  
BEVERAGE, JUDITH  
BEVERAGE, ROGER  
8 CRYSTAL LANE  
N WATERBORO ME 04061  
Sale Date: 8/13/2014

Previous Owner  
NOBLE SHANNON C & DALE E METCALF JR  
C/O JACOB & HEATHER TURCOTTE  
8 CRYSTAL LANE  
N WATERBORO ME 04061  
Sale Date: 5/28/2010

Previous Owner  
LUMB WILLIAM  
87 STAR HILL ROAD

WATERBORO ME 04087 3300  
Sale Date: 3/19/2007

Inspection Witnessed By:

X	Date	Date Insp.
No./Date	Description	Date Insp.

Notes:

Property Data		
Neighborhood	1 LAC WEST	
Tree Growth Year	0	
1ST MORTGAGE	0	
2ND MORTGAGE	0	
Zone/Land Use	47 Lake Arrowhead	
Secondary Zone		
Topography	2 Rolling	
1.Level	4.Below St	7.Steep
2.Rolling	5.Low	8.Wet
3.Above St	6.Swampy	9.Lev/Roll
Utilities	9 No Water/No Sewer	
1.Public	4.Improve	7.Improve
2.Water	5.Improve	8.
3.Sewer	6.Improve	9.None
Street	3 Gravel	
1.Paved	4.Proposed	7.ROW
2.Semi Imp	5.Pvt	8.None
3.Gravel	6.Aband	9.TG PLAN
LAND USE	0	
BUILDING USE	0	
Sale Data		
Sale Date	8/13/2014	
Price	175,000	
Sale Type	2 Land & Buildings	
1.Land	4.Mobile	7.
2.L & B	5.Other	8.
3.Building	6.	9.
Financing	1 Conventional	
1.Convent	4.Seller	7.
2.FHA/VA	5.Private	8.
3.Assumed	6.Cash	9.Unknown
Validity	1 Arms Length Sale	
1.Valid	4.Split	7.Renovate
2.Related	5.Partial	8.Other
3.Distress	6.Exempt	9.
Verified	5 Public Record	
1.Buyer	4.Agent	7.Family
2.Seller	5.Pub Rec	8.Other
3.Lender	6.MLS	9.

Assessment Record				
Year	Land	Buildings	Exempt	Total
2012	30,000	140,200	0	170,200
2013	30,000	140,200	0	170,200
2014	30,000	140,200	0	170,200
2015	30,000	140,200	0	170,200
2016	15,000	141,900	0	156,900
2017	15,000	141,900	0	156,900
2018	15,000	141,900	0	156,900
2019	15,000	141,900	0	156,900
2020	15,000	142,700	0	157,700
2021	16,500	142,700	0	159,200
2022	18,000	157,000	0	175,000
2023	19,800	174,100	0	193,900
2024	22,200	195,600	0	217,800
2025	30,000	273,200	0	303,200

Land Data						
Front Foot	Type	Effective		Influence		Influence Codes
		Frontage	Depth	Factor	Code	
11.Ossipee WF				%		1.Unimproved
12.Arrowhead WF				%		2.Excess Ftg /De
13.Waterfront				%		3.Topography
14.Rear Land				%		4.Size/Shape
15.Misc				%		5.Access or Rear
				%		6.Restriction
				%		7.Open Space
				%		8.View/Environ
Square Foot	Square Feet					9.Fract Share
16.Regular Lot	16	1	100	%	0	Acres
17.Secondary Lot				%		30.Rear (201+)
18.Excess Land				%		31.Tillable/Horti
19.Condominium				%		32.Pasture
20.Pavement				%		33.Orchard
				%		34.Frontage
				%		35.Triangular Lot
				%		36.Commercial
				%		37.Softwood
				%		38.Mixed Wood
				%		39.Hardwood
				%		40.Wasteland
				%		41.Gravel Pit (Ac
				%		42.Mobile Home Si
				%		43.Condo Site
				%		44.Utility ROW
				%		45.Camp Lot
				%		46.Site Improve
<b>Total Acreage</b>		0.00				

## Waterboro

Map Lot 045-001-684

Account 3465

Location 8 CRYSTAL LANE

Card 1 Of 1 9/23/2024

Building Style	<b>1 Conventional</b>			SF Bsmt Living	<b>0</b>			Layout	<b>1 Typical</b>		
1.Conv	5.Garr/Col	9.Other		Fin Bsmt Grade	<b>0 0</b>			1.Typical	4.	7.	
2.Ranch	6.Split	10.Mohome		OPEN 5 OPTIONAL <b>0</b>			2.Inadeq	5.	8.		
3.R Ranch	7.Contemp/	11.Condo		Heat Type	<b>100% 1 Hot Water BB</b>			3.Not func	6.	9.	
4.Cape	8.Log	12.		1.HWBB	5.FWA	9.No Heat	Attic	<b>0</b>			
Dwelling Units <b>1</b>				2.HWCI	6.GravWA	10.	1.1/4 Fin	4.Full Fin	7.1/4 Unfi		
Other Units <b>0</b>				3.HWRAD	7.Electric	11.	2.1/2 Fin	5.FI/Stair	8.		
Stories <b>2 Two Story</b>				4.Steam	8.FI/WallM	12.	3.3/4 Fin	6.1/2 Unfi	9.None		
1.1	4.1.50	7.1.25		Cool Type	<b>0% 9 None</b>			Insulation	<b>1 Full</b>		
2.2	5.1.75	8.		1.Refrig	4.W&C Air	7.	1.Full	4.Minimal	7.		
3.3	6.2.50	9.		2.Evapor	5.	8.	2.Heavy	5.Unk	8.		
Exterior Walls <b>8 Aluminum/Vinyl</b>				3.H Pump	6.	9.None	3.Capped	6.	9.None		
0.Wood	4.Asb/Asph	8.Alum/Vin		Kitchen Style	<b>2 Typical</b>			Unfinished %	<b>0%</b>		
1.Wood	5.T-111	9.Other		1.Modern	4.Obsolete	7.	Grade & Factor	<b>3 Average 100%</b>			
2.Wd Sh	6.Br/St	11.		2.Typical	5.	8.	1.E Grade	4.B Grade	7.AAA Grad		
3.Compos.	7.Nov	12.		3.Old Type	6.	9.None	2.D Grade	5.A Grade	8.		
Roof Surface <b>1 Asphalt Shingles</b>				Bath(s) Style	<b>2 Typical Bath(s)</b>			3.C Grade	6.AA Grade	9.Same	
1.Asphalt	4.Composit	7.		1.Modern	4.Obsolete	7.	SQFT (Footprint) <b>728</b>				
2.Slate	5.Wood	8.		2.Typical	5.	8.	Condition <b>7 Very Good</b>				
3.Metal	6.Other	9.		3.Old Type	6.	9.None	1.Poor	4.Avg	7.V G		
SF Masonry Trim <b>0</b>				# Rooms	<b>5</b>			2.Fair	5.Avg+	8.Exc	
OPEN-3- <b>0</b>				# Bedrooms	<b>3</b>			3.Avg-	6.Good	9.Same	
OPEN-4- <b>0</b>				# Full Baths	<b>1</b>			Phys. % Good	<b>0%</b>		
Year Built <b>2006</b>				# Half Baths	<b>1</b>			Funct. % Good	<b>100%</b>		
Year Remodeled <b>0</b>				# Addn Fixtures	<b>0</b>			Functional Code	<b>9 None</b>		
Foundation <b>1 Concrete</b>				# Fireplaces	<b>0</b>			1.Incomp	4.Small	7.Layout	
1.Concrete	4.Wood	7.		<div style="display: flex; align-items: center; justify-content: center;"> <div style="background-color: #008080; color: white; padding: 10px 20px; font-size: 2em; margin-right: 10px;">T</div> <div style="font-size: 2em; font-weight: bold; margin-right: 10px;">TRIO</div> </div>							
2.C Block	5.Slab	8.									
3.Br/Stone	6.Prs/Post	9.									
Basement <b>4 Full Basement</b>											
1.1/4 Bmt	4.Full Bmt	7.									
2.1/2 Bmt	5.None	8.									
3.3/4 Bmt	6.	9.None									
Bsmt Gar # Cars <b>0</b>											
Wet Basement <b>1 Dry Basement</b>											
1.Dry	4.	7.									
2.Damp	5.	8.									
3.Wet	6.	9.									

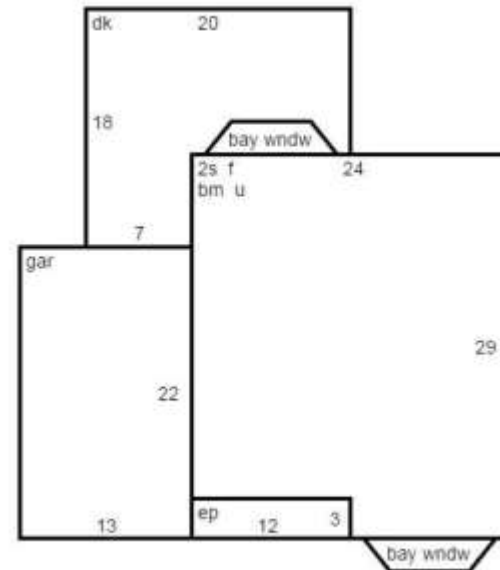

Date Inspected

### Additions, Outbuildings & Improvements

Type	Year	Units	Grade	Cond	Phys.	Funct.	Sound Value	
21 Open Frame	0	52	0 0	0	0	0 %	0 %	1.One Story Fram
23 Frame Garage	0	252	0 0	0	0	0 %	0 %	2.Two Story Fram
68 Wood Deck	2014	210	0 0	0	0	0 %	0 %	3.Three Story Fr
						%	%	4.1 & 1/2 Story
						%	%	5.1 & 3/4 Story
						%	%	6.2 & 1/2 Story
						%	%	21.Open Frame Por
						%	%	22.Encl Frame Por
						%	%	23.Frame Garage
						%	%	24.Frame Shed
						%	%	25.Frame Bay Wind
						%	%	26.1SFr Overhang
						%	%	27.Unfin Basement
						%	%	28.Unfinished Att
						%	%	29.Finished Attic