

ROBBINS, LAFOREST G  
 ROBBINS, CAROLE L  
 209 SOKOKIS TRAIL  
 EAST WATERBORO ME 04030

B2057P570 B15027P929 B19217P706

Previous Owner  
 GAGNE DIANNE M  
 GAGNE, DAVID W  
 PO BOX 352  
 MILO ME 04463  
 Sale Date: 4/03/2023

Previous Owner  
 MAYO LILLIAN R  
 209 SOKOKIS TRIAL  
 EAST WATERBORO ME 04030  
 Sale Date: 12/06/2006

Previous Owner  
 MAYO DONALD G\*  
 MAYO LILLIAN R  
 209 SOKOKIS TRIAL  
 EAST WATERBORO ME 04030  
 Sale Date: 6/29/2006

Inspection Witnessed By:

X	Date
No./Date	Description
	Date Insp.

Notes:

Property Data		
Neighborhood	55 SOKOKIS TRAIL * GP ZONE	
Tree Growth Year	0	
1ST MORTGAGE	0	
2ND MORTGAGE	0	
Zone/Land Use	11 Residential	
Secondary Zone		
Topography	1 Level	
1.Level	4.Below St	7.Steep
2.Rolling	5.Low	8.Wet
3.Above St	6.Swampy	9.Lev/Roll
Utilities	9 No Water/No Sewer	
1.Public	4.Improve	7.Improve
2.Water	5.Improve	8.
3.Sewer	6.Improve	9.None
Street	1 Paved	
1.Paved	4.Proposed	7.ROW
2.Semi Imp	5.Pvt	8.None
3.Gravel	6.Aband	9.TG PLAN
LAND USE	0	
BUILDING USE	0	
Sale Data		
Sale Date	4/03/2023	
Price	259,900	
Sale Type	2 Land & Buildings	
1.Land	4.Mobile	7.
2.L & B	5.Other	8.
3.Building	6.	9.
Financing	9 Unknown	
1.Convent	4.Seller	7.
2.FHA/VA	5.Private	8.
3.Assumed	6.Cash	9.Unknown
Validity	1 Arms Length Sale	
1.Valid	4.Split	7.Renovate
2.Related	5.Partial	8.Other
3.Distress	6.Exempt	9.
Verified	5 Public Record	
1.Buyer	4.Agent	7.Family
2.Seller	5.Pub Rec	8.Other
3.Lender	6.MLS	9.

Assessment Record				
Year	Land	Buildings	Exempt	Total
2012	101,000	81,700	16,000	166,700
2013	101,000	81,700	16,000	166,700
2014	101,000	81,700	16,000	166,700
2015	101,000	81,700	16,000	166,700
2016	56,300	81,700	15,000	123,000
2017	56,300	81,700	15,000	123,000
2018	56,300	81,700	20,000	118,000
2019	56,300	81,700	20,000	118,000
2020	56,300	81,700	20,000	118,000
2021	61,900	81,700	24,500	119,100
2022	67,600	89,800	25,000	132,400
2023	74,300	99,600	25,000	148,900
2024	83,300	113,400	25,000	171,700
2025	101,000	143,600	0	244,600

Land Data						
Front Foot	Type	Effective		Influence		Influence Codes
		Frontage	Depth	Factor	Code	
11.Ossipee WF				%		1.Unimproved
12.Arrowhead WF				%		2.Excess Ftg /De
13.Waterfront				%		3.Topography
14.Rear Land				%		4.Size/Shape
15.Misc				%		5.Access or Rear
				%		6.Restriction
				%		7.Open Space
				%		8.View/Environ
				%		9.Fract Share
				%		Acres
				%		30.Rear (201+)
				%		31.Tillable/Horti
				%		32.Pasture
				%		33.Orchard
				%		34.Frontage
				%		35.Triangular Lot
				%		36.Commercial
21		1.00		100 %	0	37.Softwood
26		1.00		100 %	0	38.Mixed Wood
				%		39.Hardwood
				%		40.Wasteland
				%		41.Gravel Pit (Ac
				%		42.Mobile Home Si
				%		43.Condo Site
				%		44.Utility ROW
				%		45.Camp Lot
				%		46.Site Improve
<b>Total Acreage</b>		2.00				

## Waterboro

Map Lot 008-011A

Account 882

Location 209 SOKOKIS TRAIL

Card 1 Of 1 9/23/2024

Building Style <b>0</b>	SF Bsmt Living <b>0</b>	Layout <b>0</b>
1.Conv 5.Garr/Col 9.Other	Fin Bsmt Grade <b>0 0</b>	1.Typical 4. 7.
2.Ranch 6.Split 10.Mohome	OPEN 5 OPTIONAL <b>0</b>	2.Inadeq 5. 8.
3.R Ranch 7.Contemp/ 11.Condo	Heat Type <b>100% 0</b>	3.Not func 6. 9.
4.Cape 8.Log 12.	1.HWBB 5.FWA 9.No Heat	Attic <b>0</b>
Dwelling Units <b>0</b>	2.HWCI 6.GravWA 10.	1.1/4 Fin 4.Full Fin 7.1/4 Unfi
Other Units <b>0</b>	3.HWRAD 7.Electric 11.	2.1/2 Fin 5.FI/Stair 8.
Stories <b>0</b>	4.Steam 8.FI/WallM 12.	3.3/4 Fin 6.1/2 Unfi 9.None
1.1 4.1.50 7.1.25	Cool Type <b>0% 9 None</b>	Insulation <b>0</b>
2.2 5.1.75 8.	1.Refrig 4.W&C Air 7.	1.Full 4.Minimal 7.
3.3 6.2.50 9.	2.Evapor 5. 8.	2.Heavy 5.Unk 8.
Exterior Walls <b>0 Wood Siding</b>	3.H Pump 6. 9.None	3.Capped 6. 9.None
0.Wood 4.Asb/Asph 8.Alum/Vin	Kitchen Style <b>0</b>	Unfinished % <b>0%</b>
1.Wood 5.T-111 9.Other	1.Modern 4.Obsolete 7.	Grade & Factor <b>0 0%</b>
2.Wd Sh 6.Br/St 11.	2.Typical 5. 8.	1.E Grade 4.B Grade 7.AAA Grad
3.Compos. 7.Nov 12.	3.Old Type 6. 9.None	2.D Grade 5.A Grade 8.
Roof Surface <b>0</b>	Bath(s) Style <b>0</b>	3.C Grade 6.AA Grade 9.Same
1.Asphalt 4.Composit 7.	1.Modern 4.Obsolete 7.	SQFT (Footprint) <b>0</b>
2.Slate 5.Wood 8.	2.Typical 5. 8.	Condition <b>0</b>
3.Metal 6.Other 9.	3.Old Type 6. 9.None	1.Poor 4.Avg 7.V G
SF Masonry Trim <b>0</b>	# Rooms <b>0</b>	2.Fair 5.Avg+ 8.Exc
OPEN-3- <b>0</b>	# Bedrooms <b>0</b>	3.Avg- 6.Good 9.Same
OPEN-4- <b>0</b>	# Full Baths <b>0</b>	Phys. % Good <b>0%</b>
Year Built <b>0</b>	# Half Baths <b>0</b>	Funct. % Good <b>100%</b>
Year Remodeled <b>0</b>	# Addn Fixtures <b>0</b>	Functional Code <b>9 None</b>
Foundation <b>0</b>	# Fireplaces <b>0</b>	1.Incomp 4.Small 7.Layout
1.Concrete 4.Wood 7.		2.O-Built 5.CDU 8.Other
2.C Block 5.Slab 8.		3.Damage 6.Style 9.None
3.Br/Stone 6.Prs/Post 9.		Econ. % Good <b>100%</b>
Basement <b>0</b>		Economic Code <b>None</b>
1.1/4 Bmt 4.Full Bmt 7.		0.None 3.Services 7.
2.1/2 Bmt 5.None 8.		1.Location 4.Traffic 8.
3.3/4 Bmt 6. 9.None		2.Encroach 9.None 9.
Bsmt Gar # Cars <b>0</b>		Entrance Code <b>0</b>
Wet Basement <b>0</b>		1.Interior 4.Vacant 7.
1.Dry 4. 7.		2.Refusal 5.Estimate 8.
2.Damp 5. 8.	3.Informed 6.Office 9.RS	
3.Wet 6. 9.	Information Code <b>0</b>	
	1.Owner 4.Agent 7.	
	2.Relative 5.Estimate 8.	
	3.Tenant 6.Other 9.SNY	

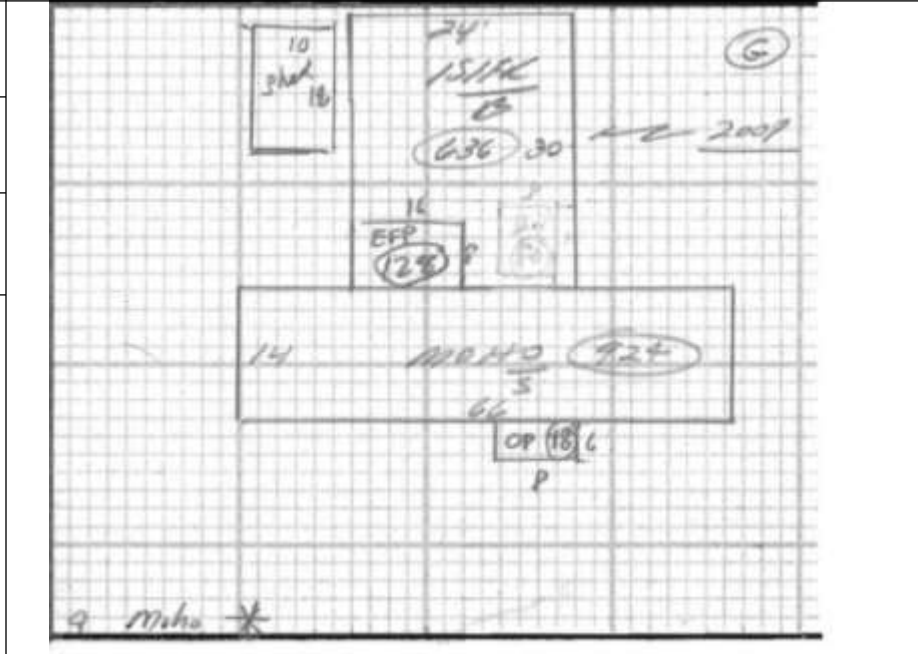

Date Inspected

### Additions, Outbuildings & Improvements

Type	Year	Units	Grade	Cond	Phys.	Funct.	Sound Value
998 14Mobile Home	1987	14x66	3 100	5	85 %	100 %	1.One Story Fram
103 MH CONC. SLAB	1987	924	0 0	0	0 %	0 %	2.Two Story Fram
22 Encl Frame Porch	0	128	0 0	0	0 %	0 %	3.Three Story Fr
21 Open Frame	0	48	0 0	0	0 %	0 %	4.1 & 1/2 Story
24 Frame Shed	0	80	0 0	0	0 %	0 %	5.1 & 3/4 Story
24 Frame Shed	0	180	0 0	0	0 %	0 %	6.2 & 1/2 Story
1 One Story Frame	2007	636	3 90	7	95 %	100 %	21.Open Frame Por
111 CONC. SLAB	2007	720	3 90	7	95 %	100 %	22.Encl Frame Por
21 Open Frame	2007	84	3 90	7	95 %	100 %	23.Frame Garage
23 Frame Garage	2007	576	3 100	7	95 %	100 %	24.Frame Shed
							25.Frame Bay Wind
							26.1SFr Overhang
							27.Unfin Basement
							28.Unfinished Att
							29.Finished Attic