

MCEANEANEY THOMAS AND GINA PARADIS-
70 ASHLEY WAY
WATERBORO ME 04087

B14189P630

Inspection Witnessed By:

X		Date
No./Date	Description	Date Insp.

Notes:
06/01/21 SHEET MAILED FOR INTEREST BALANCE

Waterboro

Property Data			Assessment Record						
Neighborhood 70 WEST RD N			Year	Land	Buildings	Exempt	Total		
Tree Growth Year 0			2012	106,800	391,500	0	498,300		
1ST MORTGAGE 0			2013	106,800	391,500	0	498,300		
2ND MORTGAGE 0			2014	106,800	391,500	0	498,300		
Zone/Land Use 33 Forest/Agricultural..			2015	106,800	391,500	0	498,300		
Secondary Zone			2016	94,100	391,500	0	485,600		
Topography 2 Rolling			2017	94,100	391,500	0	485,600		
1.Level 4.Below St 7.Steep			2018	94,100	391,500	0	485,600		
2.Rolling 5.Low 8.Wet			2019	94,100	391,500	0	485,600		
3.Above St 6.Swampy 9.Lev/Roll			2020	94,100	391,500	20,000	465,600		
Utilities 9 No Water/No Sewer			2021	103,500	391,500	24,500	470,500		
1.Public 4.Improve 7.Improve			2022	112,900	430,700	25,000	518,600		
2.Water 5.Improve 8.			2023	124,100	477,700	25,000	576,800		
3.Sewer 6.Improve 9.None			2024	139,200	536,400	25,000	650,600		
Street 3 Gravel			2025	197,800	666,000	25,000	838,800		
1.Paved 4.Proposed 7.ROW			Land Data						
2.Semi Imp 5.Pvt 8.None									
3.Gravel 6.Aband 9.TG PLAN			Front Foot	Type	Effective		Influence		Influence Codes
LAND USE 0			11.Ossipee WF		Frontage	Depth	Factor	Code	
BUILDING USE 0			12.Arrowhead WF				%		1.Unimproved
Sale Data			13.Waterfront				%		2.Excess Ftg /De
Sale Date			14.Rear Land				%		3.Topography
Price			15.Misc				%		4.Size/Shape
Sale Type							%		5.Access or Rear
1.Land 4.Mobile 7.			Square Foot	Square Feet			%		6.Restriction
2.L & B 5.Other 8.			16.Regular Lot				%		7.Open Space
3.Building 6. 9.			17.Secondary Lot				%		8.View/Environ
Financing			18.Excess Land				%		9.Fract Share
1.Convent 4.Seller 7.			19.Condominium				%		Acres
2.FHA/VA 5.Private 8.			20.Pavement				%		30.Rear (201+)
3.Assumed 6.Cash 9.Unknown							%		31.Tillable/Horti
Validity			Fract. Acre	Acreege/Sites			%		32.Pasture
1.Valid 4.Split 7.Renovate			21.Homesite (Frac	21	5.00	100	%	0	33.Orchard
2.Related 5.Partial 8.Other			22.Vacant Lot (Fr	24	10.00	100	%	0	34.Frontage
3.Distress 6.Exempt 9.			23.Non Conforming	25	10.00	100	%	0	35.Triangular Lot
Verified			Acres	26	23.20	100	%	0	36.Commercial
1.Buyer 4.Agent 7.Family			24.Excess (5-10)				%		37.Softwood
2.Seller 5.Pub Rec 8.Other			25.Excess (10+)				%		38.Mixed Wood
3.Lender 6.MLS 9.			26.Excess				%		39.Hardwood
			27.Rear (1-100)				%		40.Wasteland
			28.Rear (101-150)				%		41.Gravel Pit (Ac
			29.Rear (151-200)				%		42.Mobile Home Si
			Total Acreage		48.20				43.Condo Site
									44.Utility ROW
									45.Camp Lot
									46.Site Improve

Waterboro

Map Lot 006-029-050

Account 588

Location 70 ASHLEY WAY

Card 1 Of 2 9/23/2024

Building Style	1 Conventional	SF Bsmt Living	0	Layout	1 Typical
1.Conv	5.Garr/Col	9.Other	Fin Bsmt Grade	0 0	1.Typical
2.Ranch	6.Split	10.Mohome	OPEN 5 OPTIONAL 0		2.Inadeq
3.R Ranch	7.Contemp/	11.Condo	Heat Type	100%	1 Hot Water BB
4.Cape	8.Log	12.	1.HWBB	5.FWA	9.No Heat
Dwelling Units	2		2.HWCI	6.GravWA	10.
Other Units	0		3.HWRAD	7.Electric	11.
Stories	5 One & 3/4 Story		4.Steam	8.F/WallM	12.
1.1	4.1.50	7.1.25	Cool Type	0%	9 None
2.2	5.1.75	8.	1.Refrig	4.W&C Air	7.
3.3	6.2.50	9.	2.Evapor	5.	8.
Exterior Walls	8 Alumunum/Vinyl		3.H Pump	6.	9.None
0.Wood	4.Asb/Asph	8.Alum/Vin	Kitchen Style	2 Typical	
1.Wood	5.T-111	9.Other	1.Modern	4.Obsolete	7.
2.Wd Sh	6.Br/St	11.	2.Typical	5.	8.
3.Compos.	7.Nov	12.	3.Old Type	6.	9.None
Roof Surface	1 Asphalt Shingles		Bath(s) Style	2 Typical Bath(s)	
1.Asphalt	4.Composit	7.	1.Modern	4.Obsolete	7.
2.Slate	5.Wood	8.	2.Typical	5.	8.
3.Metal	6.Other	9.	3.Old Type	6.	9.None
SF Masonry Trim	0		# Rooms	10	
OPEN-3-	0		# Bedrooms	3	
OPEN-4-	0		# Full Baths	4	
Year Built	2005		# Half Baths	3	
Year Remodeled	0		# Addn Fixtures	0	
Foundation	1 Concrete		# Fireplaces	0	
1.Concrete	4.Wood	7.	<div style="display: flex; align-items: center; justify-content: center;"> <div style="background-color: #2c5e6d; color: white; padding: 10px 20px; font-size: 2em; margin-right: 10px;">T</div> <div style="font-size: 2em; font-weight: bold; margin-right: 10px;">TRIO</div> </div>		
2.C Block	5.Slab	8.			
3.Br/Stone	6.Prs/Post	9.			
Basement	4 Full Basement				
1.1/4 Bmt	4.Full Bmt	7.			
2.1/2 Bmt	5.None	8.			
3.3/4 Bmt	6.	9.None			
Bsmt Gar # Cars	0				
Wet Basement	1 Dry Basement				
1.Dry	4.	7.			
2.Damp	5.	8.			
3.Wet	6.	9.			

Date Inspected

Additions, Outbuildings & Improvements

Type	Year	Units	Grade	Cond	Phys.	Funct.	Sound Value
1 One Story Frame	0	224	0 0	0	0	% 0	%
37 Unfin Basement	0	224	0 0	0	0	% 0	%
4 1 & 1/2 Story Fr	0	264	0 0	0	0	% 0	%
37 Unfin Basement	0	264	0 0	0	0	% 0	%
1 One Story Frame	0	448	0 0	0	0	% 0	%
37 Unfin Basement	0	448	0 0	0	0	% 0	%
2 Two Story Frame	0	324	0 0	0	0	% 0	%
37 Unfin Basement	0	324	0 0	0	0	% 0	%
4 1 & 1/2 Story Fr	0	1120	0 0	0	0	% 0	%
37 Unfin Basement	0	1120	0 0	0	0	% 0	%

- 1.One Story Fram
- 2.Two Story Fram
- 3.Three Story Fr
- 4.1 & 1/2 Story
- 5.1 & 3/4 Story
- 6.2 & 1/2 Story
- 21.Open Frame Por
- 22.Encl Frame Por
- 23.Frame Garage
- 24.Frame Shed
- 25.Frame Bay Wind
- 26.1SFr Overhang
- 27.Unfin Basement
- 28.Unfinished Att
- 29.Finished Attic

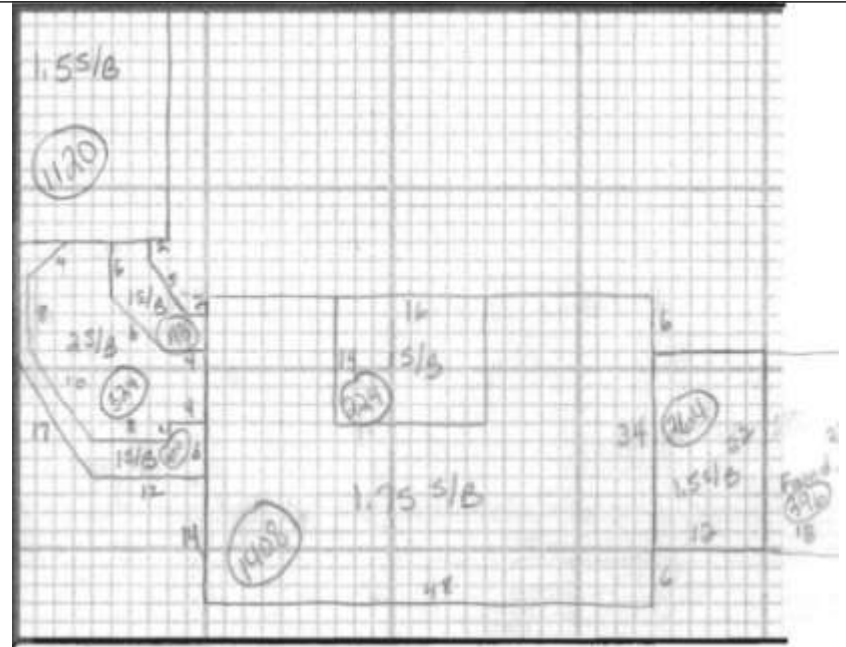

MCEANEANEY THOMAS AND GINA PARADIS-
70 ASHLEY WAY
WATERBORO ME 04087

B14189P630

Inspection Witnessed By:

X		Date
No./Date	Description	Date Insp.

Notes:

Waterboro

Property Data			Assessment Record						
Neighborhood 70 WEST RD N			Year	Land	Buildings	Exempt	Total		
Tree Growth Year 0			2012	0	1,100	0	1,100		
1ST MORTGAGE 0			2013	0	1,100	0	1,100		
2ND MORTGAGE 0			2014	0	1,100	0	1,100		
Zone/Land Use 33 Forest/Agricultural..			2015	0	1,100	0	1,100		
Secondary Zone			2016	0	1,200	0	1,200		
Topography 9 Level & Rolling 9 Level & Rolling			2017	0	1,200	0	1,200		
1.Level 4.Below St 7.Steep			2018	0	1,200	0	1,200		
2.Rolling 5.Low 8.Wet			2019	0	1,200	0	1,200		
3.Above St 6.Swampy 9.Lev/Roll			2020	0	1,200	0	1,200		
Utilities 9 No Water/No Sewer 9 No Water/No Sewer			2021	0	1,200	0	1,200		
1.Public 4.Improve 7.Improve			2022	0	1,300	0	1,300		
2.Water 5.Improve 8.			2023	0	1,500	0	1,500		
3.Sewer 6.Improve 9.None			2024	0	1,700	0	1,700		
Street 9 TG PLAN YEAR			2025	0	3,500	0	3,500		
1.Paved 4.Proposed 7.ROW			Land Data						
2.Semi Imp 5.Pvt 8.None									
3.Gravel 6.Aband 9.TG PLAN			Front Foot	Type	Effective		Influence		Influence Codes
LAND USE 0			11.Ossipee WF		Frontage	Depth	Factor	Code	
BUILDING USE 0			12.Arrowhead WF				%		1.Unimproved
Sale Data			13.Waterfront				%		2.Excess Ftg /De
Sale Date			14.Rear Land				%		3.Topography
Price			15.Misc				%		4.Size/Shape
Sale Type							%		5.Access or Rear
1.Land 4.Mobile 7.			Square Foot	Square Feet			%		6.Restriction
2.L & B 5.Other 8.			16.Regular Lot				%		7.Open Space
3.Building 6. 9.			17.Secondary Lot				%		8.View/Environ
Financing			18.Excess Land				%		9.Fract Share
1.Convent 4.Seller 7.			19.Condominium				%		Acres
2.FHA/VA 5.Private 8.			20.Pavement				%		30.Rear (201+)
3.Assumed 6.Cash 9.Unknown							%		31.Tillable/Horti
Validity			Fract. Acre	Acreege/Sites			%		32.Pasture
1.Valid 4.Split 7.Renovate			21.Homesite (Frac				%		33.Orchard
2.Related 5.Partial 8.Other			22.Vacant Lot (Fr				%		34.Frontage
3.Distress 6.Exempt 9.			23.Non Conforming				%		35.Triangular Lot
Verified			Acres				%		36.Commercial
1.Buyer 4.Agent 7.Family			24.Excess (5-10)				%		37.Softwood
2.Seller 5.Pub Rec 8.Other			25.Excess (10+)				%		38.Mixed Wood
3.Lender 6.MLS 9.			26.Excess				%		39.Hardwood
			27.Rear (1-100)				%		40.Wasteland
			28.Rear (101-150)				%		41.Gravel Pit (Ac
			29.Rear (151-200)				%		42.Mobile Home Si
			Total Acreage		0.00				43.Condo Site
									44.Utility ROW
									45.Camp Lot
									46.Site Improve

Waterboro

Map Lot 006-029-050

Account 588

Location 70 ASHLEY WAY

Card 2

Of 2

9/23/2024

Building Style 0	SF Bsmt Living 0	Layout 0
1.Conv 5.Garr/Col 9.Other	Fin Bsmt Grade 0 0	1.Typical 4. 7.
2.Ranch 6.Split 10.Mohome	OPEN 5 OPTIONAL 0	2.Inadeq 5. 8.
3.R Ranch 7.Contemp/ 11.Condo	Heat Type 100% 0	3.Not func 6. 9.
4.Cape 8.Log 12.	1.HWBB 5.FWA 9.No Heat	Attic 0
Dwelling Units 0	2.HWCI 6.GravWA 10.	1.1/4 Fin 4.Full Fin 7.1/4 Unfi
Other Units 0	3.HWRAD 7.Electric 11.	2.1/2 Fin 5.FI/Stair 8.
Stories 0	4.Steam 8.FI/WallM 12.	3.3/4 Fin 6.1/2 Unfi 9.None
1.1 4.1.50 7.1.25	Cool Type 0% 9 None	Insulation 0
2.2 5.1.75 8.	1.Refrig 4.W&C Air 7.	1.Full 4.Minimal 7.
3.3 6.2.50 9.	2.Evapor 5. 8.	2.Heavy 5.Unk 8.
Exterior Walls 0 Wood Siding	3.H Pump 6. 9.None	3.Capped 6. 9.None
0.Wood 4.Asb/Asph 8.Alum/Vin	Kitchen Style 0	Unfinished % 0%
1.Wood 5.T-111 9.Other	1.Modern 4.Obsolete 7.	Grade & Factor 0 0%
2.Wd Sh 6.Br/St 11.	2.Typical 5. 8.	1.E Grade 4.B Grade 7.AAA Grad
3.Compos. 7.Nov 12.	3.Old Type 6. 9.None	2.D Grade 5.A Grade 8.
Roof Surface 0	Bath(s) Style 0	3.C Grade 6.AA Grade 9.Same
1.Asphalt 4.Composit 7.	1.Modern 4.Obsolete 7.	SQFT (Footprint) 0
2.Slate 5.Wood 8.	2.Typical 5. 8.	Condition 0
3.Metal 6.Other 9.	3.Old Type 6. 9.None	1.Poor 4.Avg 7.V G
SF Masonry Trim 0	# Rooms 0	2.Fair 5.Avg+ 8.Exc
OPEN-3- 0	# Bedrooms 0	3.Avg- 6.Good 9.Same
OPEN-4- 0	# Full Baths 0	Phys. % Good 0%
Year Built 0	# Half Baths 0	Funct. % Good 100%
Year Remodeled 0	# Addn Fixtures 0	Functional Code 9 None
Foundation 0	# Fireplaces 0	1.Incomp 4.Small 7.Layout
1.Concrete 4.Wood 7.		2.O-Built 5.CDU 8.Other
2.C Block 5.Slab 8.		3.Damage 6.Style 9.None
3.Br/Stone 6.Prs/Post 9.		Econ. % Good 100%
Basement 0		Economic Code None
1.1/4 Bmt 4.Full Bmt 7.		0.None 3.Services 7.
2.1/2 Bmt 5.None 8.		1.Location 4.Traffic 8.
3.3/4 Bmt 6. 9.None		2.Encroach 9.None 9.
Bsmt Gar # Cars 0		Entrance Code 0
Wet Basement 0		1.Interior 4.Vacant 7.
1.Dry 4. 7.		2.Refusal 5.Estimate 8.
2.Damp 5. 8.		3.Informed 6.Office 9.RS
3.Wet 6. 9.		Information Code 0
		1.Owner 4.Agent 7.
		2.Relative 5.Estimate 8.
		3.Tenant 6.Other 9.SNY



Date Inspected

Additions, Outbuildings & Improvements

Type	Year	Units	Grade	Cond	Phys.	Funct.	Sound Value	
187 FOUNDATION	0	396	0 0	0	0	0	0	1.One Story Fram
								2.Two Story Fram
								3.Three Story Fr
								4.1 & 1/2 Story
								5.1 & 3/4 Story
								6.2 & 1/2 Story
								21.Open Frame Por
								22.Encl Frame Por
								23.Frame Garage
								24.Frame Shed
								25.Frame Bay Wind
								26.1SFr Overhang
								27.Unfin Basement
								28.Unfinished Att
								29.Finished Attic